

# MAIN/UNIVERSITY OFFICE

1220 MAIN AVE, FARGO, ND 58102

A photograph of a modern office building with a brick facade and large glass windows. A large tree is in the foreground, and a paved walkway with benches is visible. The sky is clear and blue.

OFFICE FOR LEASE

OFFICE SUITE ON THE CORNER OF MAIN/UNIVERSITY

Space Available: 805 SF

Base Rent: \$1,341 per month

Tenant Expenses: Electricity, Phone/Internet, Janitorial

**Nate Vollmuth** | 701.893.3839

nate@goldmark.com

**Goldmark Commercial Real Estate**

www.goldmarkcommercial.com

# MAIN/UNIVERSITY OFFICE

1220 MAIN AVE, FARGO, ND 58102



## SPACE AVAILABLE:

Suite 205 - 805 SF  
(Available May 1, 2024)

## BASE RENT

Suite 205 - \$1,341/month

## TENANT EXPENSES

Electricity  
Phone/Internet  
Janitorial

## PROPERTY DESCRIPTION:

Second floor office space available for lease in the 1220 Professional Building. Located at the busy intersection of Main Ave and University Drive. Perfect for a professional office user with plenty of parking onsite and monument signage available.

Suite 205 features two large private offices, reception area, and workroom.



This information has been secured from sources we believe to be reliable, but we make no representation or warranties, expressed or implied, as to the accuracy of the information. Interested parties should conduct their own independent investigations and rely only on those results.

\*Tenants with businesses related to data mining or crypto currency will not be accepted.

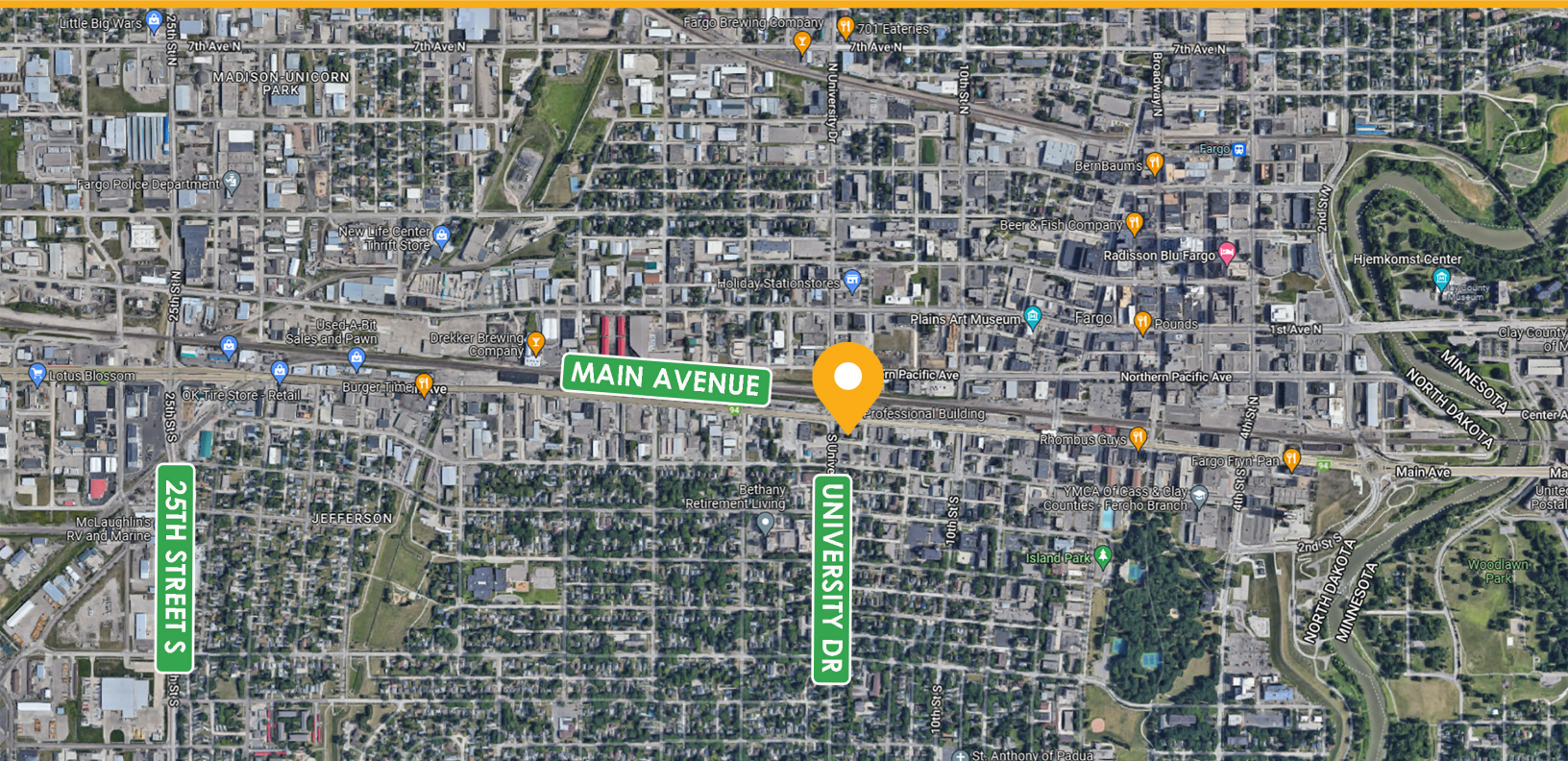

# MAIN/UNIVERSITY OFFICE

1220 MAIN AVE, FARGO, ND 58102



FLOORPLAN

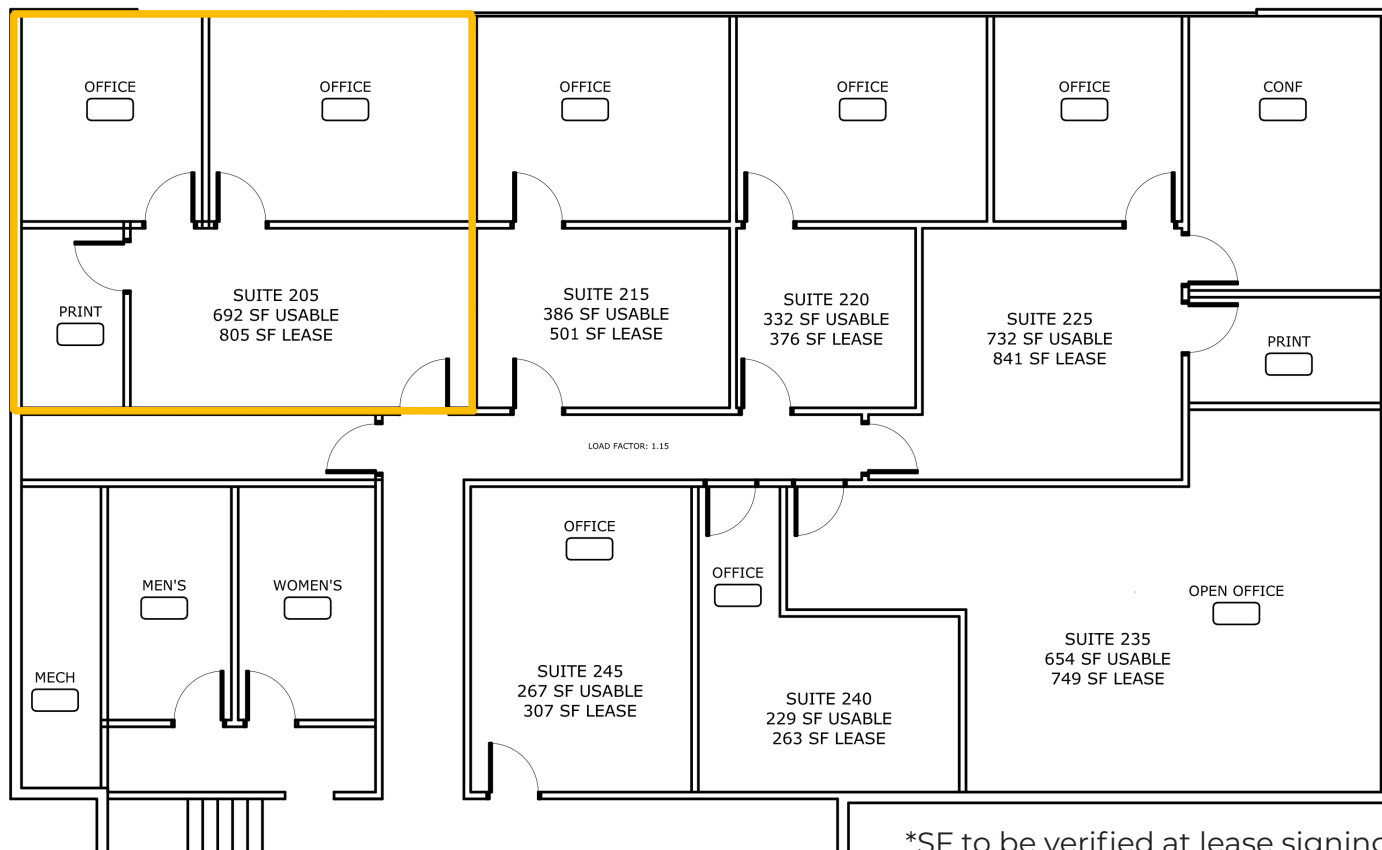

\*SF to be verified at lease signing

