

PRICE

Suite 201
3,000 SF @ \$19.95 PSF

Suite 203
2,500 SF @ \$17.95 PSF

Suite 207
394 SF @ \$650 per month

ZONING

Commercial

3 MONTHS FREE RENT FOR LEASES SIGNED BY YEAR END



PRIME OFFICE & MEDICAL SUITES ALONG ROUTE 309

Position your business in a high-visibility location along the bustling Route 309 corridor, just minutes from the Colmar SEPTA train station. This property offers exceptional accessibility to key areas, including Montgomeryville, Ambler, Fort Washington, Souderton, and Quakertown.

Property Highlights

- Multiple Suite Options- sizes and layouts:
 - Suite 201-203: Available individually or as a combined larger suite
 - Suite 207: Rare small suite for a 1-2 person operation
- Ideal for growing practices or businesses
- Enjoy proximity to Montgomery Mall, with a wide variety of shopping and dining options—perfect for client meetings, employee lunches, or a quick errand between appointments.
- With Montgomery County District Court occupying space on the first floor, this is an ideal spot for a law office or other professional office

PRESENTED BY

James R. Wrigley
215-519-2290 (m) | 215-855-5100 (o)
jimw@kpgcm.com

Keith T. Metzger
267-218-4819 (m) | 215-855-5100 ext 118 (o)
keithm@kpgcm.com

OFFICE SPACE - LEASE

271 Bethlehem Pike, Colmar, PA 18915



PRESENTED BY

James R. Wrigley
215-519-2290 (m)
215-855-5100 (o)
jimw@kpgcm.com

Keith T. Metzger
267-218-4819 (m)
215-855-5100 ext 118 (o)
keithm@kpgcm.com



OFFICE SPACE - LEASE

271 Bethlehem Pike, Colmar, PA 18915

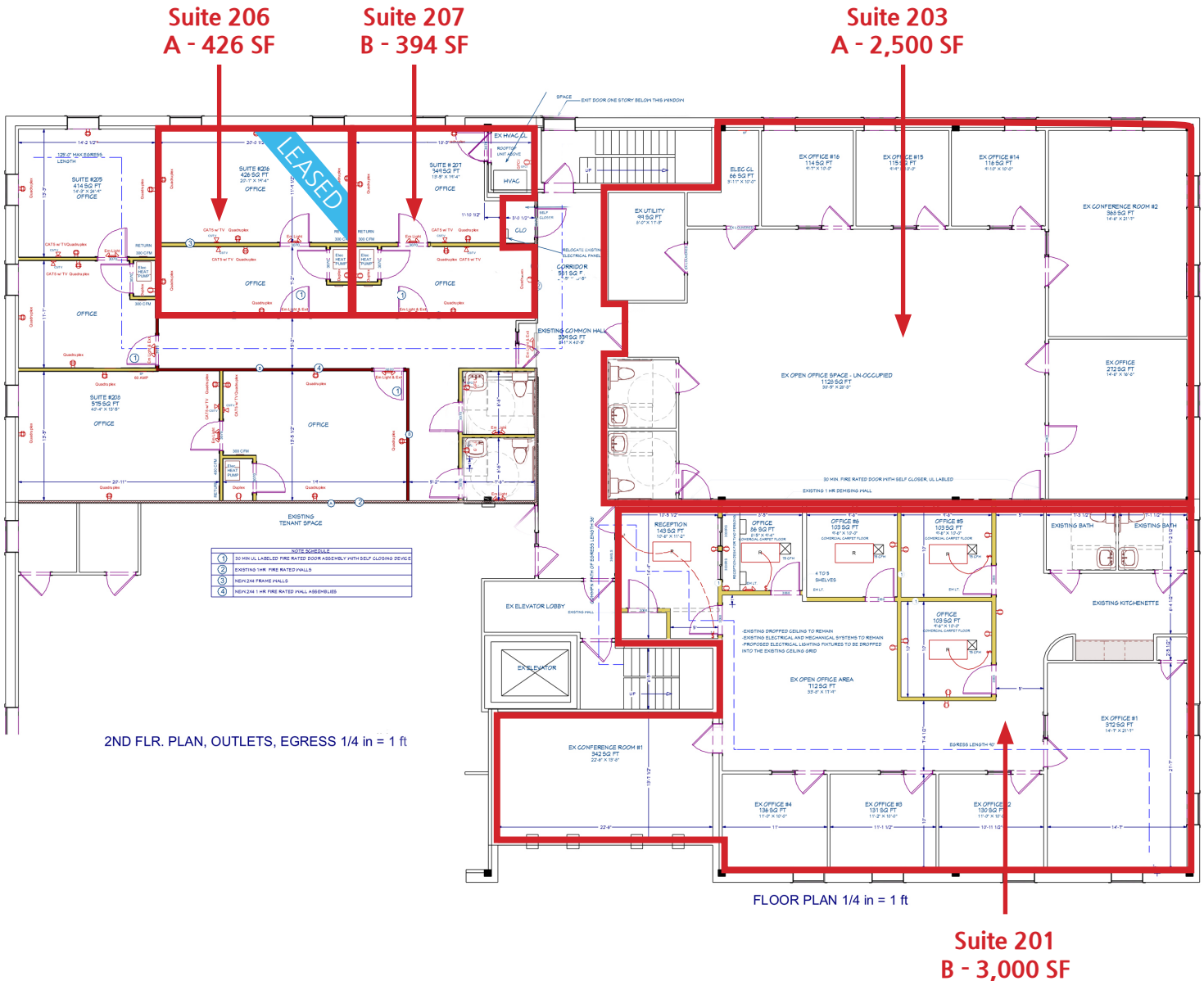

Note: Suites 201 & 203 can be combined into 5,500 SF

PRESENTED BY

James R. Wrigley
215-519-2290 (m)
215-855-5100 (o)
jimw@kpgcm.com

Keith T. Metzger
267-218-4819 (m)
215-855-5100 ext 118 (o)
keithm@kpgcm.com

