

LA PALMA *AT PARK PLACE*

1743 Park Center Drive
Orlando, FL 32835

LA PALMA

AT PARK PLACE
BUILDING OVERVIEW

36,828 SF
RENTABLE BUILDING AREA

2001
YEAR BUILT

CLASS A
OFFICE/MEDICAL

11,835 SF
AVAILABLE

4.07/1,000 SF
PARKING RATIO



LA PALMA

AT PARK PLACE

AVAILABLE SPACES

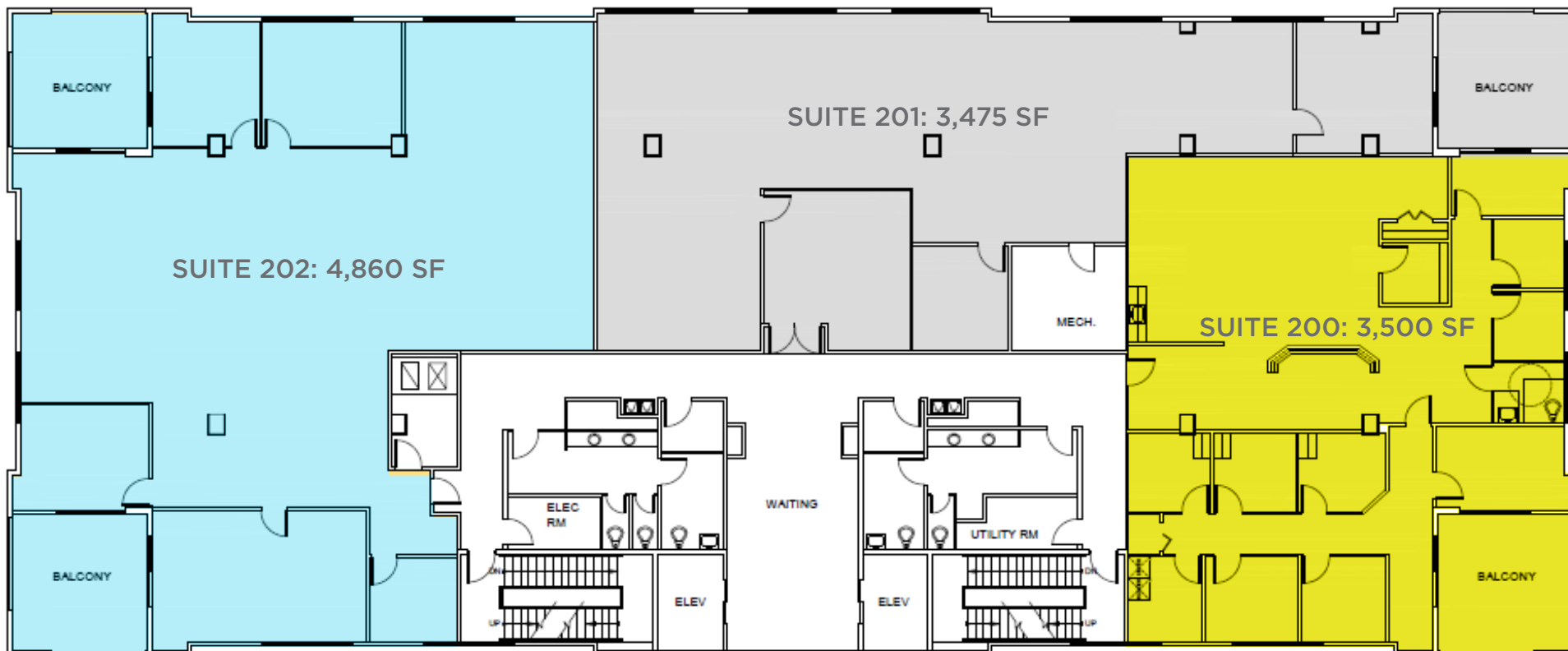

SECOND FLOOR

Full Floor | 3,475 - 11,835 SF | Rate: Negotiable | Available: Immediately



**CUSHMAN &
WAKEFIELD**



KEVIN HAMMOND

Director
+1 407 241 3081
kevin.hammond@cushwake.com

JOHN SKINNER

Senior Associate
+1 407 541 4436
john.skinner@cushwake.com

©2022 Cushman & Wakefield. All rights reserved. The information contained in this communication is strictly confidential. This information has been obtained from sources believed to be reliable but has not been verified. NO WARRANTY OR REPRESENTATION, EXPRESS OR IMPLIED, IS MADE AS TO THE CONDITION OF THE PROPERTY (OR PROPERTIES) REFERENCED HEREIN OR AS TO THE ACCURACY OR COMPLETENESS OF THE INFORMATION CONTAINED HEREIN, AND SAME IS SUBMITTED SUBJECT TO ERRORS, OMISSIONS, CHANGE OF PRICE, RENTAL OR OTHER CONDITIONS, WITHDRAWAL WITHOUT NOTICE, AND TO ANY SPECIAL LISTING CONDITIONS IMPOSED BY THE PROPERTY OWNER(S). ANY PROJECTIONS, OPINIONS OR ESTIMATES ARE SUBJECT TO UNCERTAINTY AND DO NOT SIGNIFY CURRENT OR FUTURE PROPERTY PERFORMANCE.