

**1,791
TO 5,008
SQUARE FEET
AVAILABLE
FOR LEASE**

**INDUSTRIAL / FLEX
UNITS**

**IDEAL LOCATION
JUST OFF ROUTE 130**



**AVAILABLE FOR LEASE
1829 UNDERWOOD BLVD**

MILLSIDE INDUSTRIAL PARK | Delran, NJ

OWNED BY

**Camber
Real Estate
Partners**

**MP MARCUS
PARTNERS**

Scott Mertz, SIOR
+1 856 802 6529
scott.mertz@naimertz.com

NAI Mertz
21 Roland Avenue | Mount Laurel, NJ 08054
+1 856 234 9600 | naimertz.com

NAIMertz
COMMERCIAL REAL ESTATE SERVICES, WORLDWIDE

AVAILABLE FOR LEASE

1829 UNDERWOOD BLVD

MILLSIDE INDUSTRIAL PARK | Delran, NJ

CURRENT AVAILABILITIES

UNIT 2

- 5,008± SF
- Ceiling height: 17'6" - 18'2"
- (1) 10'x10' tailgate door

UNIT 9

- 1,791± SF
- 1,205± SF office / 550± SF warehouse
- Ceiling height: 18' - 18'8"
- (1) 10'x10' tailgate door

BUILDING DESCRIPTION

- 39,941 SF, multi-tenanted, industrial/flex building
- 3.35 acre lot
- Tailgate loading in each unit
- 18'± clear ceiling height
- Power: 208/120v, 200a, 3 Phase
- Wet sprinkler system
- Located in Millside Industrial Park

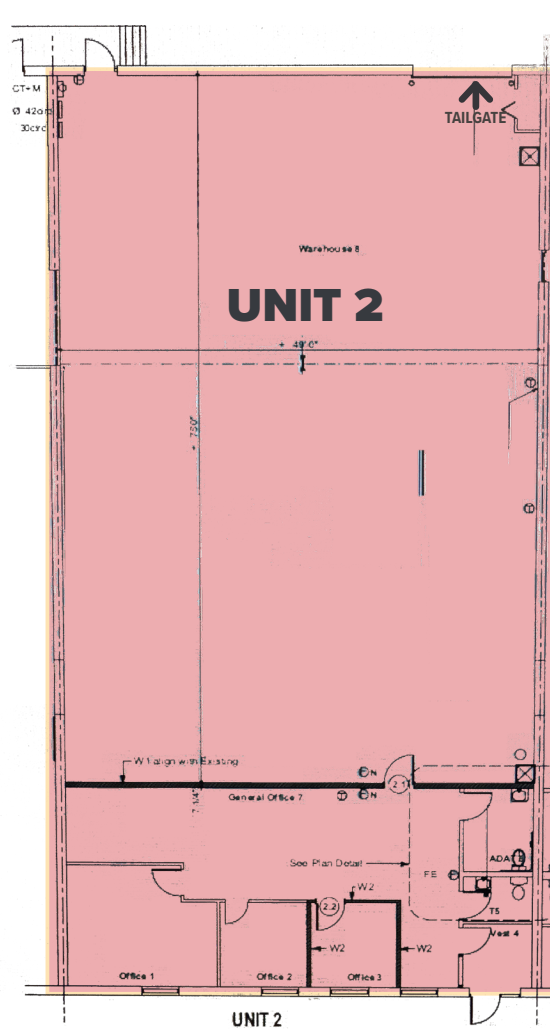

LOCATION INFORMATION



AVAILABLE FOR LEASE 1829 UNDERWOOD BLVD

MILLSIDE INDUSTRIAL PARK | Delran, NJ

Distance to

Route 130	0.3 mi
Route 73	4.5 mi
I-295 (Exit 43)	5.5 mi
Tacony-Palmyra Bridge	6.5 mi
Betsy Ross Bridge	7.5 mi
NJ Turnpike (Exit 4)	10 mi
Center City Philadelphia	13 mi

OWNED BY

Camber
Real Estate
Partners

MP MARCUS
PARTNERS

Scott Mertz, SIOR

+1 856 802 6529

scott.mertz@naimertz.com

NAI Mertz

21 Roland Avenue | Mount Laurel, NJ 08054

+1 856 234 9600 | naimertz.com

NO WARRANTY OR REPRESENTATION, EXPRESS OR IMPLIED, IS MADE AS TO THE ACCURACY OF THE INFORMATION CONTAINED HEREIN, AND THE SAME IS SUBMITTED SUBJECT TO ERRORS, OMISSIONS, CHANGE OF PRICE, RENTAL OR OTHER CONDITIONS, PRIOR SALE, LEASE OR FINANCING, OR WITHDRAWAL WITHOUT NOTICE, AND OF ANY SPECIAL LISTING CONDITIONS IMPOSED BY OUR PRINCIPALS NO WARRANTIES OR REPRESENTATIONS ARE MADE AS TO THE CONDITION OF THE PROPERTY OR ANY HAZARDS CONTAINED THEREIN ARE ANY TO BE IMPLIED.

NAIMertz

COMMERCIAL REAL ESTATE SERVICES, WORLDWIDE