

4428 MALAAI ST

C. S. WO & SONS



Colliers

FOR SALE (LEASESHOLD)

4428 Malaai Street

Honolulu, HI 96818

William Froelich (B), JD, SIOR, CCIM*

Lic# RB-21658

808 523 9711

william.froelich@colliers.com

Colliers

220 S. King Street, Suite 1800
Honolulu, Hawaii 96813
808 524 2666

Property Overview

Opportunity to purchase a leasehold interest in a concrete tilt up building with loading docks and office space in Bougainville. This property is fully leased to U-Haul through 5/14/30. U-Haul has a known rent option to renew for another 5 years. This cash flow investment and potential owner user property's ground lease expires on 6/30/34. (May be possible to extend)

Area	Salt Lake
TMK	(1) 9-9-71-48
Zoning	I-2
Lot Size	25,647 SF
Building Size	Ground Floor Warehouse: 18,099 SF Upper Floor Office: 3,695 SF Total Building Size: 21,794 SF
Asking Price	\$430,000
Tenure	Leaseshold
Ground Lease	Through 6/30/34



Site Plan

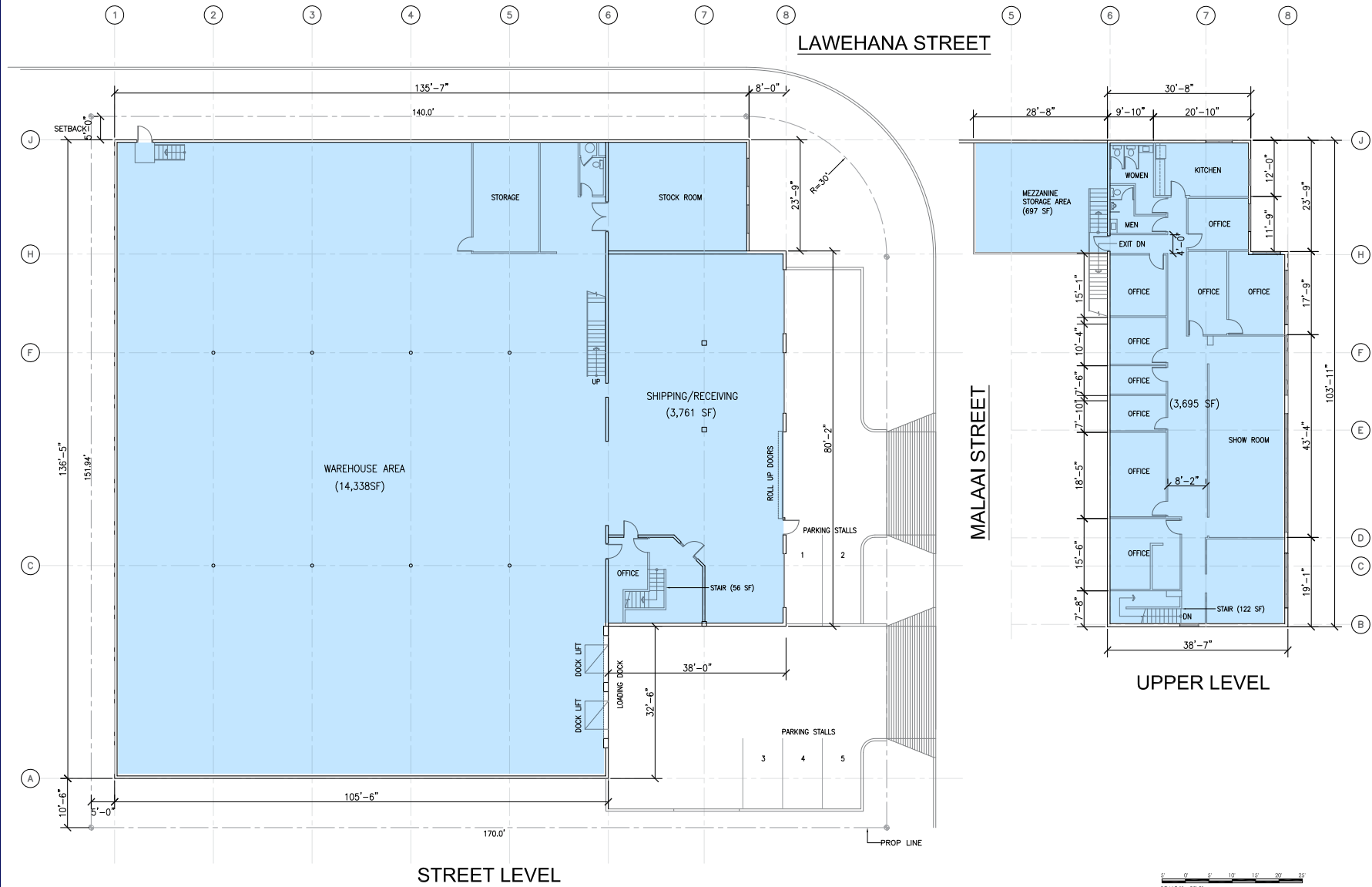

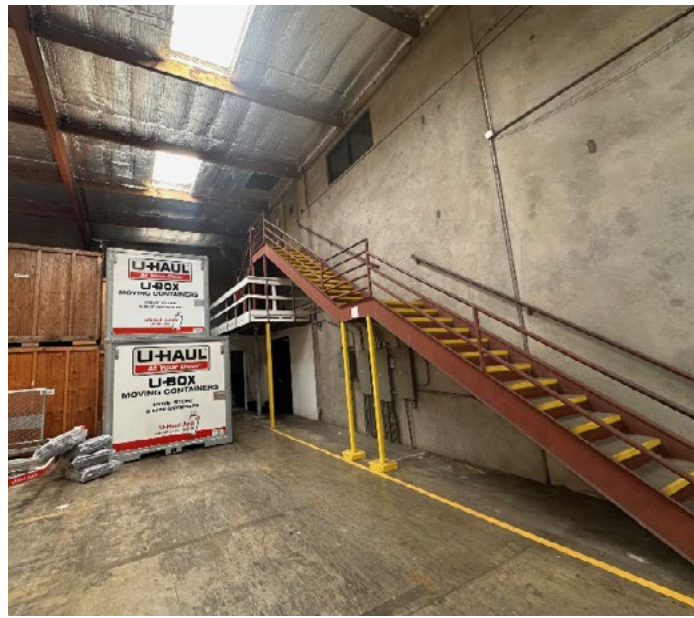

Contact Information:

William Froelich (B), JD, SIOR, CCIM*

Lic# RB-21658

808 523 9711

william.froelich@colliers.com

*FFFM LLC, Exclusively contracted to Colliers International HI, LLC

This document/email has been prepared by Colliers for advertising and general information only. Colliers makes no guarantees, representations or warranties of any kind, expressed or implied, regarding the information including, but not limited to, warranties of content, accuracy and reliability. Any interested party should undertake their own inquiries as to the accuracy of the information. Colliers excludes unequivocally all inferred or implied terms, conditions and warranties arising out of this document and excludes all liability for loss and damages arising there from. This publication is the copyrighted property of Colliers and /or its licensor(s). © 2025. All rights reserved. This communication is not intended to cause or induce breach of an existing listing agreement.

Colliers

Accelerating success.

220 S. King Street, Suite 1800
Honolulu, Hawaii 96813
808 524 2666