

CENTURY TOWERS HIGHLY IMPROVED SUBLEASE

2049
Century Park East
25th Floor - Los Angeles, CA



AVAILABLE

Now

ASKING RENT

\$2,500/Office/Month
\$500/Cubicle/Month

TERM

± Three (3) Years



- Two (2) Private Window Offices
- One (1) Workstation
- Shared Conference Room
- Move - in Ready
- Breathtaking Unobstructed Views
- Ideal for Professionals
- Beautiful Furniture Available

CRAIG MILLER
cmiller@stone-miller.com
(310) 202-9008 x 101
DRE #01006713



JEFF LIPSON
jlipson@stone-miller.com
(310) 202-9008 x 113
DRE #01196852



CRAIG MILLER
cmiller@stone-miller.com
(310) 202-9008 x 101
DRE #01006713



JEFF LIPSON
jlipson@stone-miller.com
(310) 202-9008 x 113
DRE #01196852

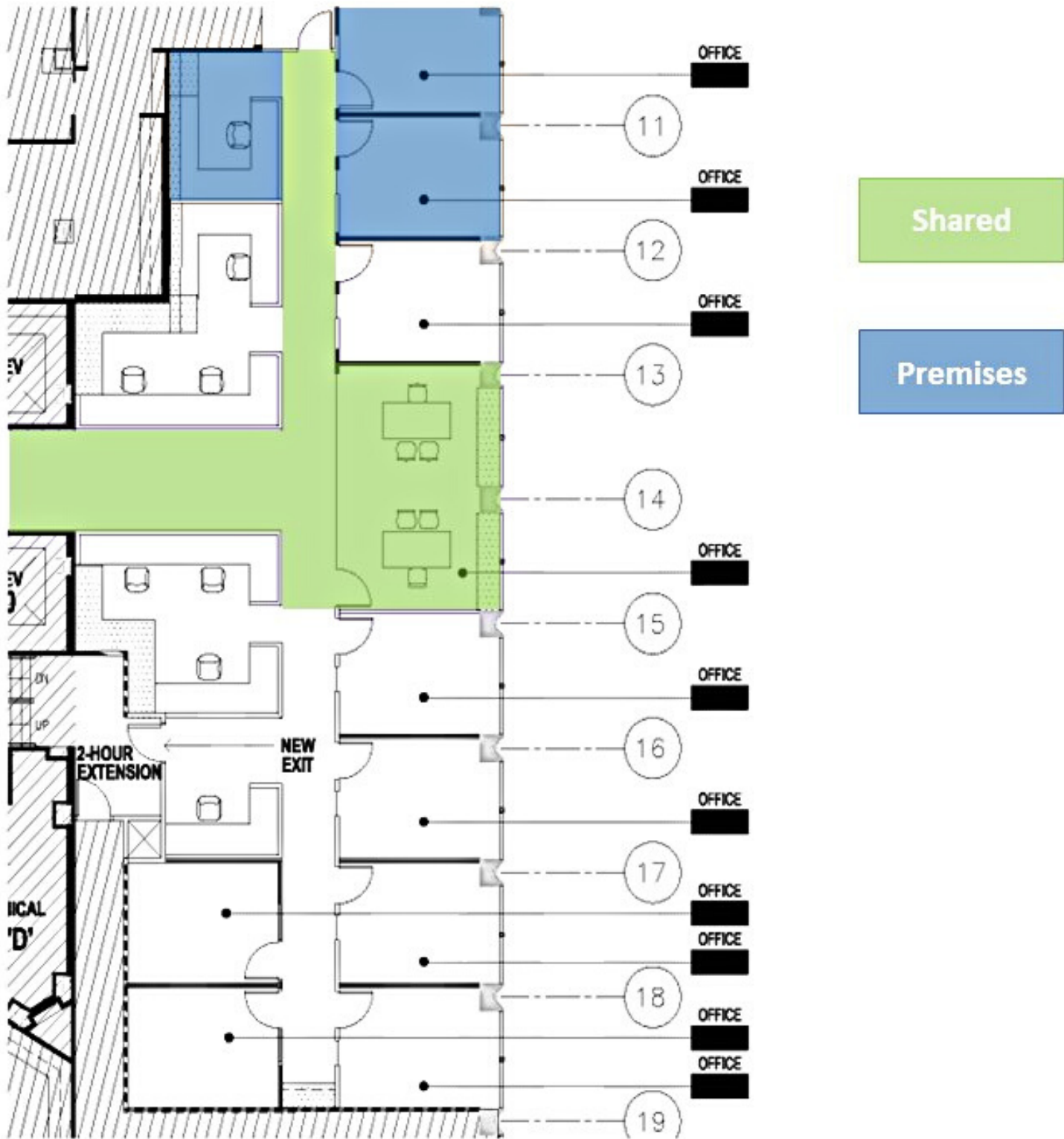

CRAIG MILLER

cmiller@stone-miller.com

(310) 202-9008 x 101

DRE #01006713



JEFF LIPSON

jlipson@stone-miller.com

(310) 202-9008 x 113

DRE #01196852