

2022 WASHTENAW AVENUE YPSILANTI, MICHIGAN

LAND FOR GROUND LEASE
1.30 Acres Available



**SIGNATURE
ASSOCIATES**
KNOW SIGNATURE | KNOW RESULTS



PROPERTY FEATURES

- 1.30 acres available
- General Commercial
- Prominent redevelopment site
- Offers frontage on both Whittier and Washtenaw, situated in a highly desirable area of Ypsilanti
- High traffic volumes and close-proximity to Eastern Michigan University, Washtenaw Community College, and St. Joseph Mercy Hospital
- This location is ideal for fast food, mixed-use, childcare, offices, veterinary clinics, medical offices, and a variety of retail uses
- Convenient access to US-23 for a wide range of development options

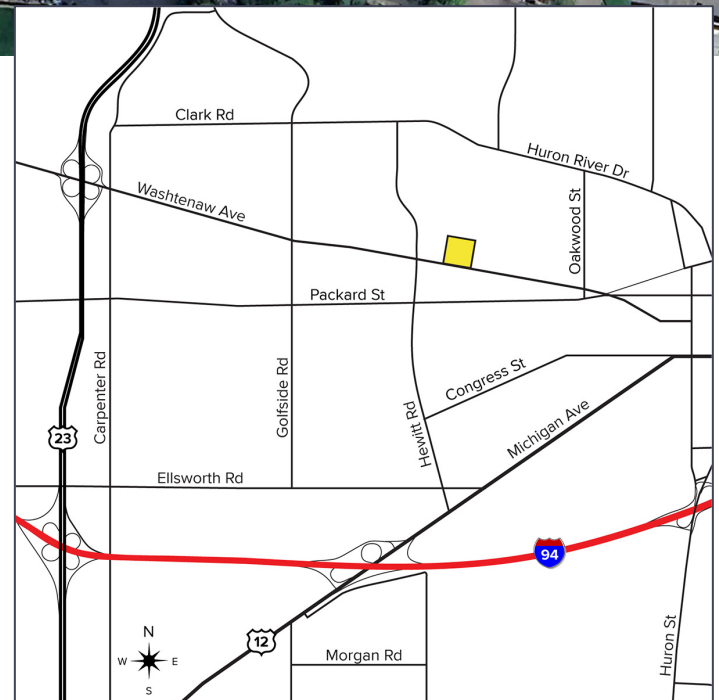

For more information, please contact:

BRUCE D. BAJA

(248) 799 3177

bbaja@signatureassociates.com

ANATOLA SESI

(248) 359 0629

asesi@signatureassociates.com

SIGNATURE ASSOCIATES

One Towne Square, Suite 1200

Southfield, MI 48076

www.signatureassociates.com

2022 Washtenaw Avenue – Ypsilanti, Michigan

Land For Ground Lease

1.30
Acres
AVAILABLE

DEMOGRAPHICS		
	POPULATION	MED. HH INCOME
1 MILE	13,072	\$58,887
3 MILE	63,088	\$60,904
5 MILE	150,973	\$71,862

TRAFFIC COUNTS (TWO-WAY)	
27,954	Washtenaw Ave. E of Hewitt Rd.
28,513	Washtenaw Ave. W of Hewitt Rd.
13,870	Hewitt Rd. N of Washtenaw Rd.
14,263	Hewitt Rd. S of Washtenaw Rd.

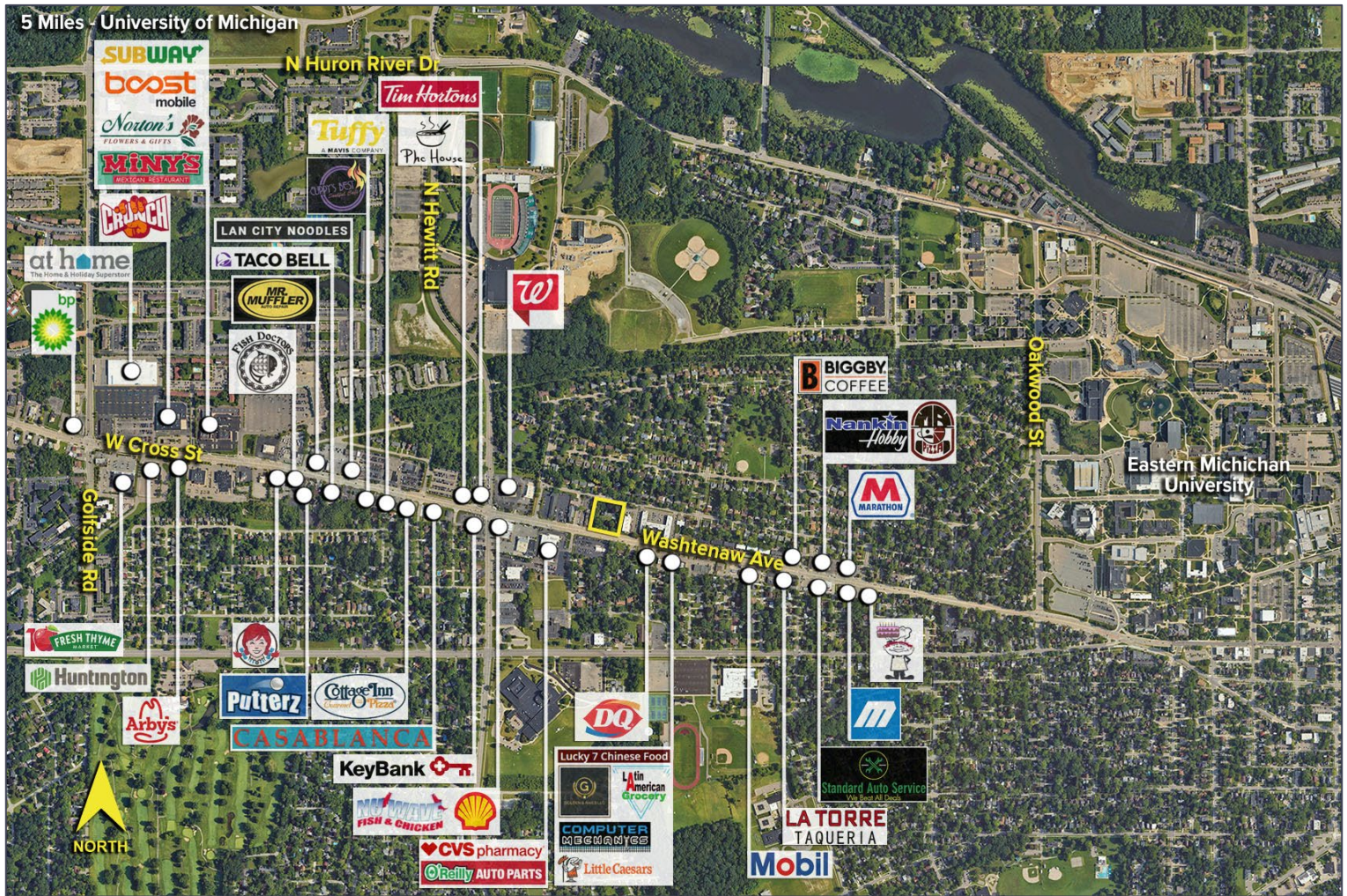

For more information, please contact:

BRUCE D. BAJA
(248) 799 3177
bbaja@signatureassociates.com

ANATOLA SESI
(248) 359 0629
asesi@signatureassociates.com

SIGNATURE ASSOCIATES
One Towne Square, Suite 1200
Southfield, MI 48076
www.signatureassociates.com