

# 5548 Chestnut Street

Philadelphia, PA 19139

## For Lease

\$22/SF NNN



### Property Highlights

- 2834 SF and 931 SF available on the 2nd floor
- ADA accessibility
- Elevator-serviced building
- Well-capitalized ownership

### Location Highlights

- Amenity-rich location
- Located at a signalized intersection with  $\pm 15,000$  vehicles per day
- Serviced by SEPTA bus routes 21 & G
- 2 blocks from Market Frankford Line station at 56th & Market



For more information:

**Karl Schwemlein**  
karls@geisrealty.com  
215 253 5530

**Dana Wilber**  
dwilber@geisrealty.com  
215 701 3266

Duane Morris Plaza // 30 South 17th Street, Suite 210 // Philadelphia, PA 19103 // Phone: 215 568 7222 // Fax: 215 568 5043 // geisrealty.com

THE INFORMATION CONTAINED HEREIN HAS BEEN GIVEN TO US BY THE OWNER OF THE PROPERTY OR OTHER SOURCES WE DEEM RELIABLE. WE HAVE NO REASON TO DOUBT ITS ACCURACY, BUT WE DO NOT GUARANTEE IT. ALL INFORMATION SHOULD BE VERIFIED PRIOR TO PURCHASE OR LEASE.

5548 Chestnut Street Philadelphia, PA 19139

# Strategic Location

## Nearby Public Transportation

Short walk to  
train station

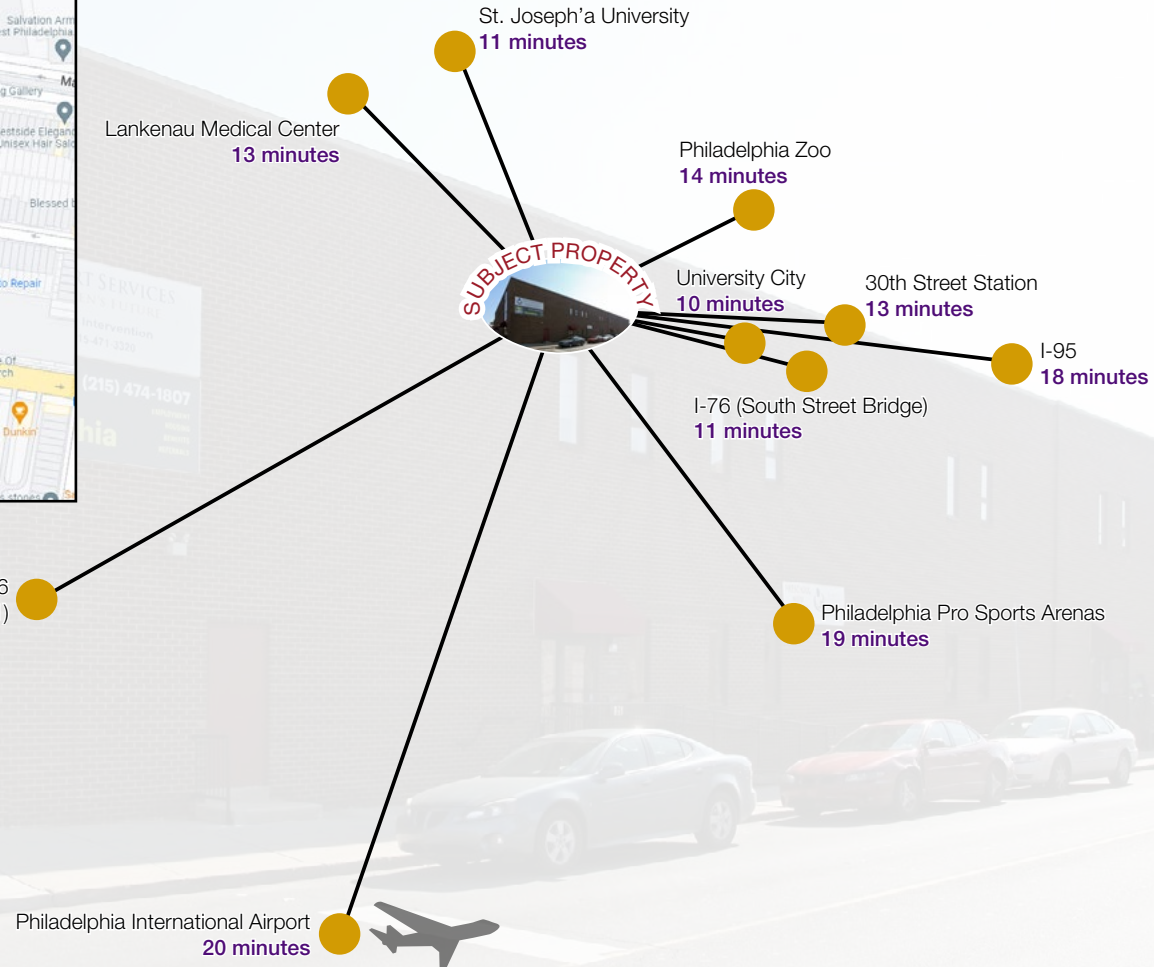
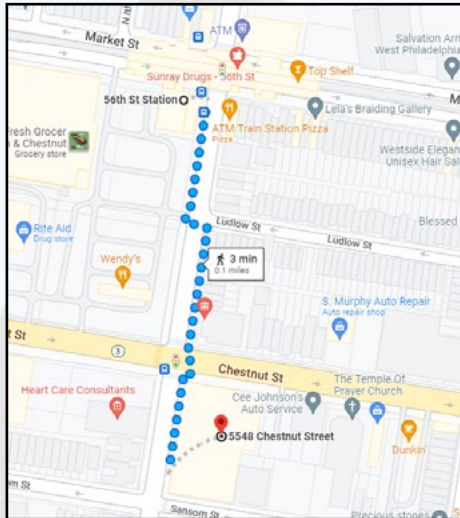

**NAI** Geis Realty  
Group, Inc.

For more information:

**Karl Schwemlein**

karls@geisrealty.com

215 253 5530

**Dana Wilber**

dwilber@geisrealty.com

215 701 3266

Duane Morris Plaza // 30 South 17th Street, Suite 210 // Philadelphia, PA 19103 // Phone: 215 568 7222 // Fax: 215 568 5043 // geisrealty.com

THE INFORMATION CONTAINED HEREIN HAS BEEN GIVEN TO US BY THE OWNER OF THE PROPERTY OR OTHER SOURCES WE DEEM RELIABLE. WE HAVE NO REASON TO DOUBT ITS ACCURACY, BUT WE DO NOT GUARANTEE IT. ALL INFORMATION SHOULD BE VERIFIED PRIOR TO PURCHASE OR LEASE.

5548 Chestnut Street Philadelphia, PA 19139

## Floor Plan - 2nd Floor

909 SF - 17,701 SF available

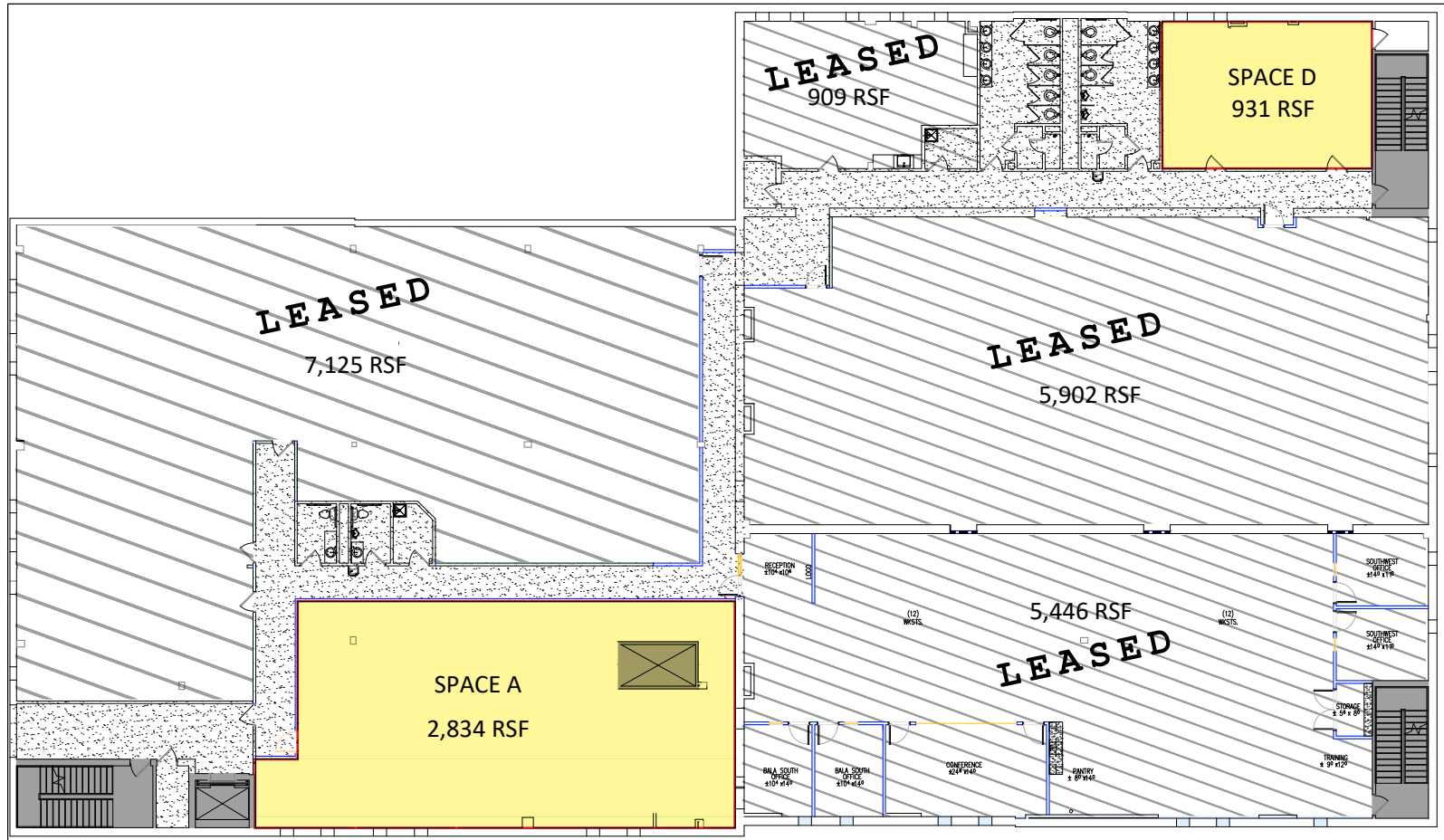

For more information:

**Karl Schwemlein**

karls@geisrealty.com

215 253 5530

**Dana Wilber**

dwilber@geisrealty.com

215 701 3266

Duane Morris Plaza // 30 South 17th Street, Suite 210 // Philadelphia, PA 19103 // Phone: 215 568 7222 // Fax: 215 568 5043 // geisrealty.com

THE INFORMATION CONTAINED HEREIN HAS BEEN GIVEN TO US BY THE OWNER OF THE PROPERTY OR OTHER SOURCES WE DEEM RELIABLE. WE HAVE NO REASON TO DOUBT ITS ACCURACY, BUT WE DO NOT GUARANTEE IT. ALL INFORMATION SHOULD BE VERIFIED PRIOR TO PURCHASE OR LEASE.



**SEPTA Market-Frankford Line:**

- University City
- Hospital of the University of Pennsylvania
- Children's Hospital of Philadelphia
- Philadelphia VA Medical Center
- Frankford Transportation Center  
(see following map for connections)
- Arrott Transportation Center  
(see following map for connections)
- Independence Hall
- 8th & Market with connections to PATCO & NJ Transit
- City Hall with connections to Broad Street Subway Line  
(see following map for connections)
- 30th Street Transportation Center  
(see following map for connections)
- 56th & Market Street
- 69th Street Transportation Center  
(see following map for connections)

**SEPTA bus line 21:**

- Columbus Blvd & Dock St
- Broad Street Subway Line (S. Broad & Walnut)
  - Concourse access to Suburban Station and SEPTA Regional Rail
  - Concourse access to Market Frankford Line
- Walnut/Chestnut Street from S. Broad St. through 63rd Street
- 56th & Chestnut
- 69th Street Transportation Center  
(see following map for connections)

**SEPTA bus line 31:**

- City Hall with connections to Market-Frankford Line & Broad Street Line
- Suburban Station with connections to Regional Rail
- 30th Street Transportation Center  
(see following map for additional connections)
- University City (34th St & Market St)
- Market Street from 46th St through 63rd St
- 76th St & City Ave

**SEPTA bus line G:**

- Lankenau Medical Center
- SEPTA Regional Rail (Overbrook Station & Angora Station)
- Market Frankford Line (56th & Market)
- 56th & Chestnut Sts
- Broad Street Subway Line (Oregon Station)
- Columbus Blvd & Snyder Ave

# Market Frankford Line

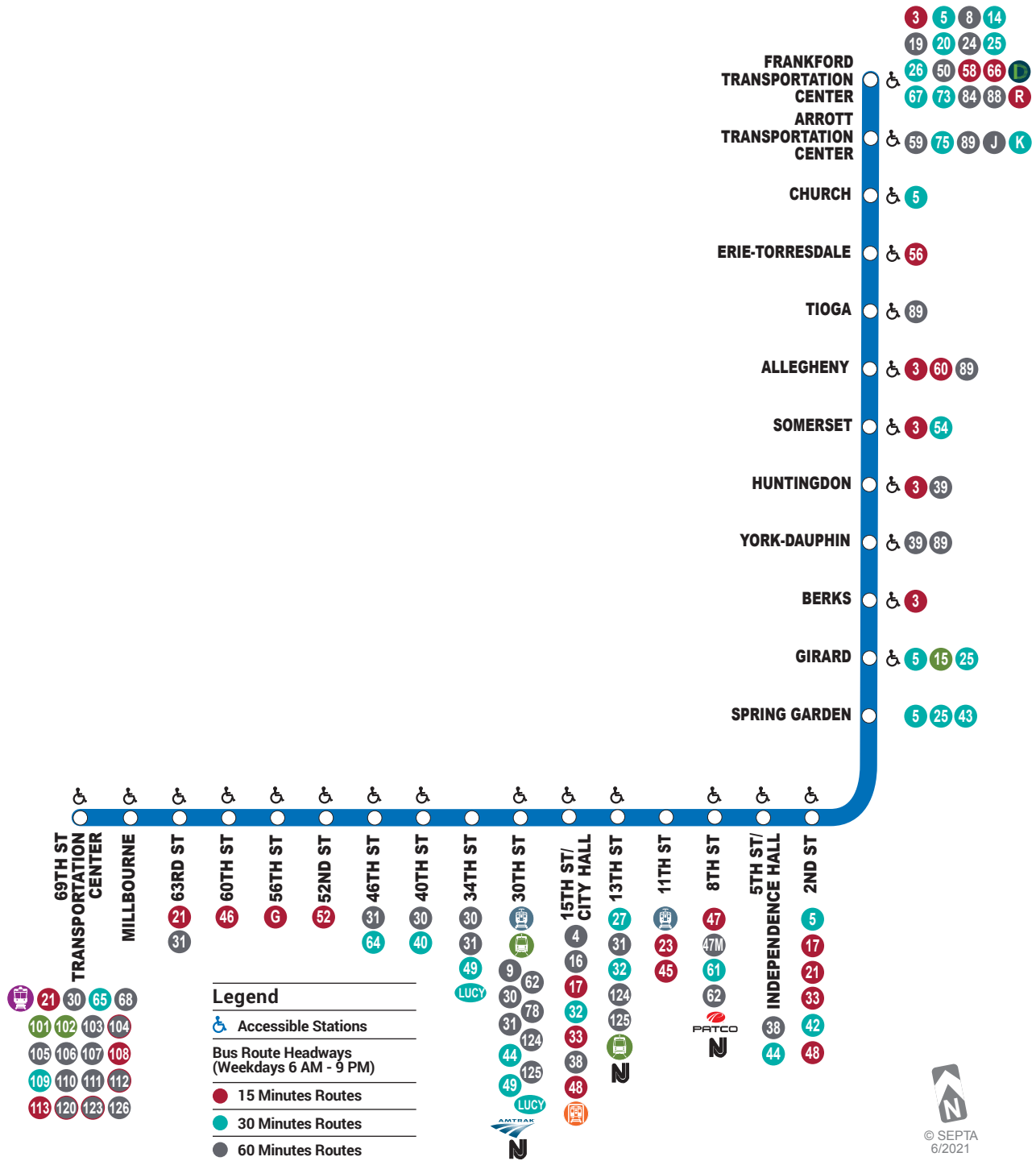

# Route 21

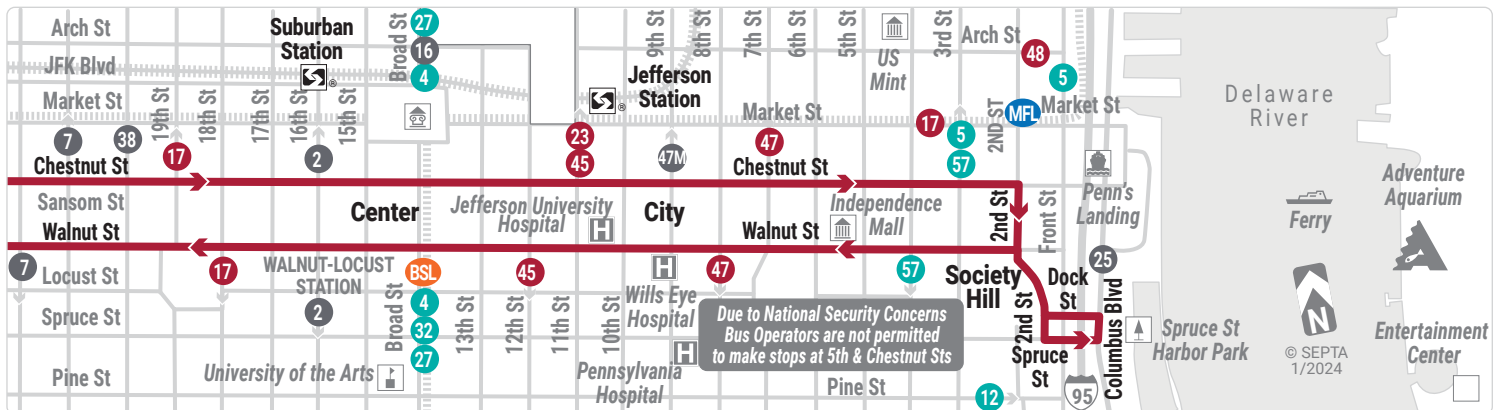
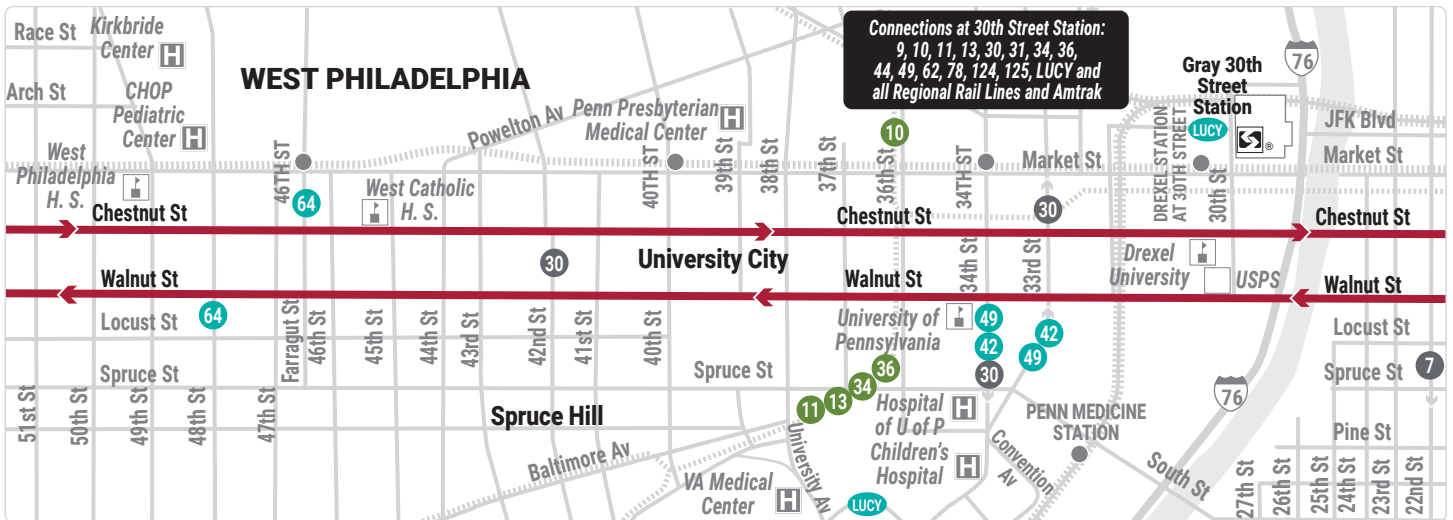
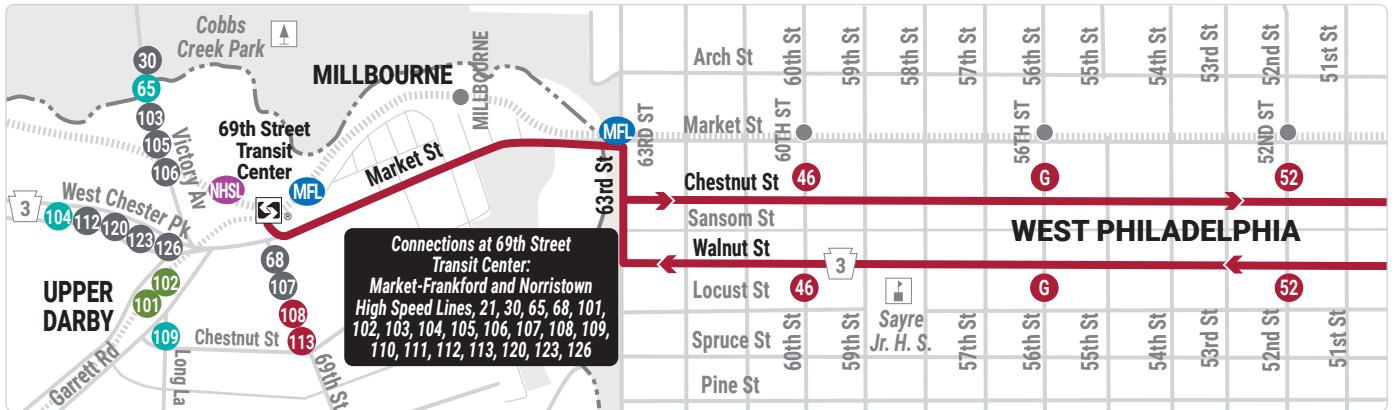

# Route 31

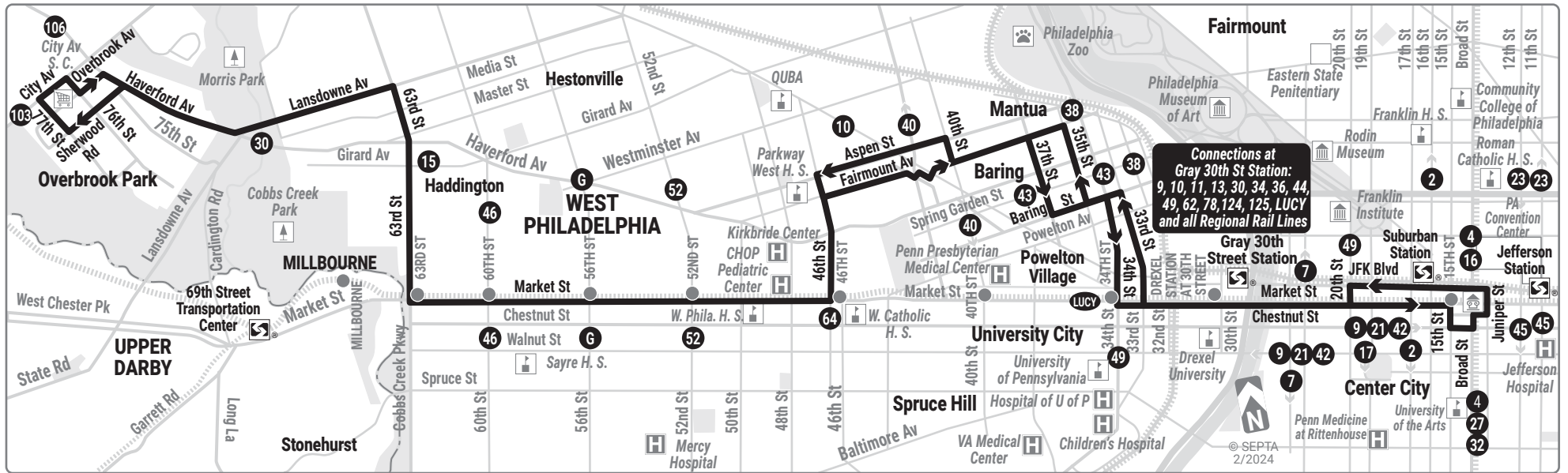

# Route G

