

BURLINGAME SOUTH BUSINESS CENTER

37th & Burlingame Rd (SEC),
Topeka, KS 66609

Professional Business Center

Large Parking Lots

Ideally located at I-470 and Burlingame Rd
with quick access to downtown
and all sectors of Topeka.

FOR SALE OR LEASE

FOR LEASE

\$11/SF/YR NNN.

\$4.30/SF/YR for Common Area Maintenance
Real Estate Taxes and Insurance.

Tenant improvements are negotiable

Space Available: Total = 15,830, Can Divide.

FOR SALE

Profit and Loss: Sept 2024 thru Aug 2025

Income	\$1,030,988
Operating Expenses	\$351,264
Net Operating Income (NOI)	\$679,724
Cap Rate	8.50%
Sale Price	\$7,996,753
Total Square Feet	62,057
Sale Price / Square Foot	\$129



3712 SW BURLINGAME RD, TOPEKA, KS

FOR LEASE

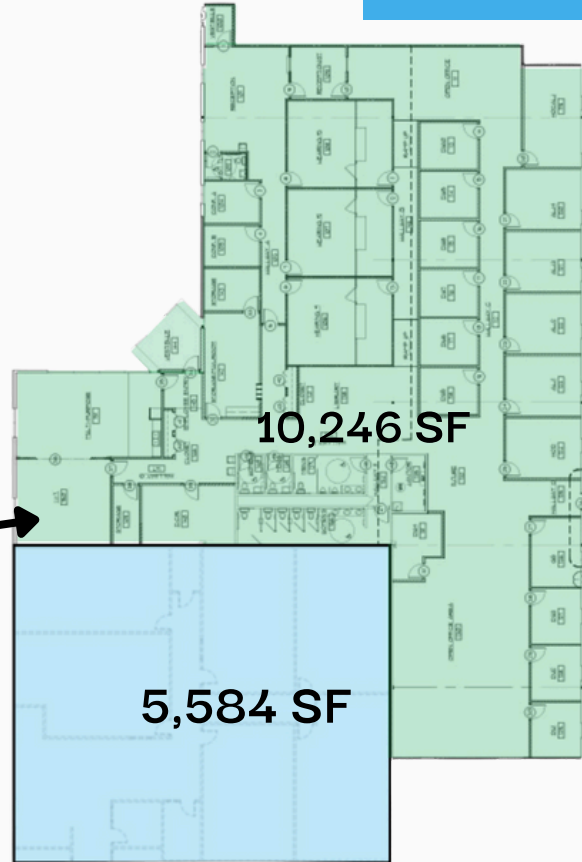

FOR SALE



Ken Schmanke | 785.554.8140 | ken.schmanke@k1hq.com

VALUE ADDED COMMERCIAL REAL ESTATE SERVICES SINCE 1988

The information contained herein has been obtained from sources believed reliable. While K1 Realty LLC does not doubt its accuracy, some of the information may need to be verified. K1 Realty LLC makes no guarantee and warranty with regard to the property or this information

K1
REALTY LLC