

General Information									
Name of Project									
Address									
Proposed Use									
Architects Letter of Supervision Provided? <input type="radio"/> Yes <input checked="" type="radio"/> No									
Codes used in design/Adopted by Baldwin County:									
2024 International Building Code (IBC) - with amendments 2024 International Residential Code (IRC) - with amendments 2024 International Mechanical Code (IMC) 2024 International Plumbing Code (IPC) - with amendments 2024 International Fuel Gas Code (IFGC) 2018 International Energy Conservation Code (IECC) - with amendments 2023 National Electrical Code (NEC) - with amendments 2025 Baldwin County Building Code Modifications									
Construction Description									
Addition <input checked="" type="radio"/> Alteration <input type="radio"/> New Construction <input type="radio"/> Renovation of Existing Building <input type="radio"/> Tenant Build-Out <input type="radio"/>									
Scope of Work - Building: RENOVATIONS									
Scope of Work - Electrical: EXISTING SERVICE TO BE SEPARATED									
Scope of Work - Mechanical: SINGLE HVAC TO BE SEPARATED									
Scope of Work - Plumbing NO PLUMBING REQUIRED SUITE 'B' TOILET BY TENANT									
Existing Buildings The building will remain in operation during construction <input type="radio"/> Yes <input checked="" type="radio"/> No If yes, add provisions for rigt safety barriers and dust barriers to protect the public during construction in accordance with the applicable provisions of IBC Chapter 34. Yellow safety tape is not acceptable.									
Renovations (Change of Occupancy) Is the work in this building or space changing the occupancy type? <input type="radio"/> Yes <input checked="" type="radio"/> No									
Historic Buildings Is this building a Historic Building? <input type="radio"/> Yes <input checked="" type="radio"/> No									
Construction Type IA IB IIA IIB IIA <input checked="" type="radio"/> VA VB									
Occupancy Classification									
Assembly 303 <input checked="" type="radio"/> Business 304 Education 305 Factory Industrial 306 High-Hazard 307 Institutional 308 Mercantile 309 Residential 310 Storage 311 Utility & Miscellaneous 312	A-1	A-2	A-3	A-4	A-5				
	F-1	F-1		H-4					
	H-1	H-2	H-3	H-4	H-5				
	I-1	I-2	I-3	I-4	Condition				
	R-1	R-2	R-3	R-4					
	S-1	S-2	High-piled						
Building Element									
Structural frame; columns, girders, trusses	0								
Bearing walls exterior	2								
Bearing walls interior	0								
Non-bearing walls & partitions exterior	0								
Non-bearing walls & partitions interior	0								
Floor construction; supporting beams and joists	0								
Roof construction; supporting beams and joists	0								
Sprinklers system Yes <input checked="" type="radio"/> No <input type="radio"/> Partial <input type="radio"/>									
Sprinkler type	13	13R	13D	Wet	Dry Class				
Standpipes	Yes <input checked="" type="radio"/>	No <input type="radio"/>							
Fire / Smoke Alarm	Requested Rating Hourly Rating & UL No. *								
Fire Rated Elements	N/A								
Ceiling-Floors	N/A								
Beams	N/A								
Columns	N/A								
Ceiling-Roofs	N/A								
Shatts-Exit	N/A								
Shatts-Other	N/A								
Corridor separation	N/A								
Occupancy separation	N/A								
Party/Fire wall separation	N/A								
Smoke barrier separation	N/A								
Tenant separations	N/A								
* Or other approved agencies									
All fire rated walls shall be identified on plans by hatching, shading, etc.; show legend. NOT APPLICABLE									
Reproduce full UL, Or other approved agencies details or reproductions of rated assemblies/penetrations on the drawings. NOT APPLICABLE									
Draft Stopping (IBC 7)									
Draft stopping in floor (IBC 718.3) <input type="radio"/> Yes <input checked="" type="radio"/> No									
Draft stopping in attic (IBC 718.4) <input type="radio"/> Yes <input checked="" type="radio"/> No									
Accessibility (IBC 11)									
Design conforms to IBC Chapter 11 and ICC A117.1-2009? <input checked="" type="radio"/> Yes <input type="radio"/> No									
Design Loads (per structural)									
N/A									
Wind-Borne Debris Region (IBC 1609)									
This building will use impact resistant glass per (IBC 1609.1.2) <input type="radio"/> Yes <input checked="" type="radio"/> No									
This building will use engineered shutters or other approved method <input type="radio"/> Yes <input checked="" type="radio"/> No									
Special Inspections and Tests (IBC 17)									
I have reviewed the requirements of IBC Section 17, specifically 1705; the design incorporates the requirements and is reflected on the drawings and in the specifications. Below are the requirements to be included:									
N/A									

--	--

EGRESS CALCULATIONS

EXISTING BUILDING CONSTRUCTION - IIIB / NS

OCCUPANCY - 'B' - BUSINESS

OCCUPANT LOAD CALCULATIONS

TOTAL BUILDING NSF = 2,452 (APPROX.) SF. (INSIDE FACE OF WALL)

TOTAL BUILDING OCCUPANCY:

'B' OCCUPANCY = 2,452 / 150 SF = 16 OCCUPANTS

SUITE 'A' = 1,409 / 150 = 9
SUITE 'B' = 1,043 / 150 = 7

PER IBC T 1006.2.1. & 1006.2.1 - ONE EXIT REQ'D.
(LESS THAN 49 OCCUPANTS)

EXITS PROVIDED: 2 EACH

LEGEND



EXIT ACCESS DOOR
W/ EXIT/EMER LIGHT
(BATTERY BACK-UP)

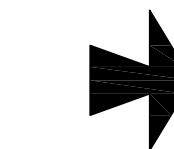

EXIT DISCHARGE

95'-4"

TRAVEL DISTANCE



FIRE EXTINGUISHER
AND CABINET/BRACKET

NOTES

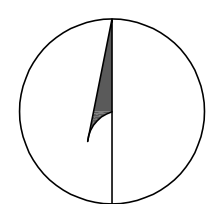
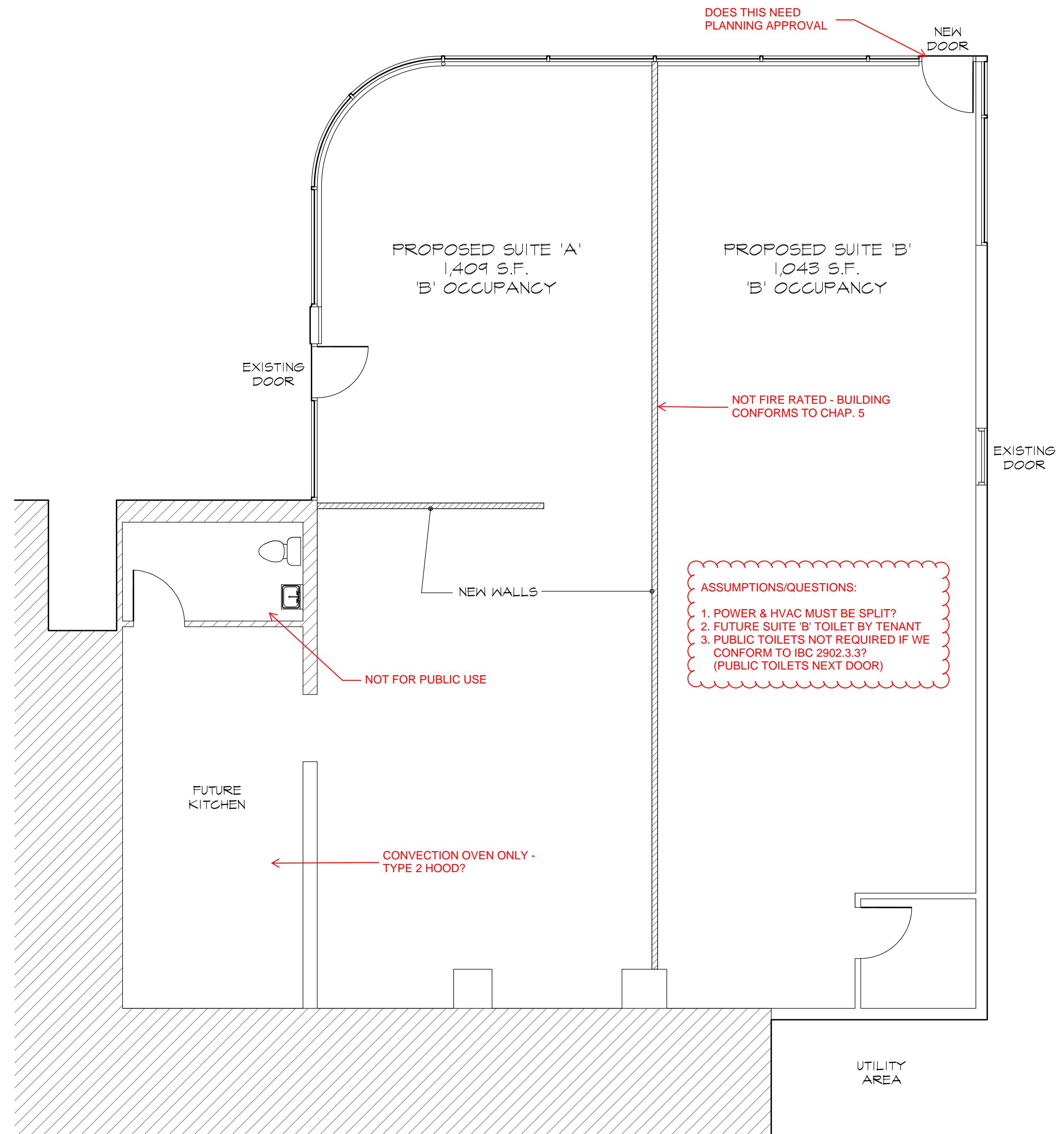

LIFE SAFETY PLAN

SCALE 1/8" = 1'-0"

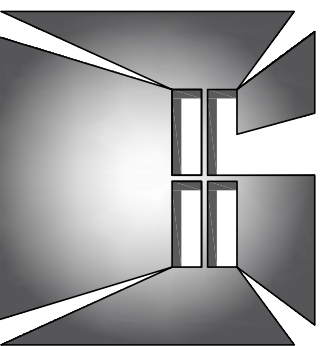

CLARKITECHS, P.C.
ARCHITECTURE
(251) 680-7131

MODIFICATIONS TO:
2 NORTH SECTION STREET
FAIRHOPE, ALABAMA

[illegible]

DATE:	11-10-25
JOB NUMBER:	25-51