

FOR SUBLEASE

1802 BRIERLY WAY SUITE 103

SPARKS, NV 89434

±17,980 SF Industrial / Manufacturing / Distribution

±777 SF Office including reception, private offices, & two bathrooms

Heavy Power: 400A / 480V / 3Ph (tenant to verify)

Four loading dock positions / roll-up doors

One grade-level drive-in door

Sublease term through May 31, 2028 - Longer lease terms possible

BRAD LANCASTER, SIOR

Industrial Services - Kidder Mathews
775.690.0535 | brad.lancaster@kidder.com

LIC B*0144389.CORP

CASEY PROSTINAK, SIOR

Vice President - Logic Commercial
775.813.2866 | cprosinak@logiccre.com

LIC S*177148.LLC



\$.60 / SF
LEASE RATE

\$.15 / SF
2026 ESTIMATED NNN/CAM

KIDDER.COM

This information supplied herein is from sources we deem reliable. It is provided without any representation, warranty, or guarantee, expressed or implied as to its accuracy. Prospective Buyer or Tenant should conduct an independent investigation and verification of all matters deemed to be material, including, but not limited to, statements of income and expenses. Consult your attorney, accountant, or other professional advisor. All Kidder Mathews designs are the sole property of Kidder Mathews. Branded materials and layouts are not authorized for use by any other firm or person.



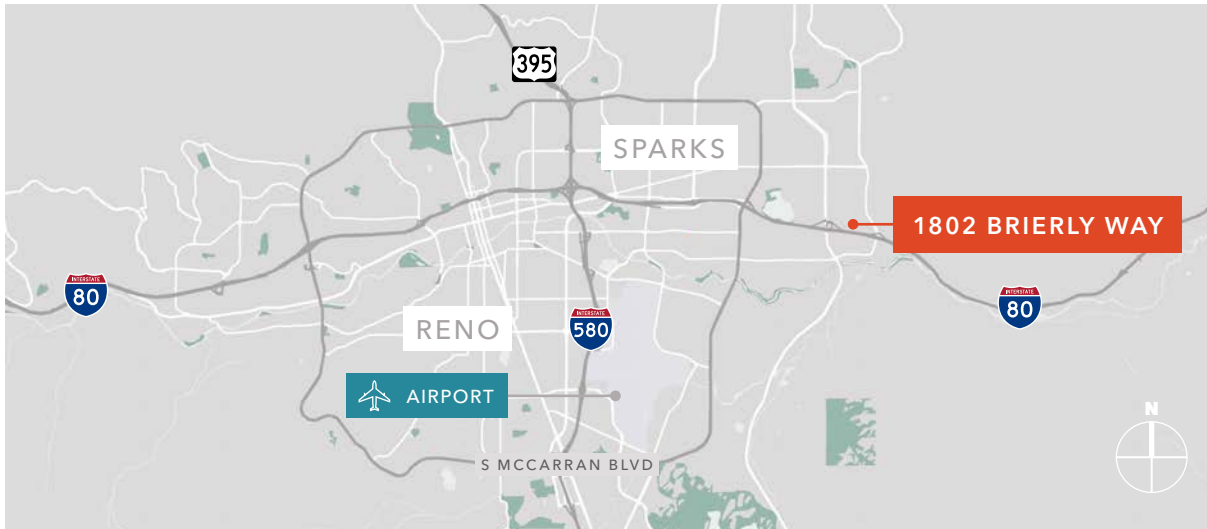

Property Information

INDUSTRIAL SPACE	17,980 SF
POWER	400A / 480V / 3Phase (tenant to verify)
LOADING DOCK DOORS	Four
GRADE-LEVEL DOOR	One 12' X 14'
COLUMN SPACING	48' X 50'
OFFICE SPACE	±777 SF
CLEAR HEIGHT	±26'
SPRINKLER SPEC	.33/3,000

Location Advantages

- Proximity to I-80 and Hwy 395/I-580 on/off ramps
- Located within desirable metro Industrial area
- Proximity to FedEx, UPS and other shipping hubs
- Access to large labor pool and services for employees
- Proximity to Reno-Tahoe International Airport private and commercial terminals
- Proximity to Tesla, Apple, Google, and many other high-profile corporate citizens

FLOOR PLAN

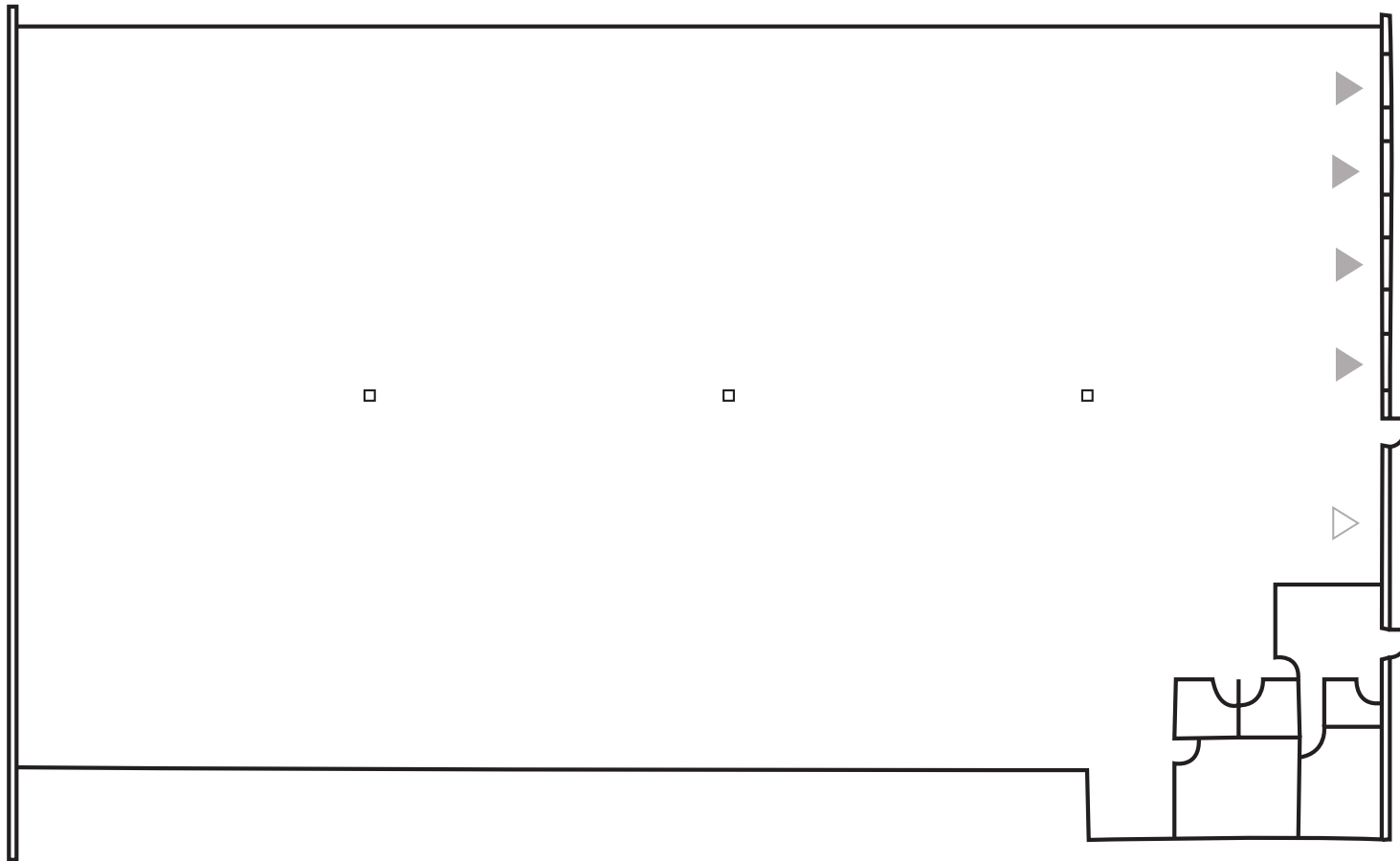

±17,980
SF TOTAL

±777
SF OFFICE

- ▲ Dock-high loading door
- △ Grade-level drive-in door

TRANSPORTATION

Ground	Miles
RENO-TAHOE INT'L AIRPORT	6.3
RENO-STEAD FBO	16.1
UPS REGIONAL	0.9
FEDEX EXPRESS	4.5
FEDEX GROUND	6.2
FEDEX LTL	4.1

DEMOGRAPHICS

2026	3 mi	5 mi	7 mi
POPULATION	49,672	131,927	282,039
HOUSEHOLDS	20,568	52,962	116,748
AVG HH INCOME	\$107,769	\$99,223	\$103,875
TOTAL EMPLOYEES	28,646	64,600	150,911

NEVADA STATE INCENTIVES

- No state, corporate or personal income tax
- No estate tax, no inventory tax, no unitary tax, no franchise tax
- Right-to-work state
- Moderate real estate costs
- Low workers' compensation rates
- State-qualified employee hiring incentive

HELPFUL LINKS

- Business Costs** <https://www.edawn.org/site-selector/business-relocation-advantages/>
- Business Incentives** <https://goed.nv.gov/programs-incentives/incentives/>
- Cost of Living** https://www.nvenergy.com/publish/content/dam/nvenergy/brochures_arch/about-nvenergy/economic-development/costoflivingred.pdf
- Quality of Life** <http://edawn.org/live-play/>



Source: [NVEnergy](#)
Last updated: 2020

BUSINESS COST COMPARISONS

	NV	CA	AZ	UT	ID	OR	WA
TAX COMPARISONS							
STATE CORPORATE INCOME TAX	No	8.84%	4.9%	4.95%	6.925%	6.6%-7.6%	No
PERSONAL INCOME TAX	No	1%-13.3%	2.59%-4.54%	4.95%	1.125%-6.925%	5%-9.9%	No
PAYROLL TAX	1.378% > \$50K/Q	0.380% (2019)	No	No	No	0.73%-0.7537%	No
MONTHLY PROPERTY TAX (BASED ON \$25M MARKET VALUE)	\$22,969	\$26,041	\$68,096	\$31,850	\$34,792	\$50,000	\$21,125
UNEMPLOYMENT TAX	0.3%-5.4%	1.5%-6.2%	0.04%-12.76%	0.10%-7.10%	0.26%-5.4%	0.70%-5.4%	0.13%-5.72%
CAPITAL GAINS TAX	No	13.3%	4.5%	4.95%	6.93%	9.9%	No

KIDDER.COM

This information supplied herein is from sources we deem reliable. It is provided without any representation, warranty, or guarantee, expressed or implied as to its accuracy. Prospective Buyer or Tenant should conduct an independent investigation and verification of all matters deemed to be material, including, but not limited to, statements of income and expenses. Consult your attorney, accountant, or other professional advisor. All Kidder Mathews designs are the sole property of Kidder Mathews. Branded materials and layouts are not authorized for use by any other firm or person.

