

For Lease

Louetta Medical Professional Building

34,093 SF Medical/Retail Professional Office Building

10130 Louetta Road, Houston, TX 77070



Building Features

- Medical/Retail Professional Office Building
- Availability from 1,263 SF to 3,236 SF
- Easy accessibility from Highway 249
- Parking ratio: 5.9/1,000
- RBA: 34,090



Availability

Tenancy

- Aesthetics
- Optometry
- Hearing Support
- Dental
- Urgent Care
- Pet Care

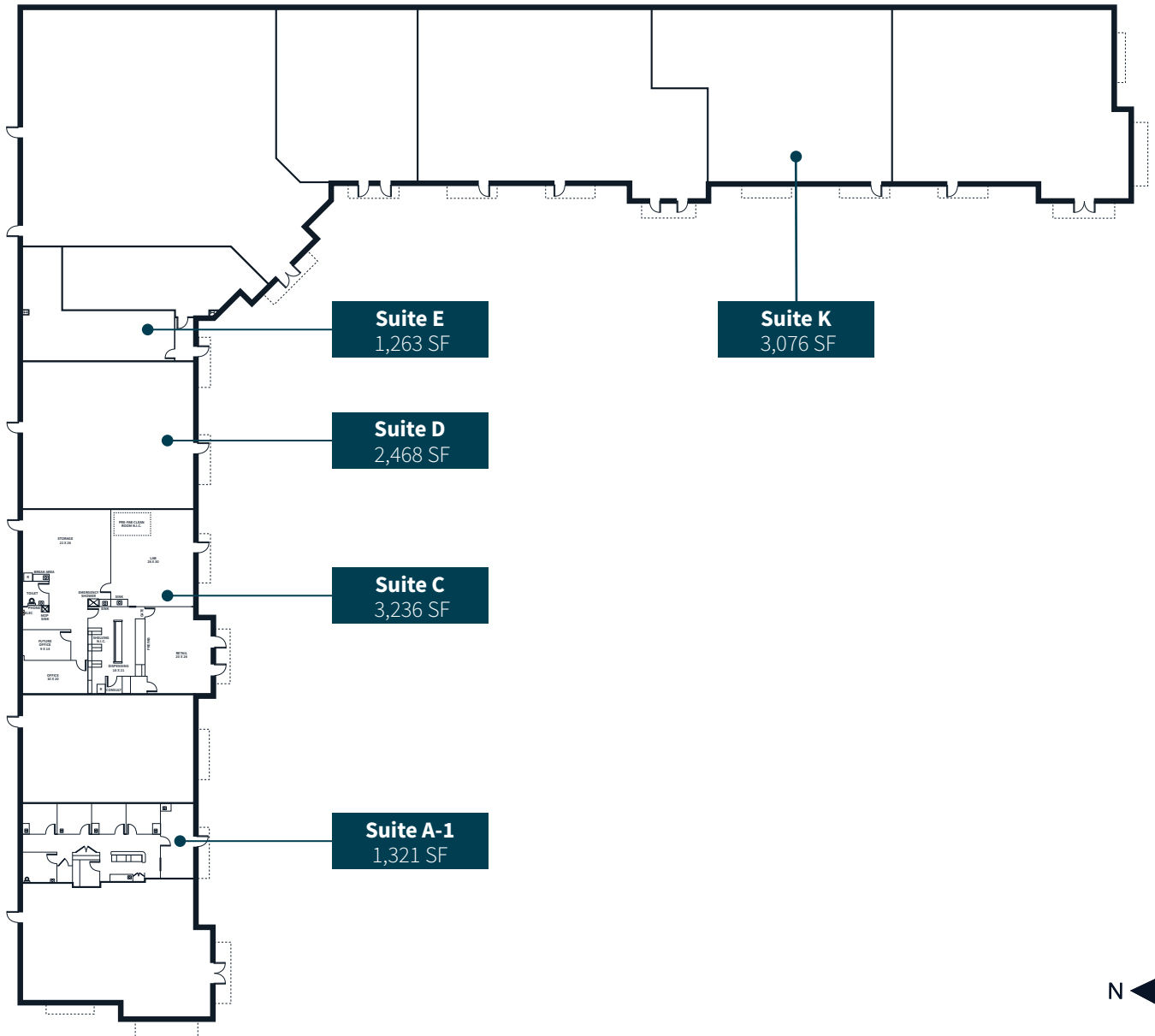

Vacancies

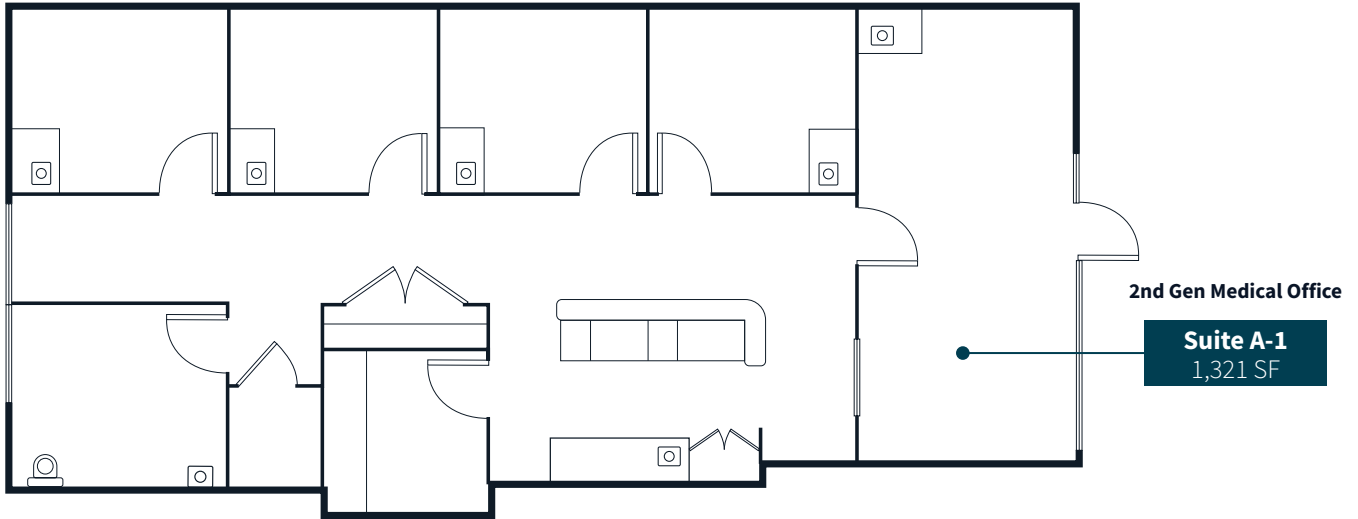

2nd Gen Pharmacy Space

Suite C
3,236 SF

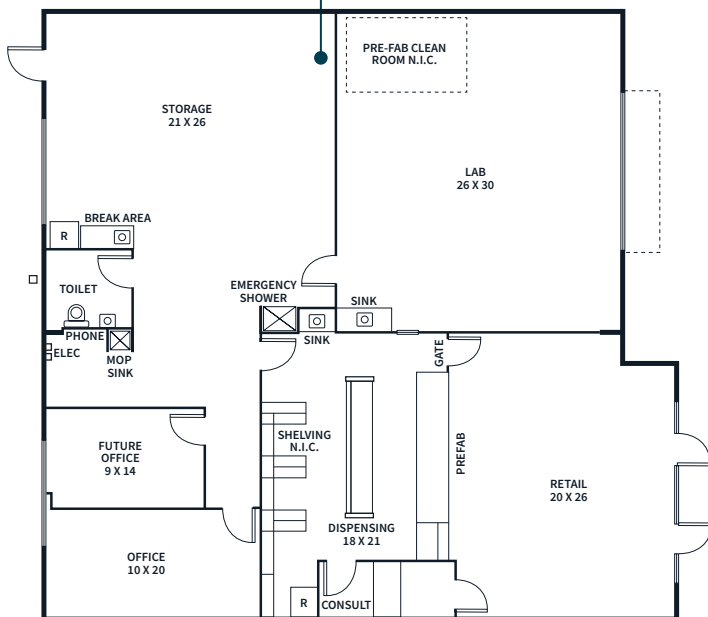

2nd Gen Office Space

Suite D
2,468 SF

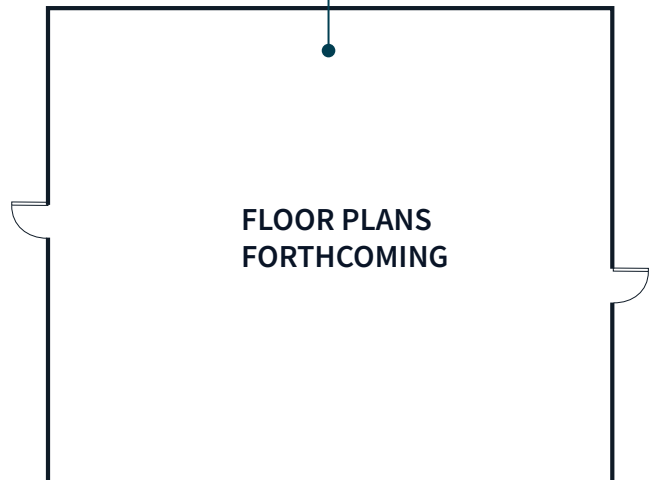

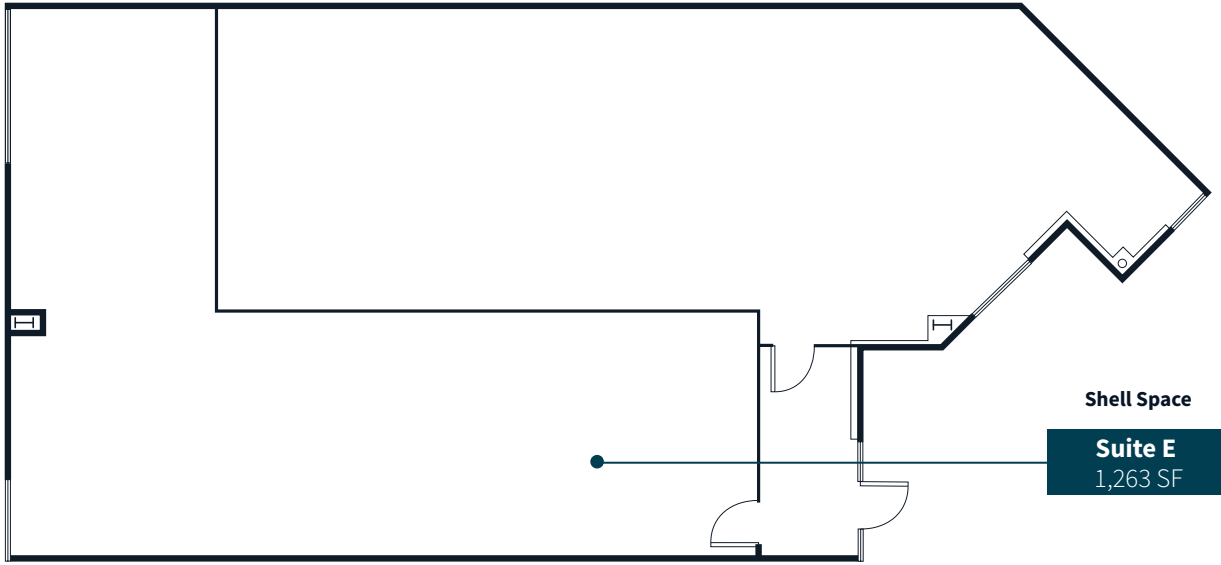

2nd Gen Office Space

Suite K
3,076 SF

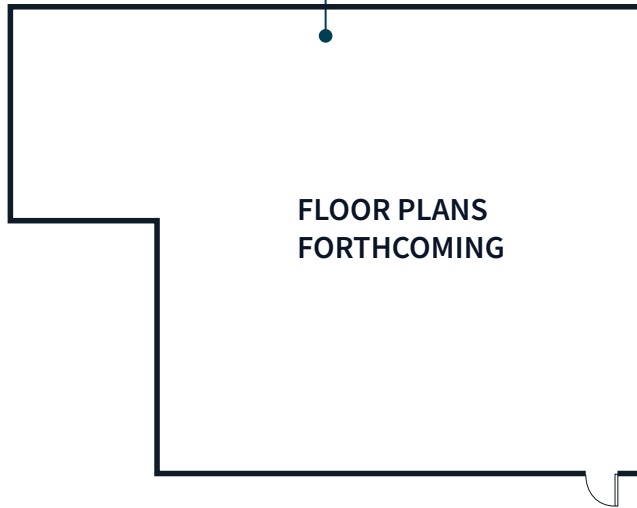

Area Demographics

Key facts

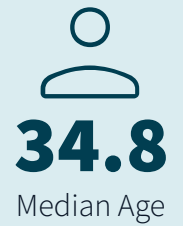
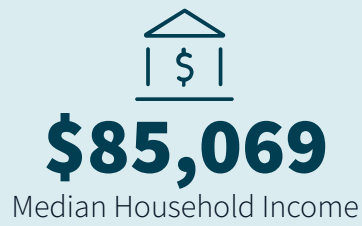
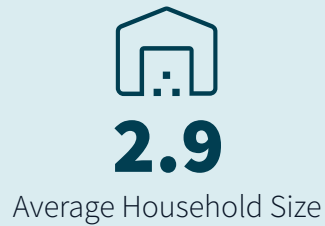
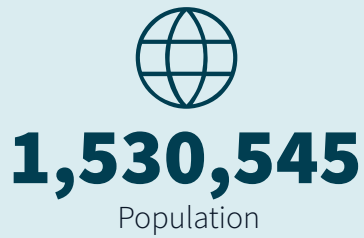

Insurance mix

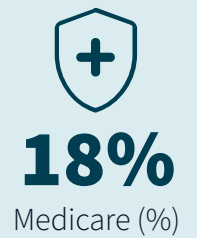
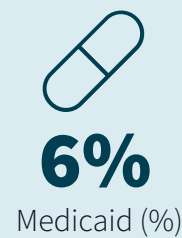

Employment

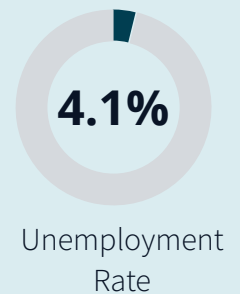
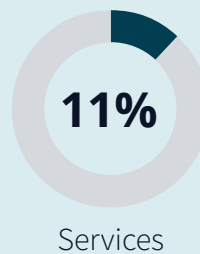
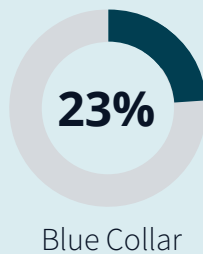
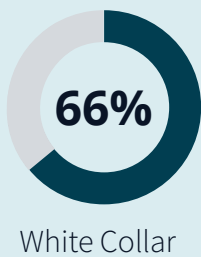

Education

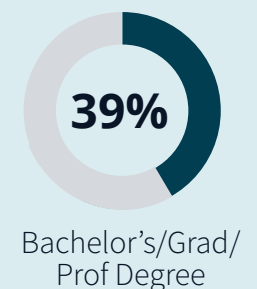
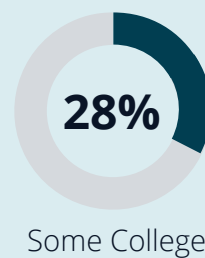
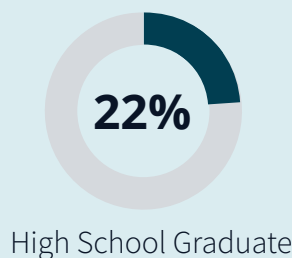
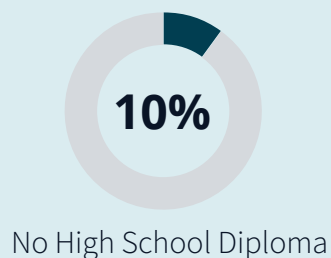

Location

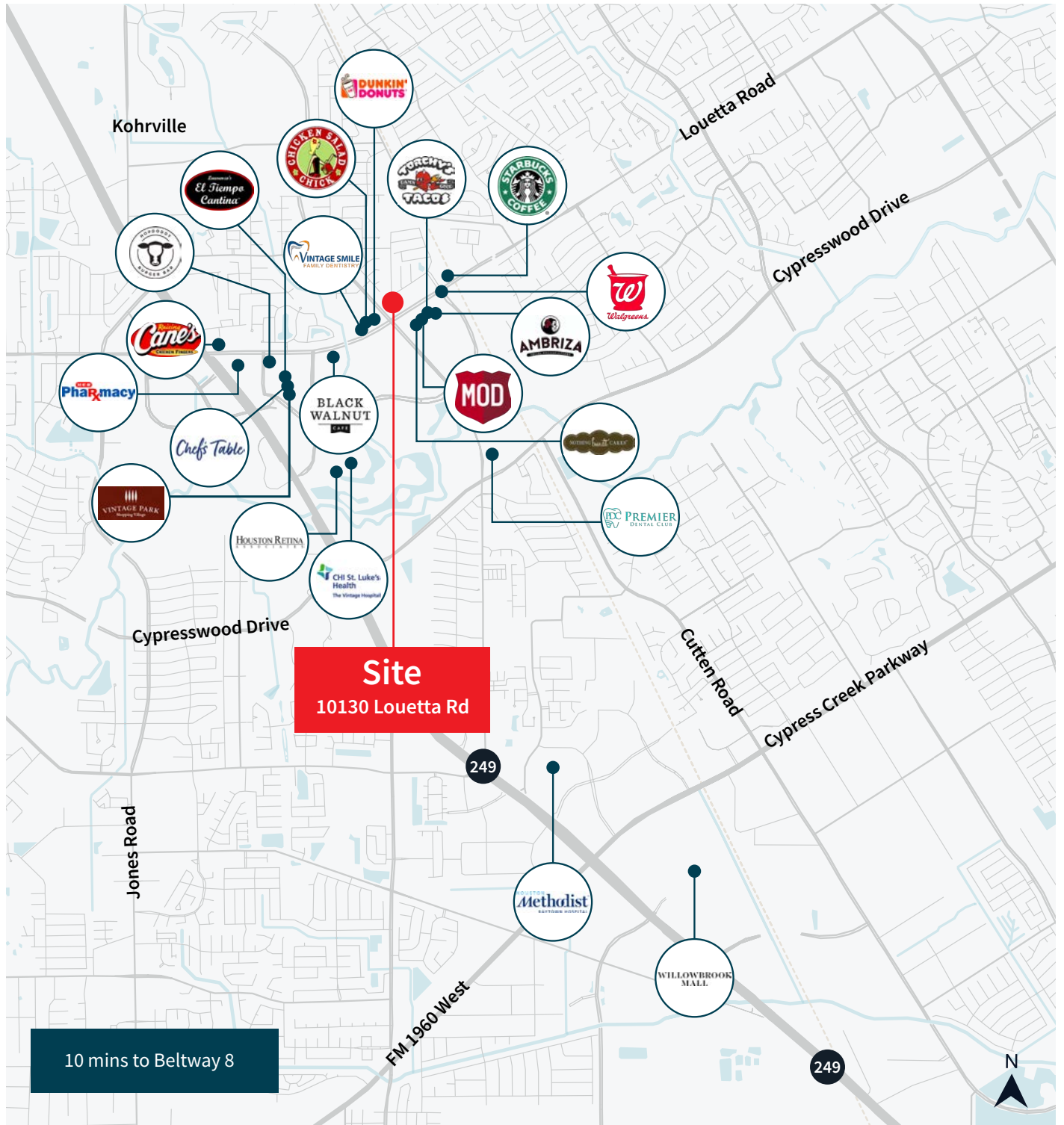

For Lease

10130 Louetta Road, Houston, TX 77070



Contact broker for rates

Kendall Kerr

kendall.kerr@jll.com

+1 713 243 3306

Tim Gregory

tim.gregory@jll.com

+1 713 888 4061

Although information has been obtained from sources deemed reliable, JLL does not make any guarantees, warranties or representations, express or implied, as to the completeness or accuracy as to the information contained herein. Any projections, opinions, assumptions or estimates used are for example only. There may be differences between projected and actual results, and those differences may be material. JLL does not accept any liability for any loss or damage suffered by any party resulting from reliance on this information. If the recipient of this information has signed a confidentiality agreement with JLL regarding this matter, this information is subject to the terms of that agreement. ©2024. Jones Lang LaSalle IP, Inc. All rights reserved.