



MEDICAL OFFICE FOR LEASE

±3,234 RSF Available for Lease

Property Highlights

- Private Offices & Multiple Exam Rooms
- Large Reception Area & Waiting Room
- New ADA Restrooms
- Within Walking Distance to O'Connor Hospital
- Easy Access to Hwy 17, 880, and 280
- Monument & Building Signage Available
- Close Proximity to Valley Fair and Santana Row
- Potential Future Expansion
- \$3.30 psf Modified Gross/mo
- Call to Tour



Aaron Fritz, CCIM
Senior Vice President
+1 408 588 2398
aaron.fritz@kidder.com
LIC #01216555

Drew Arvay
Managing Director
+1 408 803 6000
drew.arvay@cushwake.com
LIC #00511262

300 Santana Row, Fifth Floor
San Jose, California
main +1 408 615 3400

cushmanwakefield.com

SECOND FLOOR

Available Now

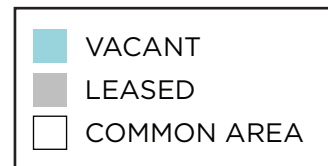

SUITE 200: ±3,234 RSF

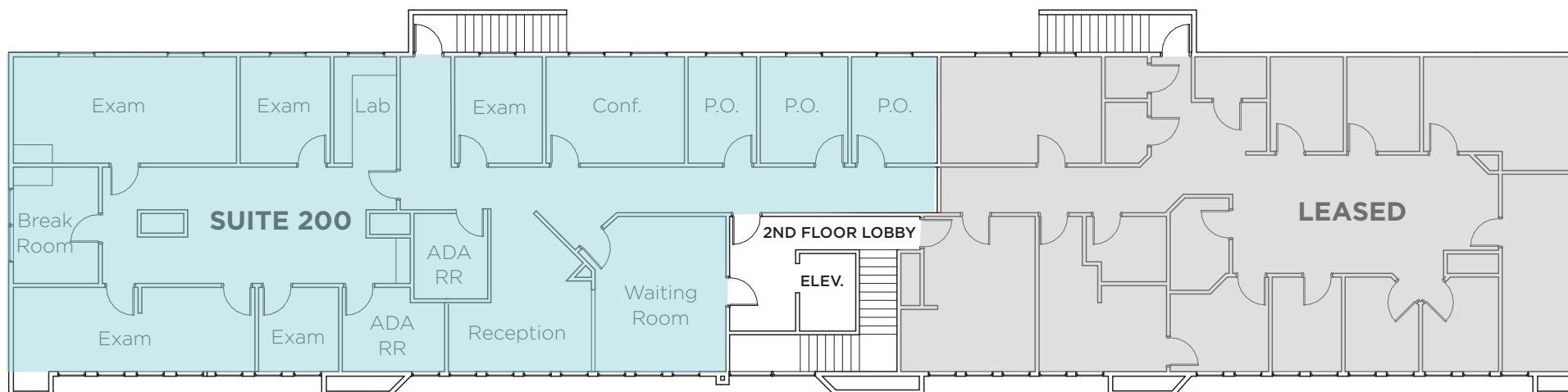

Aaron Fritz, CCIM
Senior Vice President
+1 408 588 2398
aaron.fritz@kidder.com
LIC #01216555

Drew Arvay
Managing Director
+1 408 803 6000
drew.arvay@cushwake.com
LIC #00511262

300 Santana Row, Fifth Floor
San Jose, California
main +1 408 615 3400

cushmanwakefield.com