



Gall Real Estate
Services, LLC

www.Gallre.com

PO Box 1071
Dallas, OR 97338

\$0.68/SF/Mo.
Approx.
6,695 SF to
32,228 SF
Available
Lease Type:
NNN
Zoned: IP

*For additional information
on this property please contact:*

Jennifer Hand
Broker
jhand@gallre.com
503.363.6051 (ph)
503.363.1791 (fax)
503.559.9839 (cell)

3220 Pringle Rd. SE
Salem, OR 97302

For Lease
Lease Rate Reduced!



PROPERTY HIGHLIGHTS:

- Warehouse spaces for lease in Southeast Salem.
- Near the Airport and easy I-5/Highway 22 access.
- Approximately 18' clear height.
- Sprinkled Fire System.
- On-site parking.
- Approximately 1200 amp/440 power total currently.
- On-site parking.
- 6,695 SF, 9,004 SF and 11,485 SF all available with an additional 5,000 that can be added if needed.
- Tenant to pay pro-rata share of water and sewer, shared Restrooms, plus all other utilities.

This information has been secured from sources we believe to be reliable, but we make no representations or warranties, expressed or implied, as to the accuracy of the information. Reference to square footage or age are approximate.

3220 Pringle Rd. SE Suite #120 Salem, OR 97302

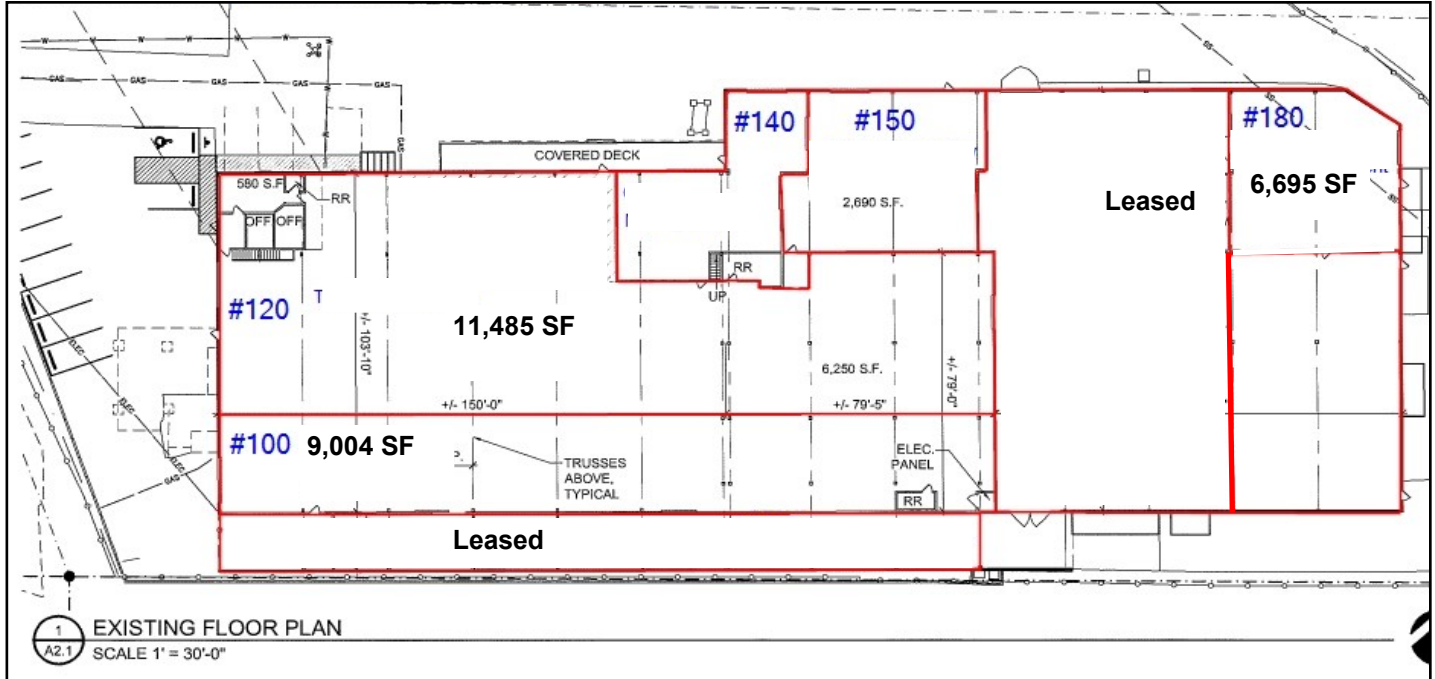

For additional information on this property please contact:

Jennifer Hand, Broker
jhand@gallre.com
503.363.6051 (ph)
503.363.1791 (fax)
503.559.9839 (cell)

Gall Real Estate Services, LLC PO Box 1071 Dallas, OR 97338

This information has been secured from sources we believe to be reliable, but we make no representations or warranties, expressed or implied, as to the accuracy of the information. Reference to square footage or age are approximate.