





# FOR LEASE 513 Express Center Drive

Chicago, IL



**138,000 SF**

## Property Features

-  138,000 SF available
-  Proximity to O'Hare International Airport
-  Immediate access to I-90 and I-294
-  Heavy car and trailer parking
-  800a 277/480v 3p



Owned By  
**mapleiree**

Leasing By  
**CBRE**

**Matt Mulvihill**  
Vice Chairman  
312. 493. 5522  
matt.mulvihill@cbre.com

**Cal Payne**  
Executive Vice President  
312. 343. 7707  
calum.payne@cbre.com

# Property Specifications

- »» Building/Available Size: 138,000 SF
- »» Office Size: 32,000 SF (two-story)
- »» Clear Height: 24'
- »» Loading Docks: 53 Exterior
- »» Drive in Doors: 2
- »» Trailer Parking: 30 stalls
- »» Car Parking: 176 spaces
- »» Year Built: 1996
- »» Date Available: 8/1/2026

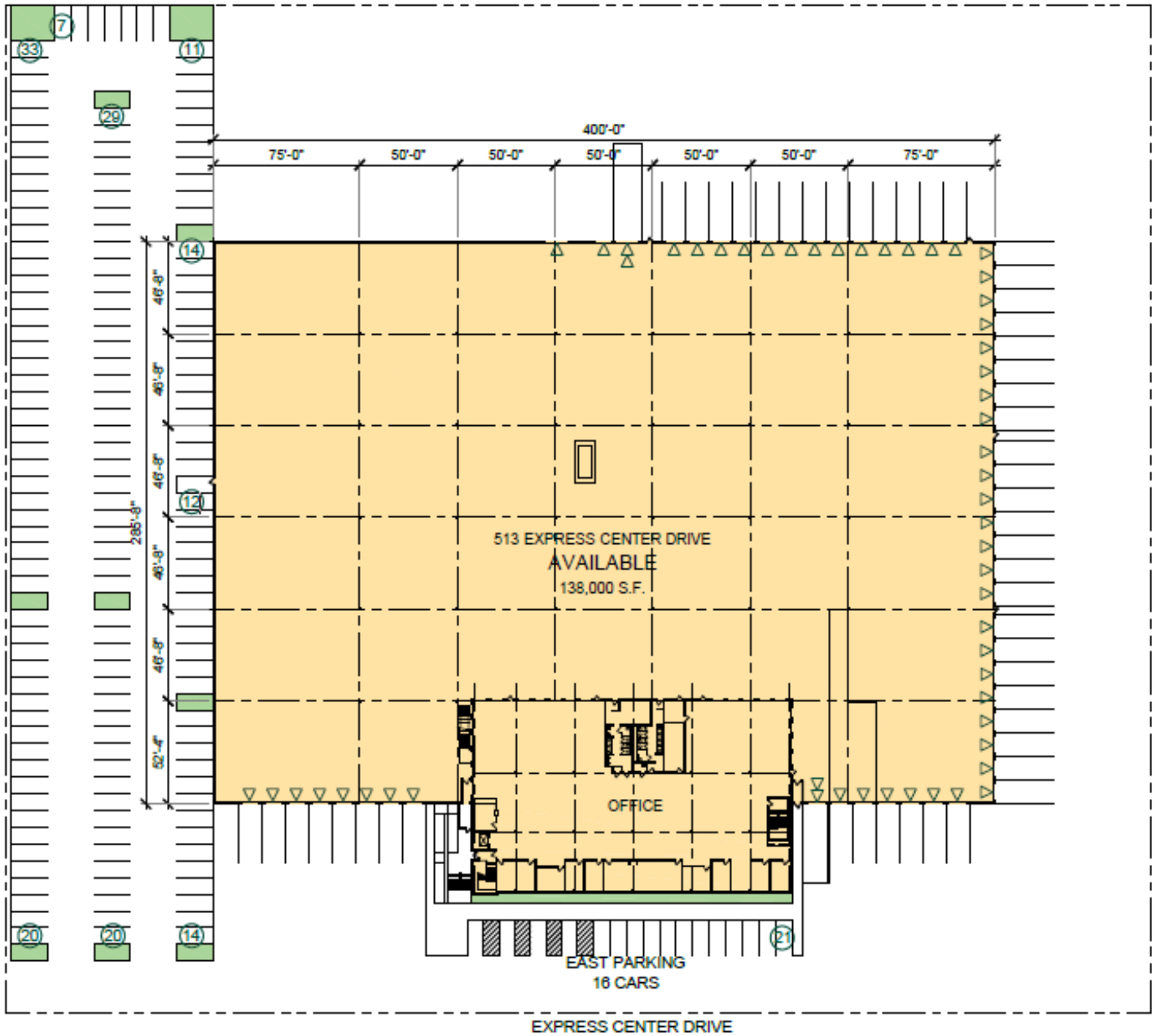

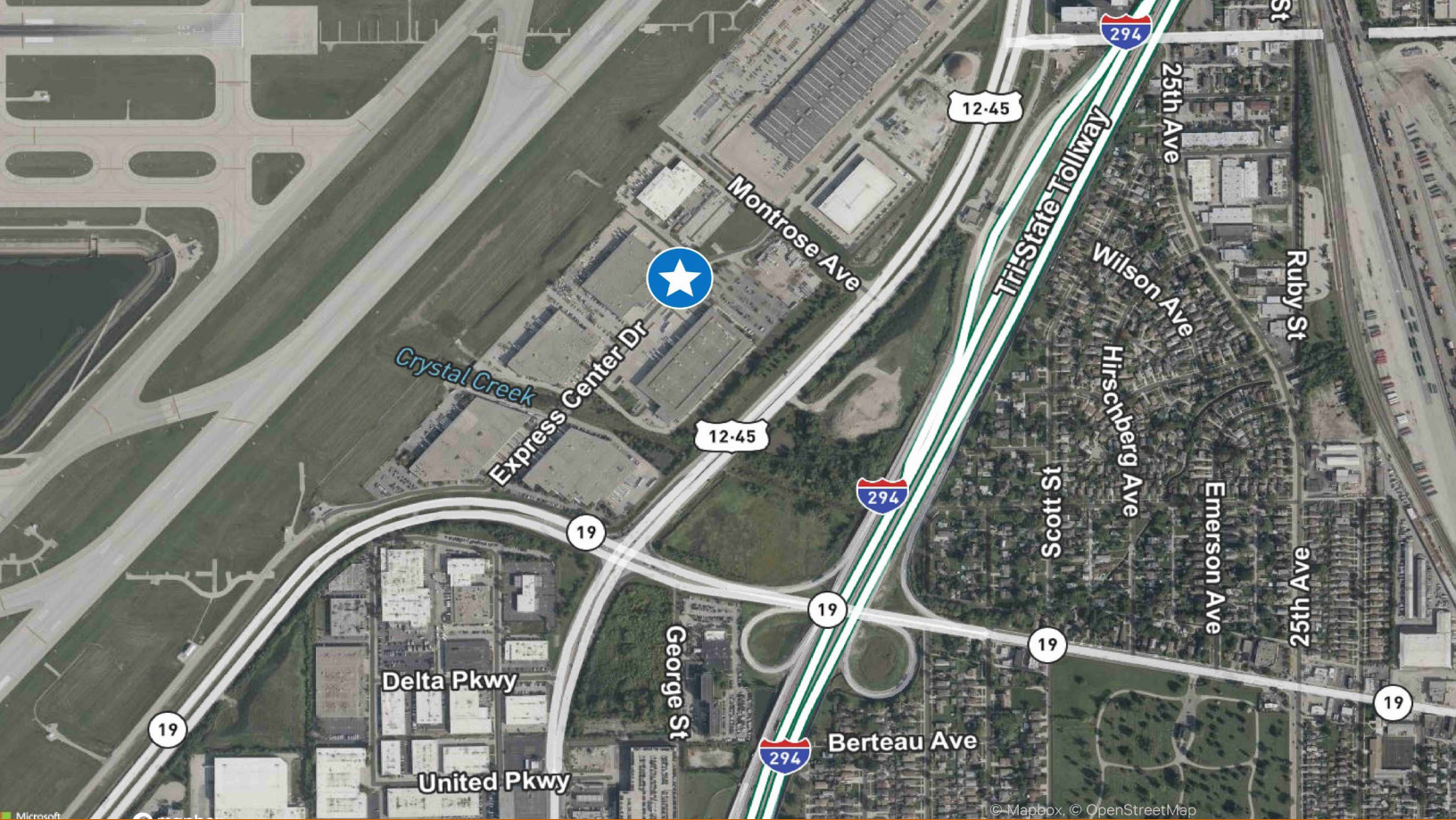

## Strategic Location

513 Express Center Drive, Chicago, IL is strategically located with immediate access to key transportation arteries, including I-90 (Jane Addams Memorial Tollway), I-294, and Irving Park Road, along with proximity to O'Hare International Airport, supporting efficient local, regional, and national distribution. Positioned within Chicago's O'Hare submarket, the property benefits from a dense logistics network, strong labor pool, and premier connectivity to major Midwest markets, making it an ideal location for distribution, light manufacturing, and corporate operations.

## About Us

Mapletree is a leading global real estate developer, investor and manager headquartered in Singapore. Mapletree owns and manages 70 million square feet of logistics and industrial properties across 26 states with offices in New York, Chicago, Atlanta, Dallas and Los Angeles.

[www.mapletree.com.sg](http://www.mapletree.com.sg)



Owned By

**mapletree**

Leasing By

**CBRE**

**Matt Mulvihill**

Vice Chairman

312. 493. 5522

[matt.mulvihill@cbre.com](mailto:matt.mulvihill@cbre.com)

**Cal Payne**

Executive Vice President

312. 343. 7707

[calum.payne@cbre.com](mailto:calum.payne@cbre.com)