

Retail Opportunities

FOR LEASE

Cedar Lane - 1301 Kingsway, East Vancouver, BC



A NEW CULTURAL RETAIL AND DINING DESTINATION IN THE HEART OF LITTLE SAIGON, EAST VANCOUVER.



FOR REAL ESTATE INQUIRIES, PLEASE CONTACT:

LARISSA JACOBSON-ROOKE

Executive Vice President, Western Canada
604.616.0013 ext. 353 | C: 604.992.4200
ljacobson@thebehargroup.com

CHELAN KUJUNDZIC

Western Canada, Commercial Sales & Leasing
604.616.0013 ext. 358 | C: 778.317.7477
chelan@thebehargroup.com

The Behar Group Realty Inc., Brokerage

Property HIGHLIGHTS

Discover the perfect location for your business in the heart of Little Saigon, East Van—where cultural sophistication meets vibrant community, creating a new destination for local eateries and residents.

ADDRESS:

1301 Kingsway, Vancouver, BC

LOT SIZE:

0.33 acres

ASSET CLASS:

Mixed use Residential/Office/Retail

GLA (RETAIL):

10,192 sf

CURRENT ZONING:

CD-1 (741)

POSSESSION:

Immediately

Comprehensive Development district

OTHER NOTES:

- **Prime Corner Exposure** at Kingsway & Clark Drive in Vancouver's dynamic Little Saigon district (unmatched visibility to daily commuter and pedestrian traffic.)
- **New Construction (2025):** mixed-use landmark with 54 upscale rental homes above and four premium street-level retail units below.
- **Flexible Retail Opportunities:** from approximately 1,200 SF to 3,200 SF, with double-height storefronts and mezzanine layouts for flexible retail or restaurant use.
- **Food-Ready Infrastructure:** Units A & B feature Class 1 kitchen venting to roof, ideal for café or restaurant concepts.
- **Customer Convenience:** 2 loading bays for seamless access and operations.
- **Transit & Connectivity:** minutes to the Broadway Subway (Mount Pleasant Station) and only 18 minutes to Downtown Vancouver.
- **Vibrant Neighbourhood Ecosystem:** surrounded by destination dining (Earnest Ice Cream & Do Chay), grocers, and community services — a proven retail hub with a 96 Walk Score / 86 Bike Score.



Location MAP

DEMOGRAPHICS	5-min	7-min	10-min
Total Population	113,793	229,599	502,604
Total Daytime Population	93,385	206,677	515,265
Total Households	45,843	92,756	208,573
Average Household Income	\$129,647	\$127,974	\$127,207

Source: Estimates Environics, 2024



Leasing INFORMATION

	LEVEL 1	LEVEL 2	TOTAL
CRU A	2,246 SF	511 SF	2,757 SF
CRU B	1,218 SF		1,218 SF
CRU C	1,778 SF	717 SF	2,495 SF
CRU D	2,345 SF	660 SF	3,005 SF
Pricing	Contact Listing Agents		

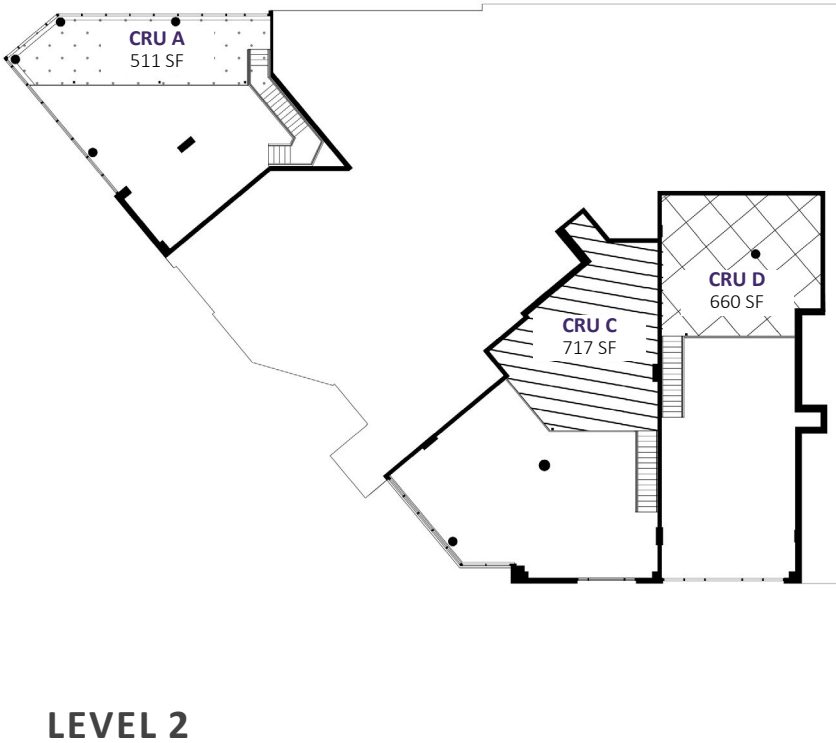
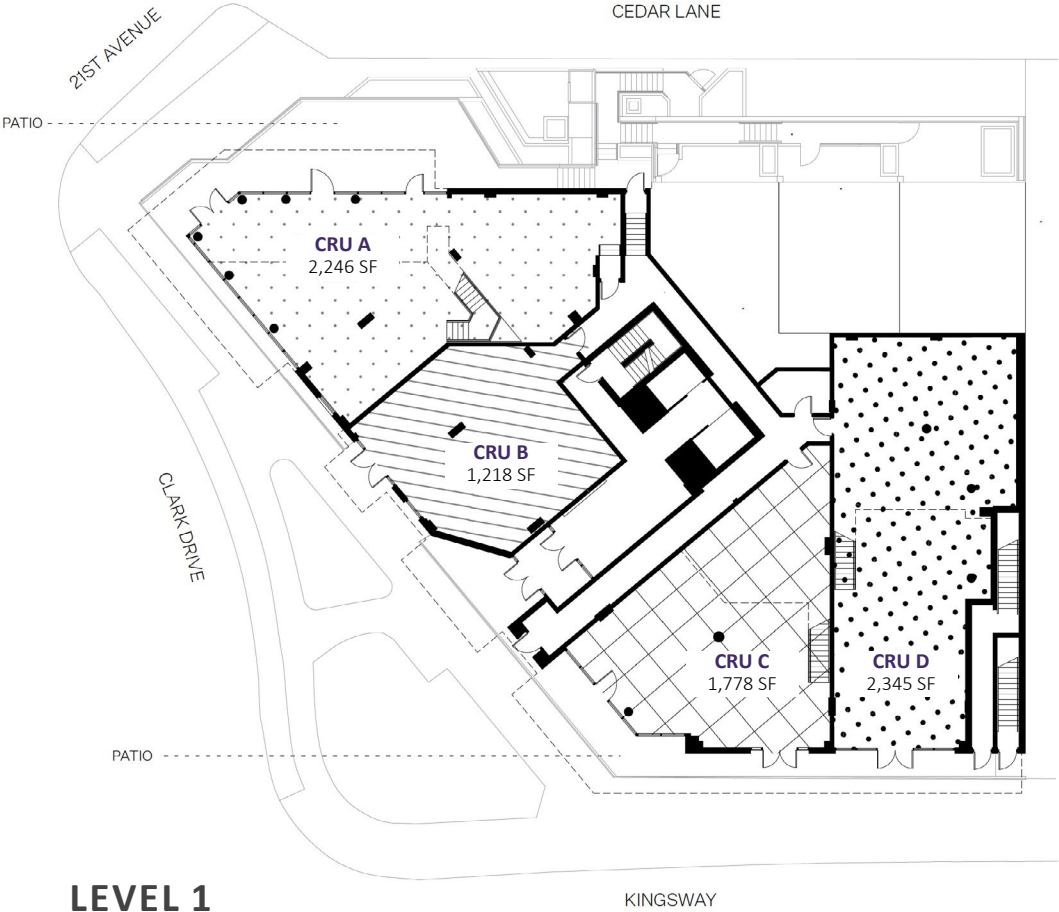

ADDITIONAL PHOTOS



CONTACTS

All listing inquiries should be directed to the Designated Representative(s):

LARISSA JACOBSON-ROOKE

Executive Vice President, Western Canada
604.616.0013 ext. 353 | C: 604.992.4200
ljacobson@thebehargroup.com

CHELAN KUJUNDZIC

Western Canada, Commercial Sales & Leasing
604.616.0013 ext. 358 | C: 778.317.7477
chelan@thebehargroup.com



LANDLORD
SERVICES

TENANT
SERVICES

CAPITAL
MARKETS

ADVISORY
SERVICES

Vancouver Office (Mailing Address)

1110 Hamilton Street, Unit 206, Vancouver, BC, V6B 2S2
Tel: 604.616.0013

Downtown Toronto Office

30 Duncan Street, Suite 201, Toronto, ON M5V 2A3

North York Office

1170 Sheppard Avenue West, Unit 24, Toronto, ON M3K 2A3
Tel: 416.636.8898 Fax: 416.636.8890

Calgary Office

639 5th Ave SW, Suite 2500, Calgary, AB T2P 0M9

The Behar Group Realty Inc., Brokerage
www.TheBeharGroup.com

DISCLAIMER & DISCLOSURE - IMPORTANT INFORMATION - PLEASE READ

Brokerage Duties and Representation Disclosure: The Real Estate Council of Ontario (RECO) regulates real estate professionals in Ontario. RECO's mandate is to protect the public interest by promoting a safe and informed marketplace and administering the rules that real estate agents and brokerages must follow.

As of December 1, 2023, new legislation has come into effect (TRESA -phase 2). These changes affect how you interact with real estate agents and brokerages.

Please read the Information guide published by RECO. Click here: [RECO Information Guide](#)

If you are represented by another Brokerage under a Tenant or Buyer Representation Agreement (Brokerage or Designated), please have your Designated Representative contact us on your behalf. This marketing material is not intended to solicit clients who are represented by another brokerage or Designated Representative. If you are not represented by another brokerage or another Designated Representative, and wish to hire brokerage representation, please contact us for details on our Landlord, Tenant, Advisory and Capital Markets Services.

This property is a Listing of The Behar Group Realty Inc. ("TBG") and the Designated Representative(s) named on these materials. The Landlord/Seller is our client to whom the Designated Representative(s) owes Fiduciary Duties.

Unless you are also a Client of TBG (and you consent to Multiple Representation), then you are a Self Represented Party (SRP). It is important that you understand and acknowledge the risks and role as a SRP. Please read the RECO Information Guide, and before asking for assistance from the Designated Representative listed on this flyer be prepared to sign and acknowledge the RECO Information and Disclosure form for Self Represented Parties: [Click Here](#).

TBG strongly recommends that consumers retain the services of a qualified and experienced real estate agent.

For all transactions completed with TBG, you will be required to sign a Confirmation of Cooperation and Representation Agreement, whether you are a SRP or not, to ensure acknowledgment of representation disclosure.

Photo/Renderings Disclosure: Any photos used in these materials may have been digitally manipulated for illustrative purposes, and the actual property's appearance may differ; please verify details independently. Any property renderings used are artistic concepts only and may not reflect the final build of the project.

Errors and Omissions Disclosure: All information is from sources deemed reliable and is subject to errors and omissions which we believe to be correct and assume no responsibility. Changes in respect of price, rental, prior sale and withdrawal may be changed without notice. None of the information contained herein is intended to be construed as legal or tax or other professional advice. You should consult your legal counsel, accountant, planner/architect/engineer or other advisors as necessary on matters relating to these materials.