

FOR SALE OR LEASE

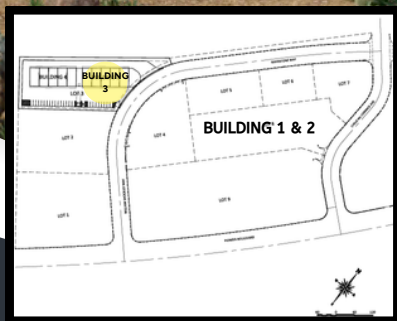

RIVERSTONE COMMERCE PARK BUILDING 3: 5 UNITS

STARTING
AT

\$365,000
LEASE \$13 SQFT/YEAR

TYPE

LIGHT INDUSTRIAL

SIZE

1,800-2,100
SQ/FT

BUILT IN

2025



DRIVE THRU BAY DOORS
14 X 14 FRONT/12 X 12 REAR



30' X 60' WITH ADA
BATHROOM



BUILDINGS 1 & 2



MEZZANINE UNIT 2,100 SQ
FT

UNIT OVERVIEW

BUILDING 3 TO BE STARTED IN DECEMBER OF 2024. 5 INSULATED AND CLIMATE CONTROLLED UNITS, WITH ADA BATHROOMS, TWO MAN DOORS, 2 BAY DOORS FRONT & REAR, 3 PHASE POWER, 50 AMP RV PLUG, RV CLEANOUT, INTERIOR HOSE BIB, LED LIGHTING, 7' CEILING FANS, WATER HEATER AND MORE. CALL FOR FULL DETAILS

5%+ CAP RATE
GREAT LOCATION
PAVED PARKING
HIGHLY DESIRABLE RENTAL

691 William Shockley Way
Mesquite, NV 89027

CONTACT US



702-377-1080



JOESBIGLEY@GMAIL.COM