

Pointe 70

3300 Rider Trail South | Earth City, MO 63045

Premier Class A
Office Building
in Earth City

[View Availabilities](#)



Colliers

Property Highlights

- ◇ Renovated lobby
- ◇ Outdoor balconies on select floors
- ◇ Abundant surface parking with dedicated parking garage
- ◇ Excellent visibility to Highway 70
- ◇ Located in Earth City Business Park
- ◇ In close proximity to local amenities with easy access to Highway 70

Space Highlights

- ◇ 3,768 SF - 8,772 SF available
- ◇ Located on the first floor with lobby visibility
- ◇ Expansive glass line
- ◇ Space can be demised

Lease Rate: **\$21.50/SF, Full Service**



Floor Plan

Suite 100
±8,772 SF

[▶ Take a Virtual Tour](#)

Suite 110
±3,768 SF

[▶ Take a Virtual Tour](#)

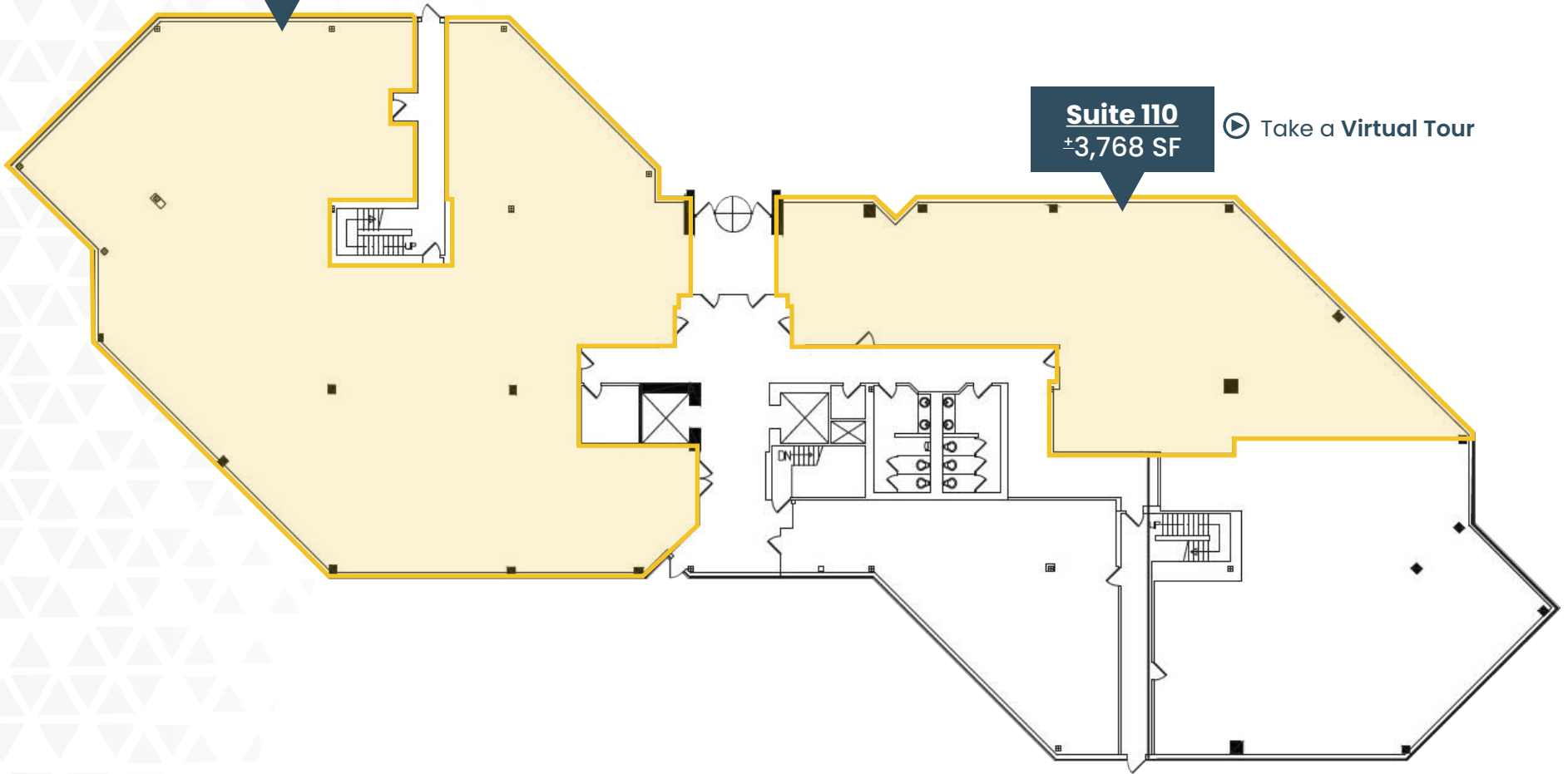

Location

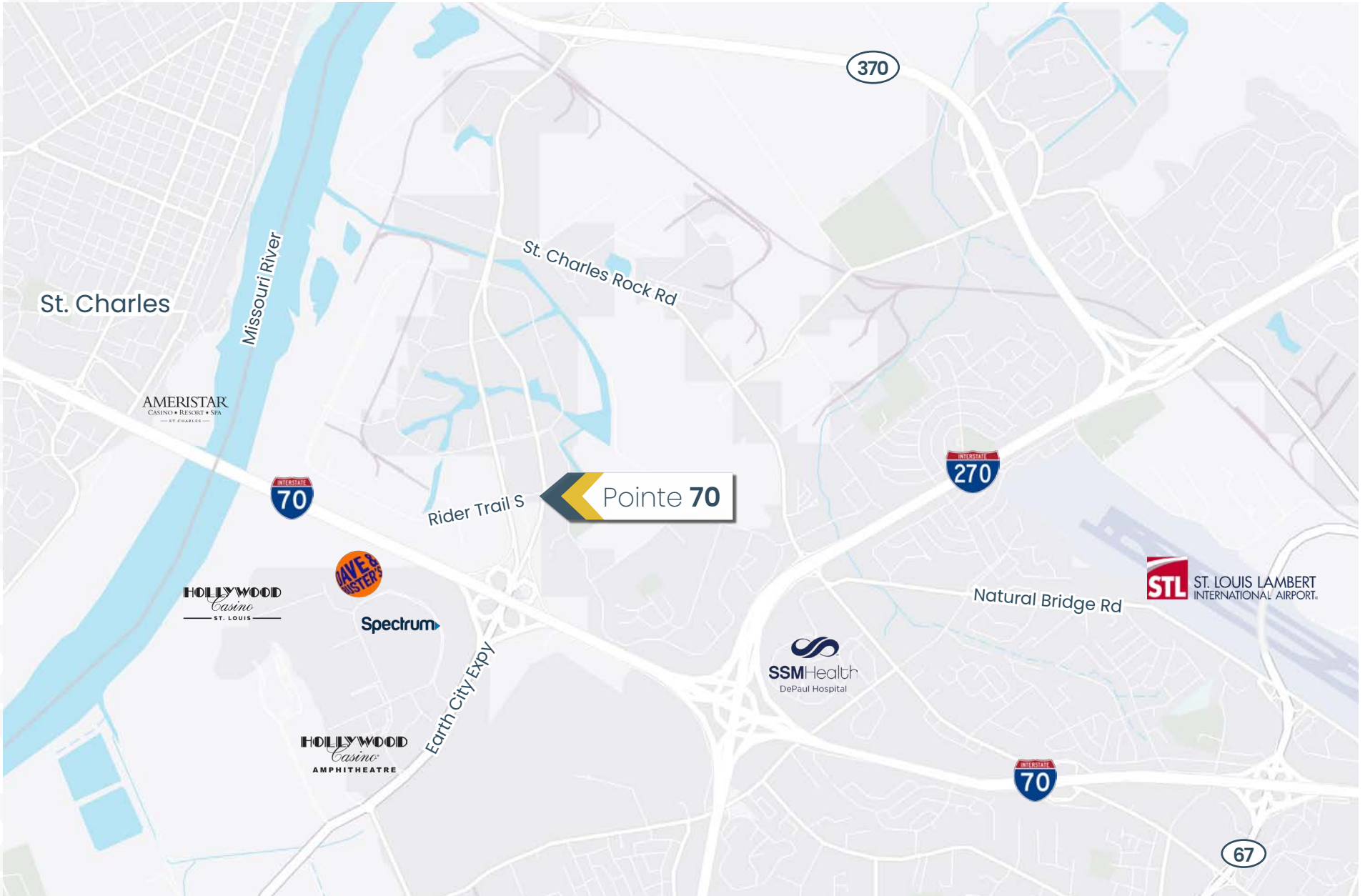

Pointe 70

3300 Rider Trail South | Earth City, MO 63045

 View Availabilities

CREDITCONTROL

For further information, please contact:

Carrie Herrmann
Senior Vice President
+1 314 584 6273
carrie.herrmann@colliers.com

W. Rockwell (Rocky) Stenger
Senior Vice President
+1 314 584 6208
william.stenger@colliers.com

101 S. Hanley Road
Suite 1400
Clayton, MO 63105
+1 314 863 4447
colliers.com/stlouis



This document/email has been prepared by Colliers for advertising and general information only. Colliers makes no guarantees, representations or warranties of any kind, expressed or implied, regarding the information including, but not limited to, warranties of content, accuracy and reliability. Any interested party should undertake their own inquiries as to the accuracy of the information. Colliers excludes unequivocally all inferred or implied terms, conditions and warranties arising out of this document and excludes all liability for loss and damages arising there from. This publication is the copyrighted property of Colliers and /or its licensor(s). © 2023. All rights reserved. This communication is not intended to cause or induce breach of an existing listing agreement. [