

FOR SALE OR LEASE

1030 S 86TH STREET | TAMPA, FL 33619

JULIA SILVA, SIOR 813.230.8008 | ERIKA THOMPSON, SIOR 813.215.4342
ED KILLMER 813.309.2805

LEE & ASSOCIATES
COMMERCIAL REAL ESTATE SERVICES

NEW OWNERS



LISTING DATA

AVAILABLE SF: 28,230

OFFICE SF: 4,000±

ACRES: 1.56

ZONED: Manufacturing

CONSTRUCTION: Block and Metal

CLEAR HEIGHT: 16'8" - 19'5"

POWER: 3-Phase, 1,200 AMPS, 480v

LOADING: 1 | Dock Well with Pit Leveler
2 | Oversized Grade-Level Doors

PRIME VISIBILITY ON THE SELMON EXPRESSWAY



All information furnished regarding property for sale, rental or financing is from sources deemed reliable, but no warranty or representation is made to the accuracy thereof and same is submitted to errors, omissions, change of price, rental or other conditions prior to sale, lease or financing or withdrawal without notice. No liability of any kind is to be imposed on the broker herein.

Julia Silva, SIOR
jsilva@lee-associates.com
D 813.230.8008

Erika Thompson, SIOR
ethompson@lee-associates.com
D 813.215.4342

Ed Killmer
ekillmer@lee-associates.com
D 813.309.2805

lee-associates.com
1646 West Snow Ave. Suite 6
Tampa FL 33606



FOR SALE OR LEASE

1030 S 86TH STREET | TAMPA, FL 33619

JULIA SILVA, SIOR 813.230.8008 | ERIKA THOMPSON, SIOR 813.215.4342
ED KILLMER 813.309.2805

LEE & ASSOCIATES

COMMERCIAL REAL ESTATE SERVICES

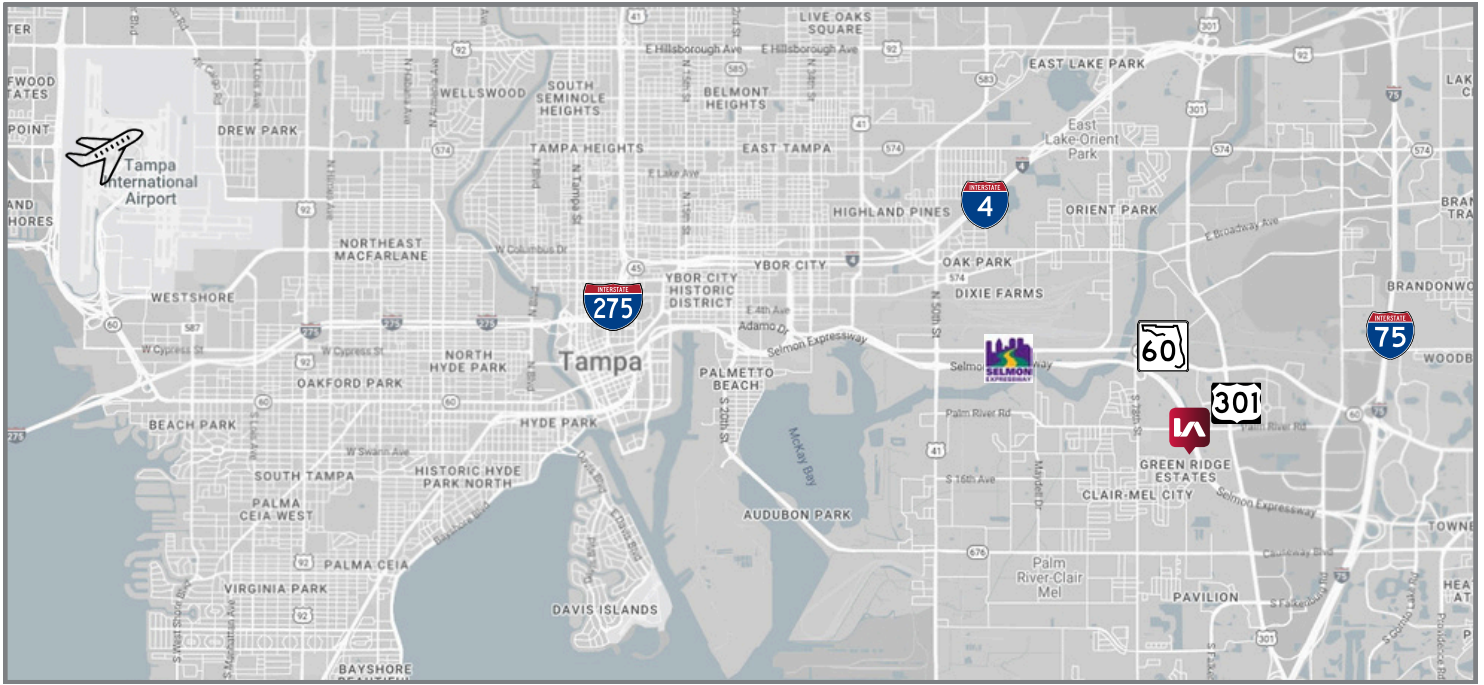

DISTANCES

-  0.5 miles
-  1.3 miles
-  1.4 miles
-  2 miles
-  4.3 miles
-  5.1 miles
-  7.1 miles
-  13.6 miles

28,230 SF Single Story Building



All information furnished regarding property for sale, rental or financing is from sources deemed reliable, but no warranty or representation is made to the accuracy thereof and same is submitted to errors, omissions, change of price, rental or other conditions prior to sale, lease or financing or withdrawal without notice. No liability of any kind is to be imposed on the broker herein.

Julia Silva, SIOR
jsilva@lee-associates.com
D 813.230.8008

Erika Thompson, SIOR
ethompson@lee-associates.com
D 813.215.4342

Ed Killmer
ekillmer@lee-associates.com
D 813.309.2805

lee-associates.com
1646 West Snow Ave. Suite 6
Tampa FL 33606



FOR SALE OR LEASE

1030 S 86TH STREET | TAMPA, FL 33619

JULIA SILVA, SIOR 813.230.8008 | ERIKA THOMPSON, SIOR 813.215.4342
ED KILLMER 813.309.2805

LEE & ASSOCIATES

COMMERCIAL REAL ESTATE SERVICES



TRUCK LOADING DOOR: 12' x 10'

DRIVE IN DOOR WITH RAMP: 14' x 16'

DRIVE IN DOOR: 12' x 16'

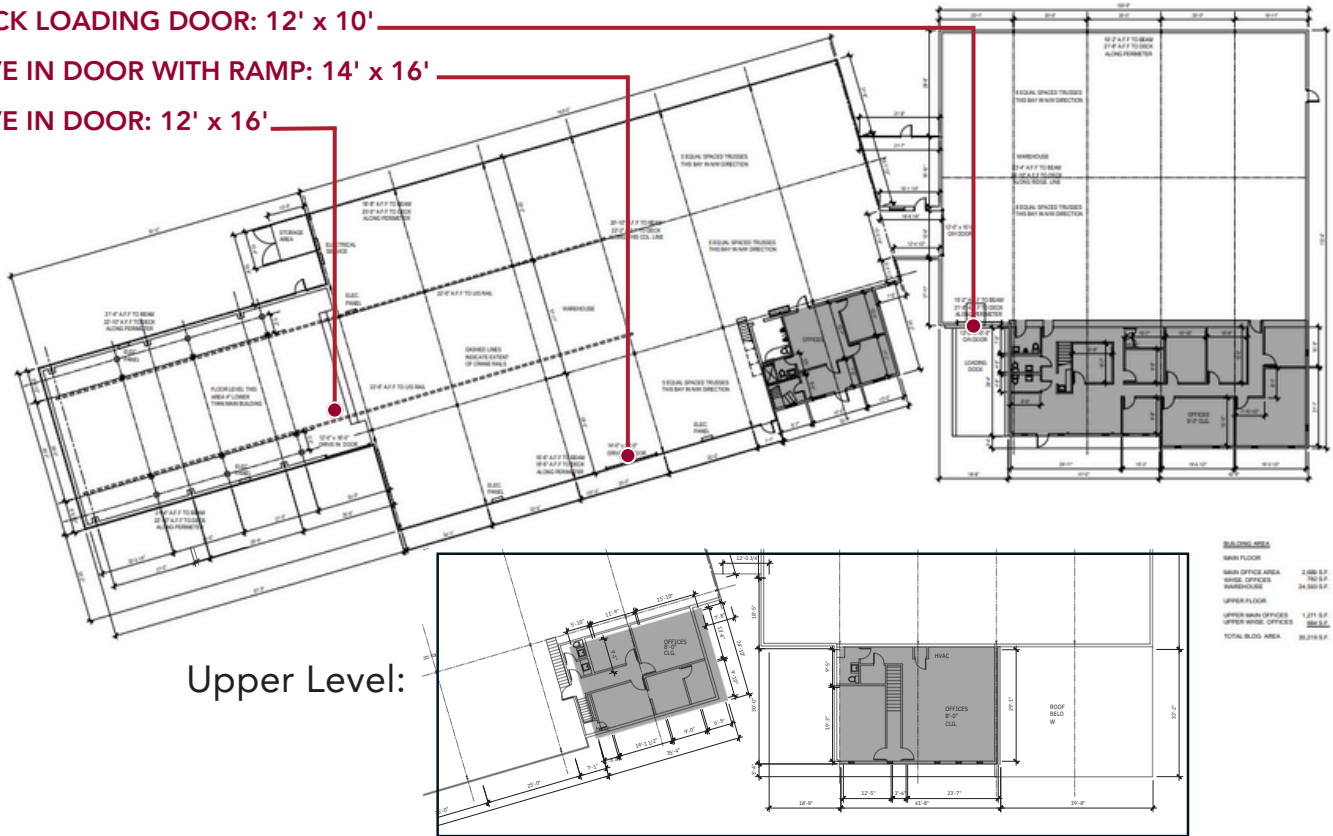

SELMON EXPRESSWAY

Julia Silva, SIOR
jsilva@lee-associates.com
D 813.230.8008

Erika Thompson, SIOR
ethompson@lee-associates.com
D 813.215.4342

Ed Killmer
ekillmer@lee-associates.com
D 813.309.2805

lee-associates.com
1646 West Snow Ave. Suite 6
Tampa FL 33606



FOR SALE OR LEASE

1030 S 86TH STREET | TAMPA, FL 33619

JULIA SILVA, SIOR 813.230.8008 | ERIKA THOMPSON, SIOR 813.215.4342
ED KILLMER 813.309.2805

CONSTRUCTION IMPROVEMENTS

DEMO & CLEANING

AREA #1 OFFICE

- Demo Existing Interior Spaces as Highlighted per Plan
- Modify MEPFP in Demo'd Spaces
- Patch & Repair Demo Scars at Drywall Locations
- Patch & Repair Demo Scars at Existing Concrete Slab
- Remove Existing Light Fixtures
- Remove Flooring
- Remove Signage in Upstairs Conference Room Ceiling
- Remove Unused Wires in Data Room
- Repair Misc CMU in Warehouse & Repair Concrete at Demo Location

WAREHOUSE

- Remove Elevator Lift
- Remove Existing Crane & Crane Structure (Include Removal of Footings)
- Remove Exhaust / Ventilation Pipes at Paint Booth Location
- Remove Old Fan Unit above Door on East side of Warehouse
- Remove Ladder on East Side of Warehouse
- Remove Flooring
- Modify MEPFP in Demo'd Spaces Relocating Existing Transformer
- Patch & Repair Demo Scars at Drywall Locations Patch & Repair
- Demo Scars at Existing Concrete Slab Remove Existing Light Fixtures
- Remove Abandoned Electrical Conduit / Wires

STRUCTURAL STEEL

- Repair Exterior Metal Siding & Down Spouts as Required prior to Painting

DFH

- Replace Door Hardware & Lock into Kitchen Area #2

ELECTRICAL

- Modify Fire Alarm System as Required
- Install New LED Light Fixtures

HVAC

- Replace Split Systems & Ductless Systems

PLUMBING

- Replace Non-ADA Compliant Vanities / Sinks
- Reinstall Toilets to ensure ADA Compliant
- Replace Area #2 Toilet in Upper Office

SANITARY

- Furnish & Install Sanitary Sewer Line - Connect to Existing Lift Station
- Patch at Sanitary Line

THERMAL INSULATION

- Replace Damaged Ceiling Tiles
- Patch Damaged Insulation

FLOORING

- Furnish & Install New LVT and Vinyl Base in Miscellaneous Rooms

PAINTING

- Paint Interior & Exterior - High Reflective White
- Paint Interior and Exterior Doors & Frames

All information furnished regarding property for sale, rental or financing is from sources deemed reliable, but no warranty or representation is made to the accuracy thereof and same is submitted to errors, omissions, change of price, rental or other conditions prior to sale, lease or financing or withdrawal without notice. No liability of any kind is to be imposed on the broker herein.

