

Office / Medical Space Walk to Princeton Junction Train Station

Available for Lease:

- Suite 4B: 1,338 SF
- Suite 7A: 1,575 SF
- Suite Entrance offers direct access to/from parking lot
- Bldg Complex: 27,773 SF
- Operable Windows, Separate Mechanical Systems
- Parking: 110 Spaces
- Zoning: ROM4
- Walking distance to restaurants
- Located in the heart of Princeton Jct., NJ; Mercer Co.
- 15 min. from Princeton
- Close to Routes 1, 130.

Lease Rate: \$24.00/SF plus Utilities

For more information:
Gerard Fennelly

For Lease

2,913 SF

Office / Medical Space

West Windsor, NJ 08550



Suite 4B: 1,338 SF

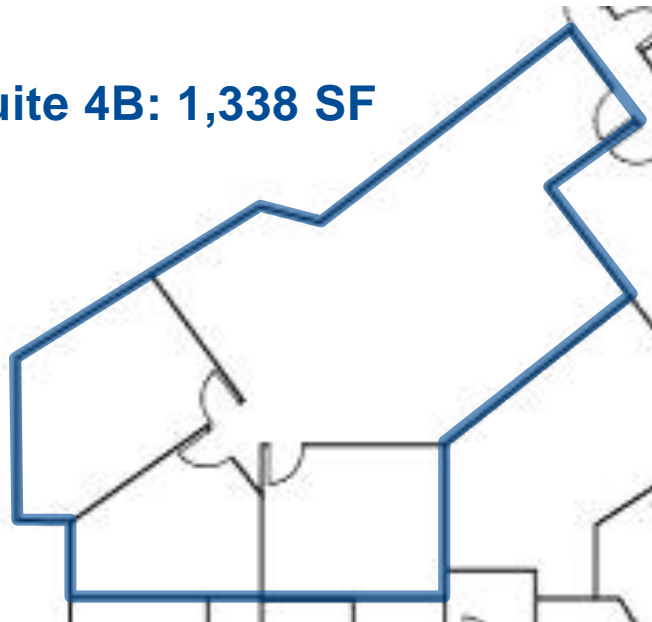

For Lease
2,913 SF
Office / Medical Space

231 Clarksville Road
West Windsor, NJ 08550

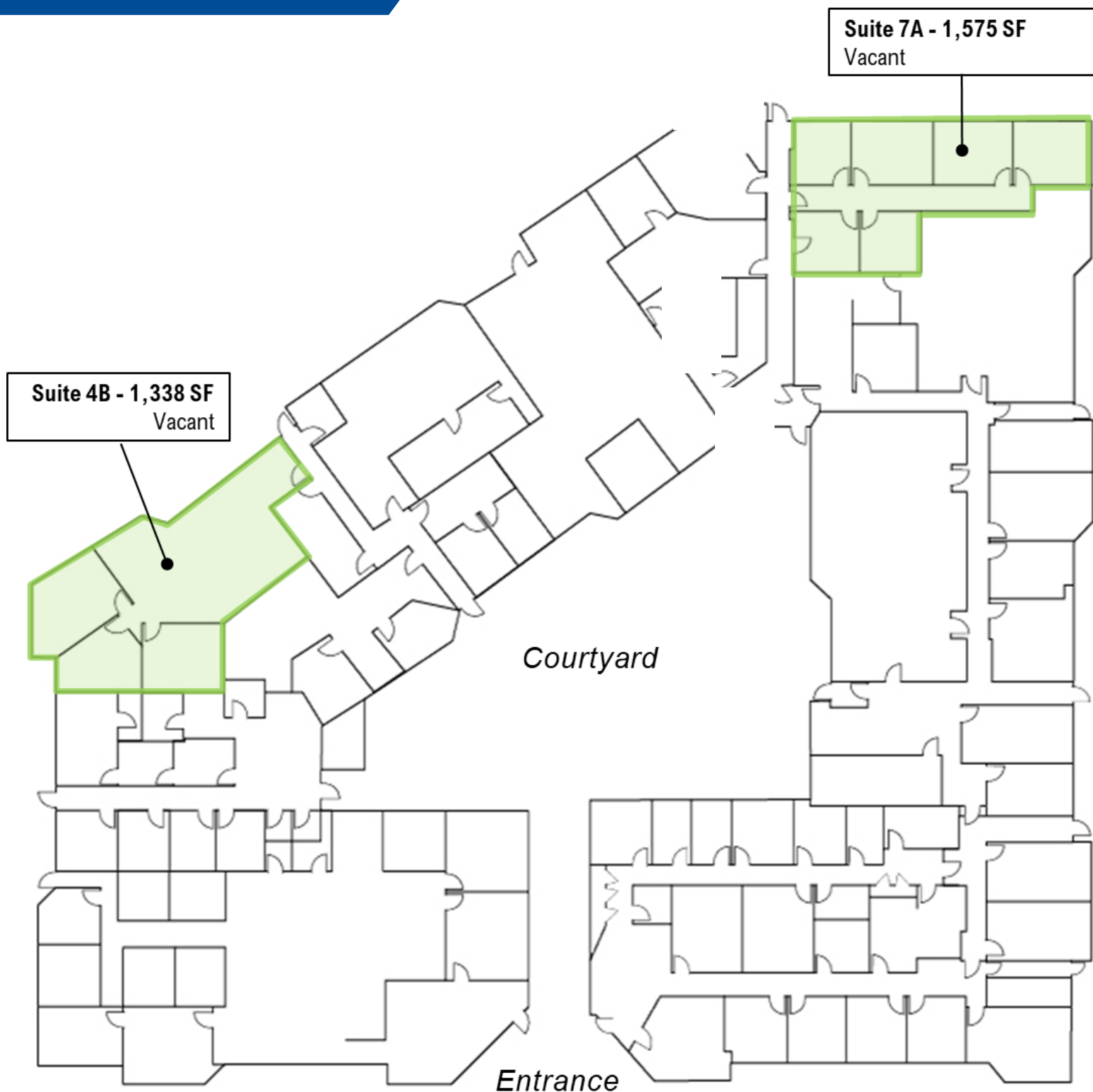

For Lease
2,913 SF
Office / Medical Space

231 Clarksville Road
West Windsor, NJ 08550

