

FOR SUBLEASE

900 CHELMSFORD STREET, LOWELL, MA (TOWER 3)



FLOOR PLAN

4TH FLOOR | 9,618 SF

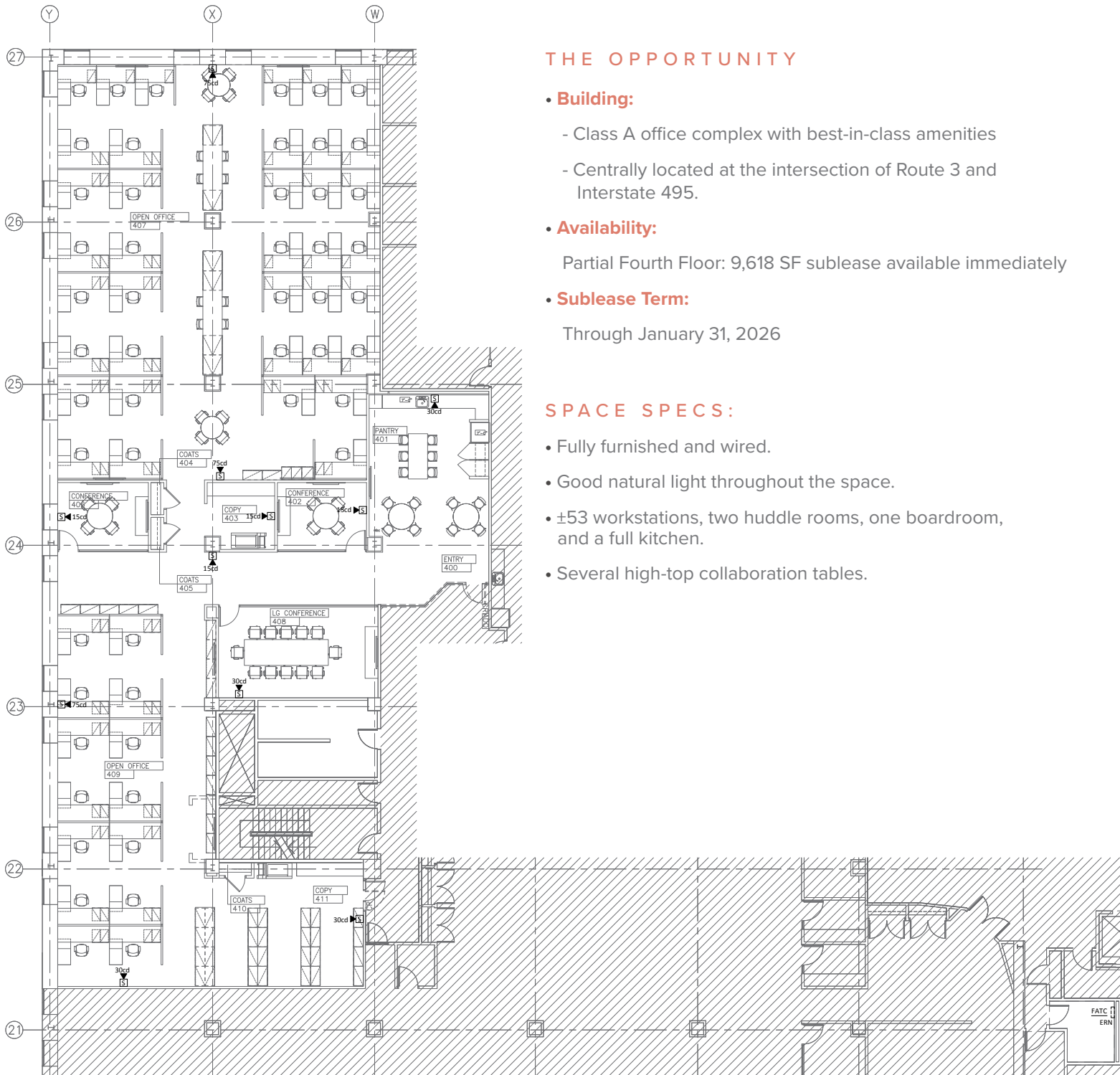

THE OPPORTUNITY

• Building:

- Class A office complex with best-in-class amenities
- Centrally located at the intersection of Route 3 and Interstate 495.

• Availability:

Partial Fourth Floor: 9,618 SF sublease available immediately

• Sublease Term:

Through January 31, 2026

SPACE SPECS:

- Fully furnished and wired.
- Good natural light throughout the space.
- ±53 workstations, two huddle rooms, one boardroom, and a full kitchen.
- Several high-top collaboration tables.

ON-SITE AMENITIES

Full-service cafeteria, fitness center with shockers/lockers, conference space with a large auditorium, covered parking, Tavern in the Square, Little Sprouts Early Education & Child Care



900 CHELMSFORD STREET, LOWELL, MA (TOWER 3)



PLEASE CONTACT:

John Wilson

Executive Vice President

+1 617 439 7811

john.wilson15@cbre.com

Christian Vallis

Associate

+1 617 912 6937

christian.vallis@cbre.com

© 2023 CBRE, Inc. This information has been obtained from sources believed reliable. We have not verified it and make no guarantee, warranty or representation about it. Any projections, opinions, assumptions or estimates used are for example only and do not represent the current or future performance of the property. You and your advisors should conduct a careful, independent investigation of the property to determine to your satisfaction the suitability of the property for your needs. Photos herein are the property of their respective owners and use of these images without the express written consent of the owner is prohibited.