

FOR LEASE

20,052 SQUARE FEET

5900 TRIUMPH STREET, CITY OF COMMERCE, CA



BUILDING FEATURES

One-Story, Dock High Concrete Tilt-up Building

Office: ±2,000 SF Air-Conditioned Office Area

Sprinklers: Yes

Loading: 4 Dock High, Ground Level Ramp

Clearance: 14' to 20'

Parking: 35 Auto

Power: 400 Amps, 277/480 V, 3 Phase

**Near Santa Ana Freeway (I-5) and Washington Blvd.
On/Off ramps.**

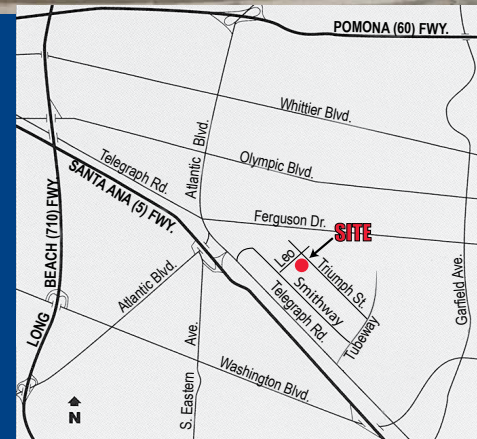

For further information, contact:

Mike Roski

R.E. License #000853255 (CA)

562.948.4337

mroski@majesticrealty.com

FOR LEASE

20,052 SQUARE FEET

5900 TRIUMPH STREET, CITY OF COMMERCE, CA

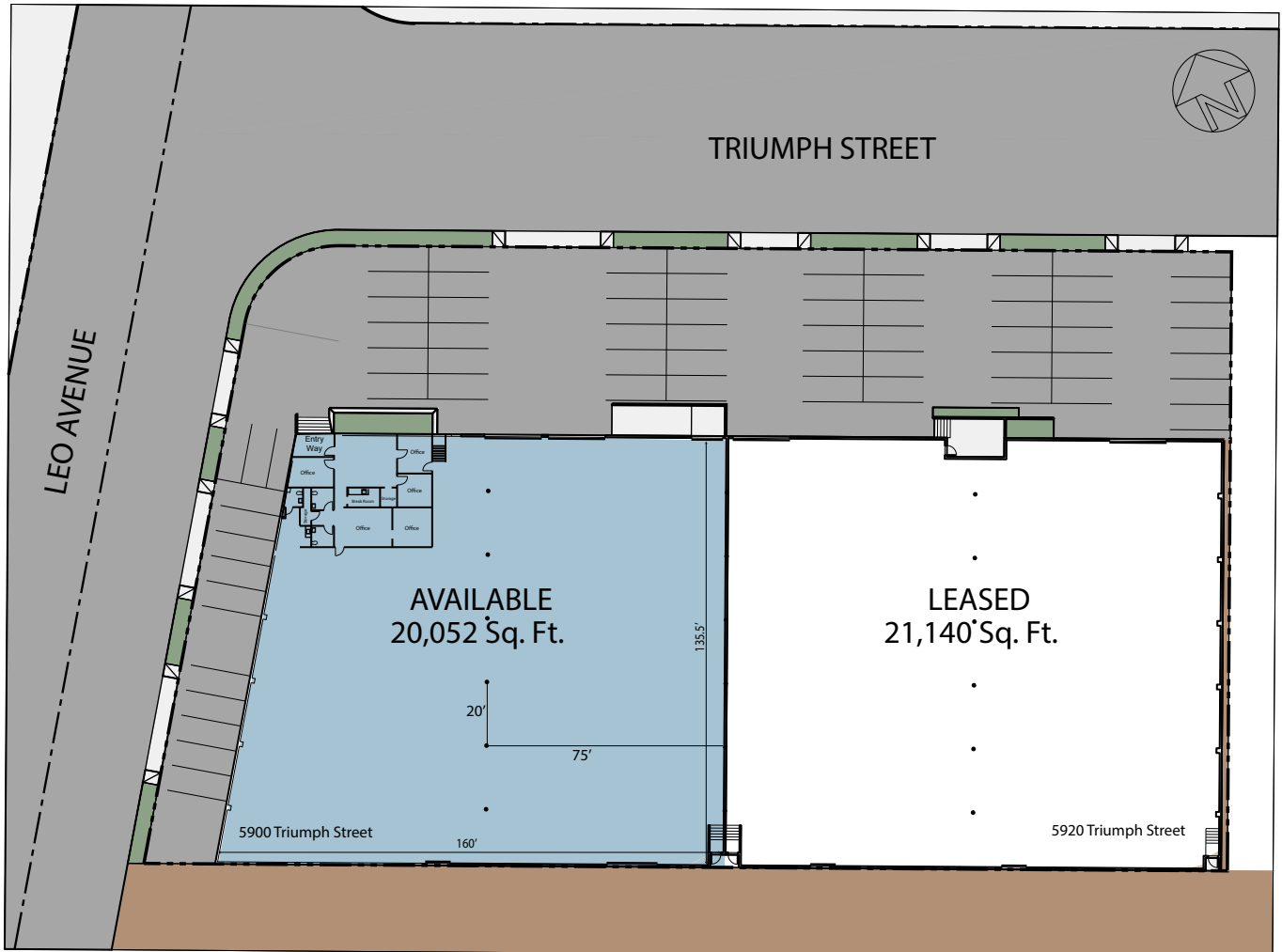

For further information, contact:

Mike Roski

R.E. License #000853255 (CA)

562.948.4337

mroski@majesticrealty.com

MajesticRealty.com | 13191 Crossroads Parkway North • Sixth Floor • City of Industry, CA 91746-3497 • Phone: 562.692.9581

This statement is based upon information which we believe to be correct and is obtained from sources we regard as reliable but we assume no liability for errors or omissions therein.