









PUEBLO INDUSTRIAL CAMPUS

907 N. Erie Avenue
Pueblo, CO 81001

PROPERTY SPECIFICATIONS

 LOCATION:	907 N. Erie Ave. Pueblo, CO 81001
 AVAILABLE SPACE:	±5,500 SF
 LEASE RATE:	\$10.00 PSF, NNN
NNN:	\$3.00 PSF
 LOT SIZE:	5.2 Acres of shared lot

-  **INCLUDES:**
- ±14' drive-in doors
 - Outside storage
 - Office/warehouse configuration
 - Additional outside storage available on 9th Street
 - Electrical: 220V (20A-40A) and 110V (20A) circuits

 [Property Overview](#)



JASON CASTRO
President

 jason@peakcp.net
719.227.9987 ext. 2



 2727 N. Cascade Avenue,
Suite 127, Colorado Springs, CO 80907

 719.227.9987

 www.peakcp.net

Peak Commercial Properties believes information contained herein, while not guaranteed, is from sources they believe reliable. Price, terms, and information are subject to change without notice.

PUEBLO INDUSTRIAL CAMPUS

907 N. Erie Ave.
Pueblo, CO 81001

907 N Erie Ave

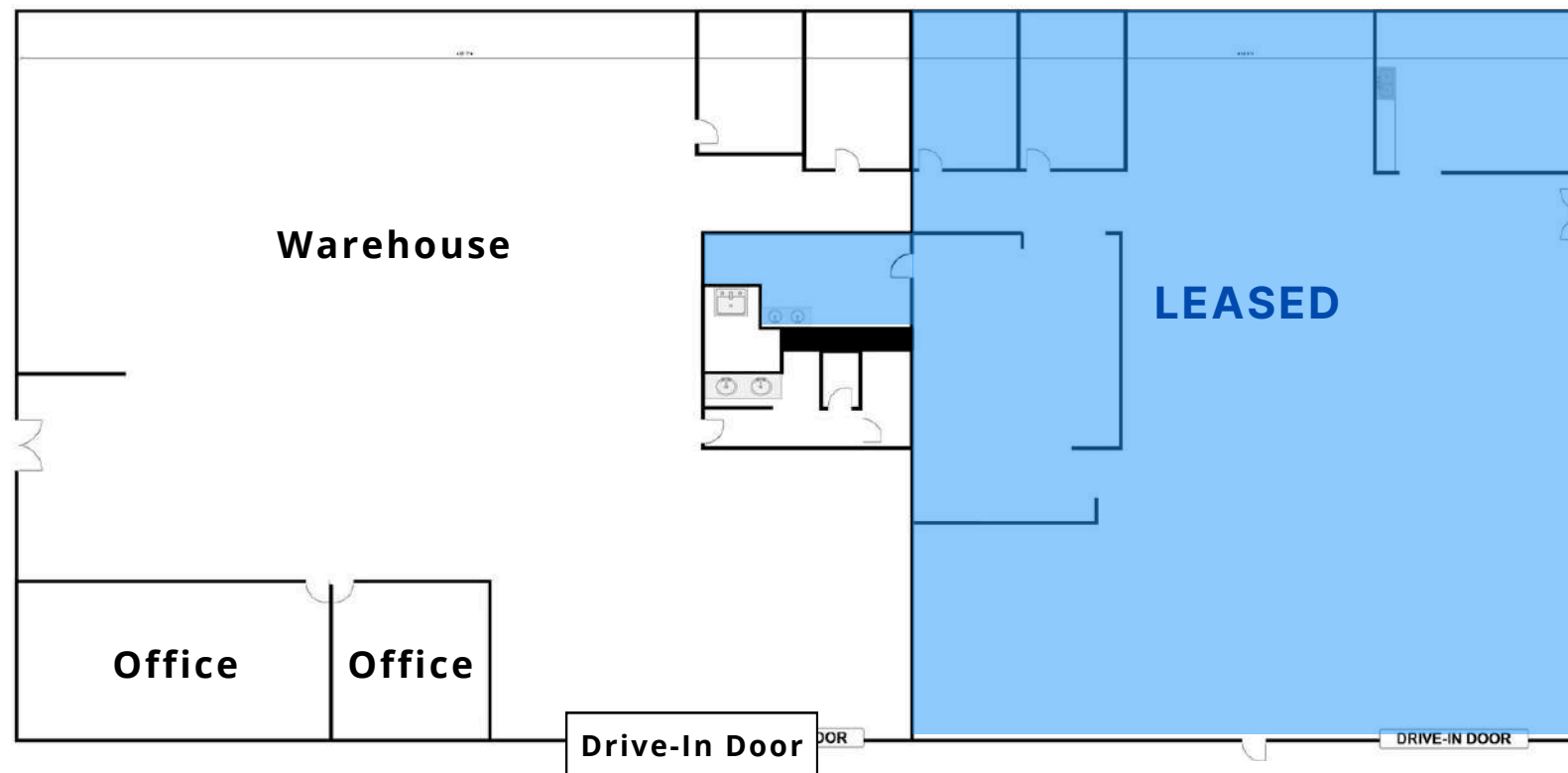

Sizes and dimensions are approximate. Actual dimensions may vary.



2727 N. Cascade Avenue,
Suite 127, Colorado Springs, CO 80907

719.227.9987

www.peakcp.net

Peak Commercial Properties believes information contained herein, while not guaranteed, is from sources they believe reliable. Price, terms, and information are subject to change without notice.

Additional Storage
9th St



2727 N. Cascade Avenue,
Suite 127, Colorado Springs, CO 80907

719.227.9987

www.peakcp.net

Peak Commercial Properties believes information contained herein, while not guaranteed, is from sources they believe reliable. Price, terms, and information are subject to change without notice.