

# FLOORPLAN SKETCH

Borrower:	File No.: dMeisenhowerCOMM326
Property Address: 3320 W. Eisenhower Blvd.	Case No.:
City: Loveland	State: Colorado
Lender:	Zip: 80537

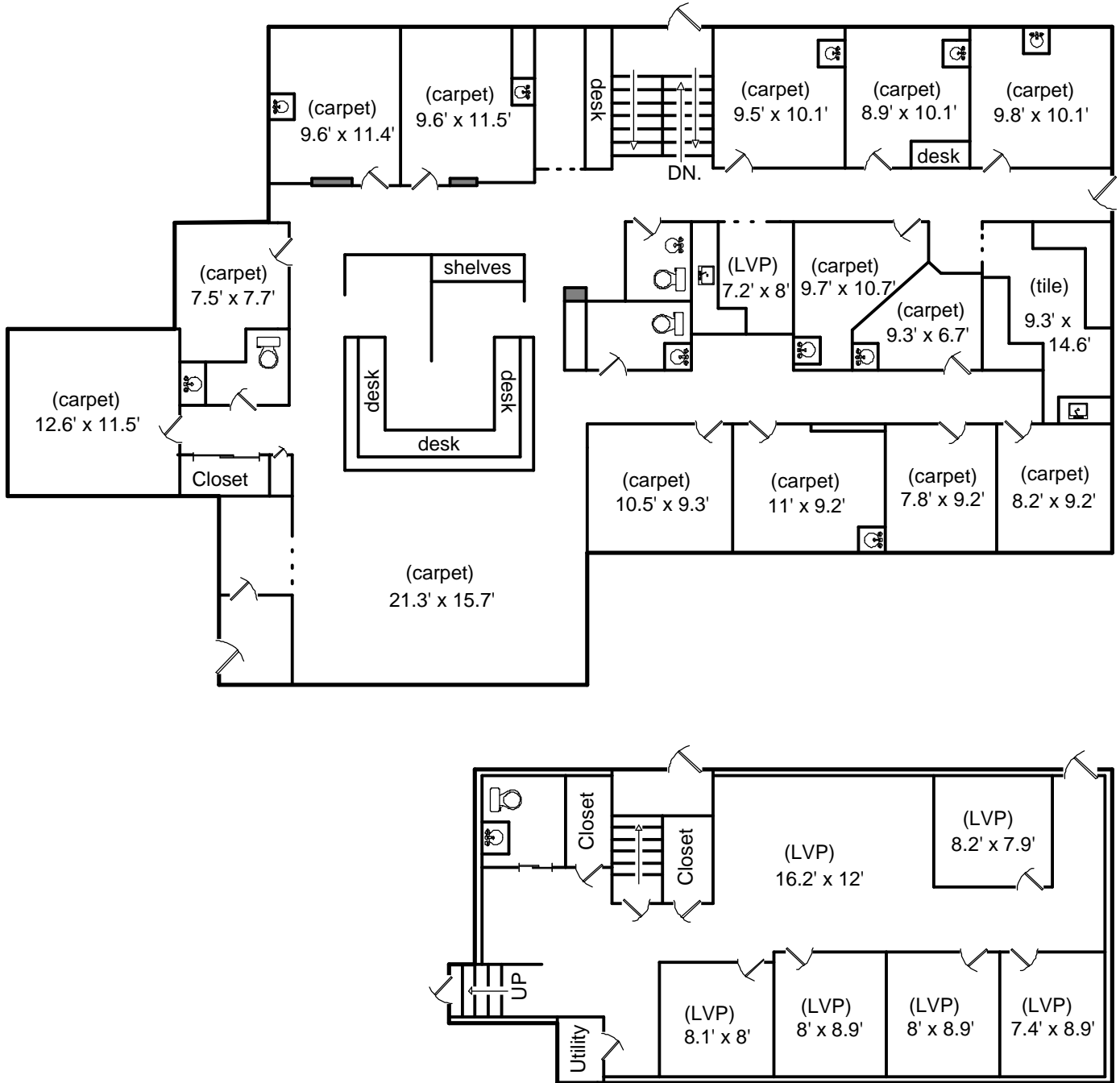

<b>3320 W. Eisenhower Blvd.</b> Loveland, Colorado
Main Level SF: 3,121 Basement SF: 1,119 Total SF (all levels): 4,240 Total Finished SF: 4,240

\*Scope of work is defined and included with this sketch\*

Drew Seaser (970) 214.3413  
17march26

March 17, 2026

Mark Bishop  
The Group, Inc. - Harmony  
2803 E. Harmony Rd.  
Fort Collins, Colorado 80528

File Number: dMeisenhowerCOMM326

Dear Mark,

In accordance with your request, I have measured the following home and provided a sketch of the floorplan and included room dimensions. Square footage is taken from outside measurements as per ANSI (American National Standards Institute) guidelines, which are the guidelines to which HUD refers. The only exception is below grade finished areas; in this case we follow local custom, which is to include the garden level in tri-levels in finished above grade square footage. Homes where outside measurements are inaccessible, inside measurements are used and an additional .5' is added for the outside wall. In rooms with sloping ceilings, the area measured is from where the ceiling is at least 5' high. In rooms that are not square or rectangular, measurements are taken from the longest points in most cases. (cont. below)

3320 W. Eisenhower Blvd.  
Loveland, Colorado 80537

(cont.) Room sizes may be rounded to the nearest .5'. Bedrooms are measured excluding closets. Kitchens are measured wall-to-wall and include the nook, if applicable. The square footage totals on the attached floorplan are estimations and should not be relied upon for any purpose other than marketing the property stated above. All measurements are believed to be accurate, but it is not uncommon for two different professionals to come up with different figures. The attached floorplan is meant to show a general layout of the home and does not account for the thickness of walls or some other architectural features.

Drew Seaser, Owner/Certified Residential Appraiser  
TOOL REAL ESTATE APPRAISALS  
1049 W. 45th St.  
Loveland, Colorado 80538

SCOPE OF WORK IS STATED IN BODY OF ABOVE LETTER.