

FOR LEASE RESTAURANT W/ DRIVE-THRU

2,264 SF w/ DRIVE-THRU | EXCELLENT TRAFFIC COUNTS



2835 Washtenaw Avenue | Ypsilanti, MI 48197

Encore Real Estate Investment Services | 6755 Daly Road, West Bloomfield, MI 48322 | encorereis.com

CONFIDENTIALITY AND DISCLAIMER

All materials and information received or derived from Encore Real Estate Investment Services, LLC its directors, officers, agents, advisors, affiliates and/or any third party sources are provided without representation or warranty as to completeness, veracity, or accuracy, condition of the property, compliance or lack of compliance with applicable governmental requirements, developability or suitability, financial performance of the property, projected financial performance of the property for any party's intended use or any and all other matters.

Neither Encore Real Estate Investment Services, LLC its directors, officers, agents, advisors, or affiliates makes any representation or warranty, express or implied, as to accuracy or completeness of the any materials or information provided, derived, or received. Materials and information from any source, whether written or verbal, that may be furnished for review are not a substitute for a party's active conduct of its own due diligence to determine these and other matters of significance to such party. Encore Real Estate Investment Services, LLC will not investigate or verify any such matters or conduct due diligence for a party unless otherwise agreed in writing.

EACH PARTY SHALL CONDUCT ITS OWN INDEPENDENT INVESTIGATION AND DUE DILIGENCE.

Any party contemplating or under contract or in escrow for a transaction is urged to verify all information and to conduct their own inspections and investigations including through appropriate third party independent professionals selected by such party. All financial data should be verified by the party including by obtaining and reading applicable documents and reports and consulting appropriate independent professionals. Encore Real Estate Investment Services, LLC makes no warranties and/or representations regarding the veracity, completeness, or relevance of any financial data or assumptions. Encore Real Estate Investment Services, LLC does not serve as a financial advisor to any party regarding any proposed transaction. All data and assumptions regarding financial performance, including that used for financial modeling purposes, may differ from actual data or performance. Any estimates of market rents and/or projected rents that may be provided to a party do not necessarily mean that rents can be established at or increased to that level. Parties must evaluate any applicable contractual and governmental limitations as well as market conditions, vacancy factors and other issues in order to determine rents from or for the property.

Legal questions should be discussed by the party with an attorney. Tax questions should be discussed by the party with a certified public accountant or tax attorney. Title questions should be discussed by the party with a title officer or attorney. Questions regarding the condition of the property and whether the property complies with applicable governmental requirements should be discussed by the party with appropriate engineers, architects, contractors, other consultants and governmental agencies. All properties and services are marketed by Encore Real Estate Investment Services, LLC in compliance with all applicable fair housing and equal opportunity laws.

TABLE OF CONTENTS

EXCLUSIVELY LISTED BY:

DANTE HARGIS

Senior Director

248.702.0289

dhargis@encorereis.com

DENO BISTOLARIDES

Managing Partner

248.702.0288

denob@encorereis.com

CONFIDENTIALITY AND DISCLAIMER	2
EXECUTIVE SUMMARY	4
PROPERTY PHOTOS	5
PROPERTY PHOTOS	6
PROPERTY PHOTOS	7
BUILDING SKETCH	8
AERIAL	9
AERIAL	10
AERIAL	11
REGIONAL MAP	12
YPSILANTI, MI OVERVIEW	13
DEMOGRAPHICS MAP & REPORT	14

EXECUTIVE SUMMARY

CLICK ON THE FOLLOWING LINKS: [Google Map](#) [Street View](#)

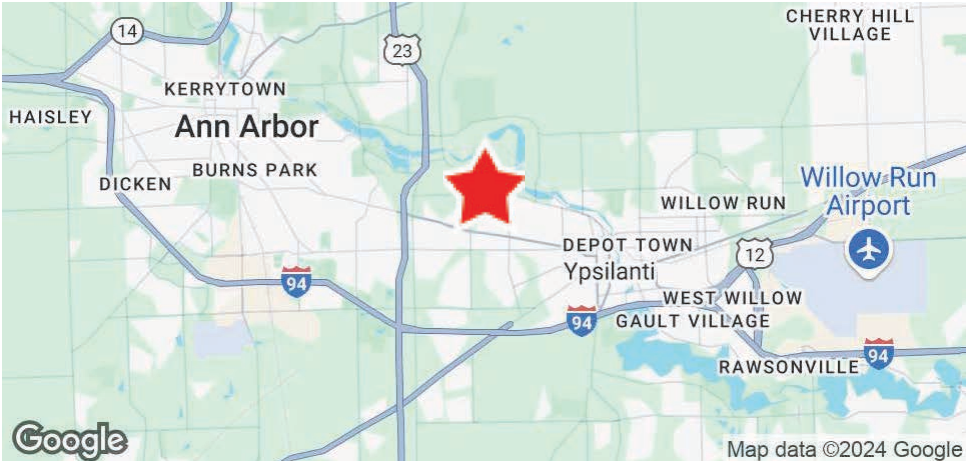

OFFERING SUMMARY

Lease Rate: Negotiable

Land Acreage: 0.66 Acres

Building Size: 2,264

Available SF: 2,264 SF

Property Taxes: EST \$17,075 Annually

PROPERTY HIGHLIGHTS

- FOR LEASE - 2,264 SF Freestanding Restaurant w/ Drive-Thru Situated on .66 Acres
- Equipped with Full 800+ SF Basement - Perfect for Additional Tenant Storage
- Prime Location On Washtenaw Ave 24,000+ VPD - High Visibility For Signage & Branding
- Property Benefits From Traffic Signal On Washtenaw Ave & Multiple Points of Ingress & Egress
- Drive Thru Equipped Site - Excellent for QSR and Food Tenants
- In Close Proximity to US 23 and the Area's Major Thoroughfares
- Located in a Burgeoning Retail Corridor and In Close Proximity to the "Who's Who" of Retail Tenants
- Ypsilanti Township Is Part of Ann Arbor, MI Metropolitan Area & Home To Eastern Michigan University 2023 Total Enrollment 13,000+ Students



PHOTOS



PHOTOS





BUILDING SKETCH

Asphalt Paving: 18,600 sf
 4" Concrete: 1,170 sf
 Light Poles: 1- 15' Ht
 Lights: 12, Including on Bld

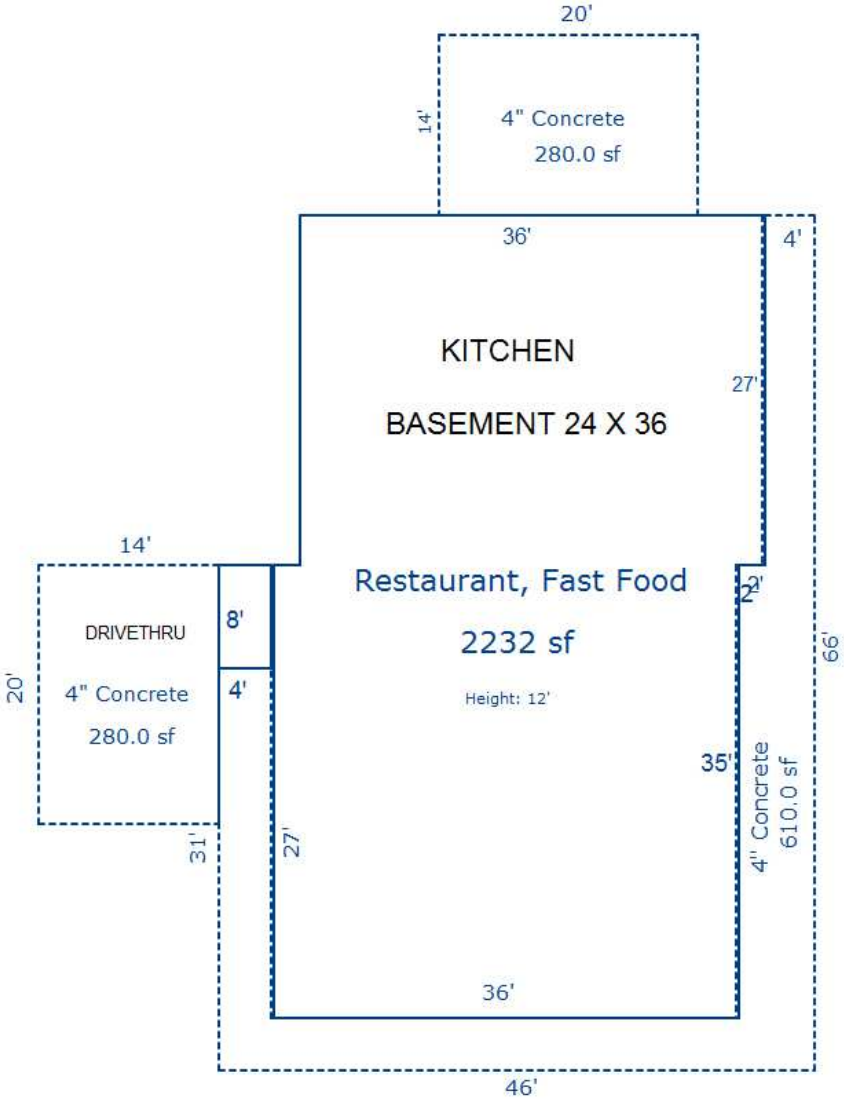

Washtenaw Avenue

AERIAL



Hua Xing Asia Market
華興超市



Washtenaw Ave 24,300 VPD



Fountain Square Shopping Center



AERIAL

Golfview Manor Apartments

Gulfside Apartments



Washtenaw Ave 24,300 VPD



YPBOR F.M Restaurant

Fountain Square Shopping Center



planet fitness

Save a lot



BIG LOTS!

DOLLAR TREE

Stadium Meadows Apartments

Camelot Apartments



Aspen Chase Apartments



EASTERN
MICHIGAN UNIVERSITY



Trinity Health

Ann Arbor Hospital
560 Bed Hospital
340-Acre Campus



EASTERN
MICHIGAN UNIVERSITY

1.5 MILES

1 MILE

1.4 MILES

1 MILE



Washtenaw
Community College

ANN ARBOR, MICHIGAN



Ypsilanti Communit
High School



Washtenaw Golf Club!

Washtenaw Ave



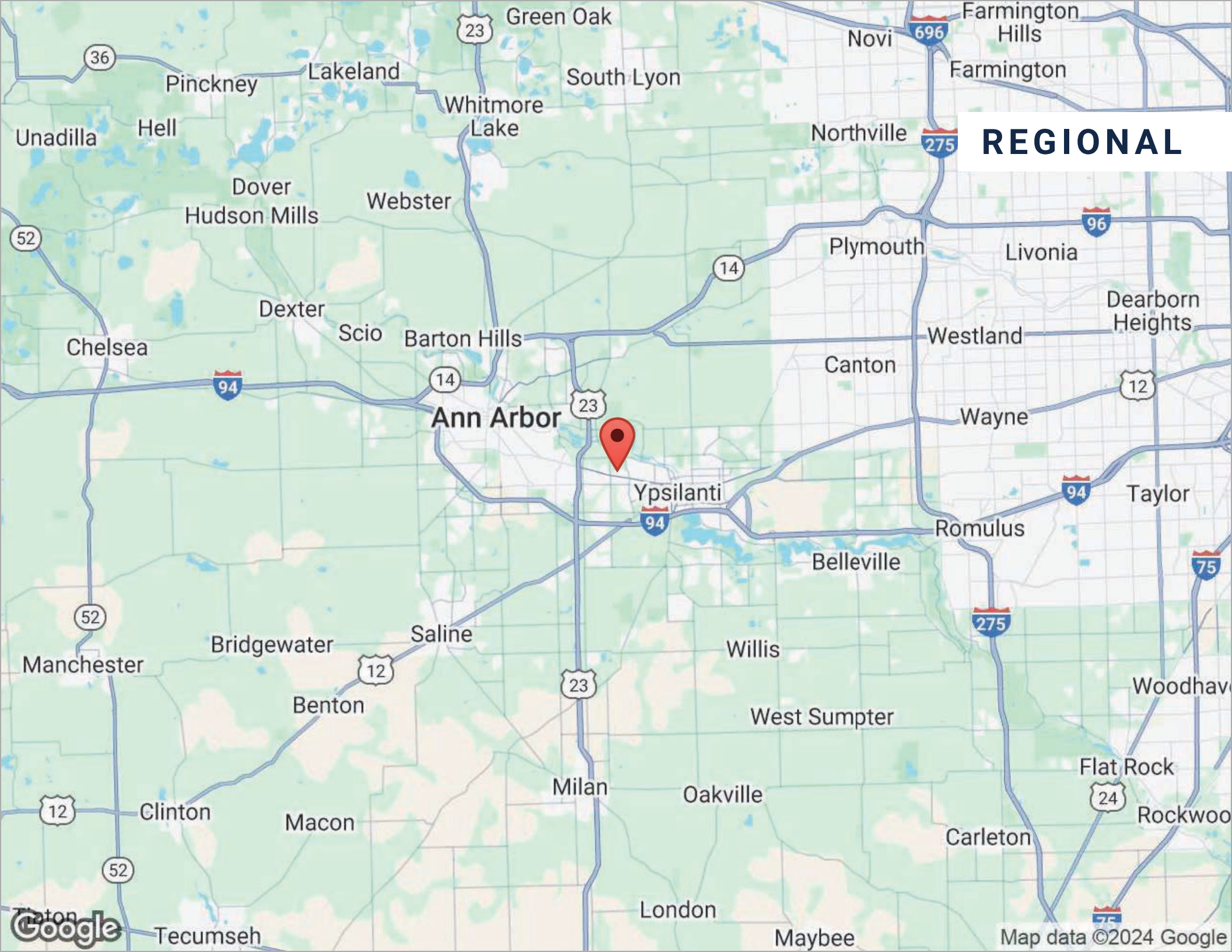

REGIONAL

Ann Arbor

Ypsilanti

YPSILANTI, MI - ANN ARBOR MSA



LOCATION DESCRIPTION

Ypsilanti, often affectionately called "Ypsi" by locals, is a charming city located in Washtenaw County, about 6 miles east of Ann Arbor and 35 miles west of Detroit. With a population of around 20,000, Ypsilanti is a vibrant and diverse community that blends rich history with a progressive, creative energy. The city is bounded to the north by Superior Township and on the west, south, and east by Ypsilanti Township. Ypsilanti is a part of the Ann Arbor metropolitan area, the Huron River Valley, the Detroit-Warren-Ann Arbor combined statistical area, and the Great Lakes megalopolis.

Ypsilanti is home to Eastern Michigan University (EMU), which is a major public university with a strong focus on liberal arts, business, and education. EMU is a significant part of the city's identity, contributing to the local economy, culture, and student population. Additionally, Ypsilanti residents have access to the educational resources and cultural offerings of nearby Ann Arbor, including the University of Michigan

The city's economy has historically been tied to manufacturing, particularly in the automotive industry, but like many other Midwestern cities, Ypsilanti has had to adapt as industrial jobs have declined. Today, the economy is more diverse, with key sectors including education, healthcare, retail, and technology. Ypsilanti is home to a growing number of small businesses, especially in the downtown area, as well as some high-tech startups. The city's affordable housing and its proximity to Ann Arbor and Detroit make it an attractive location for new residents and businesses.

DEMOGRAPHICS MAP & REPORT

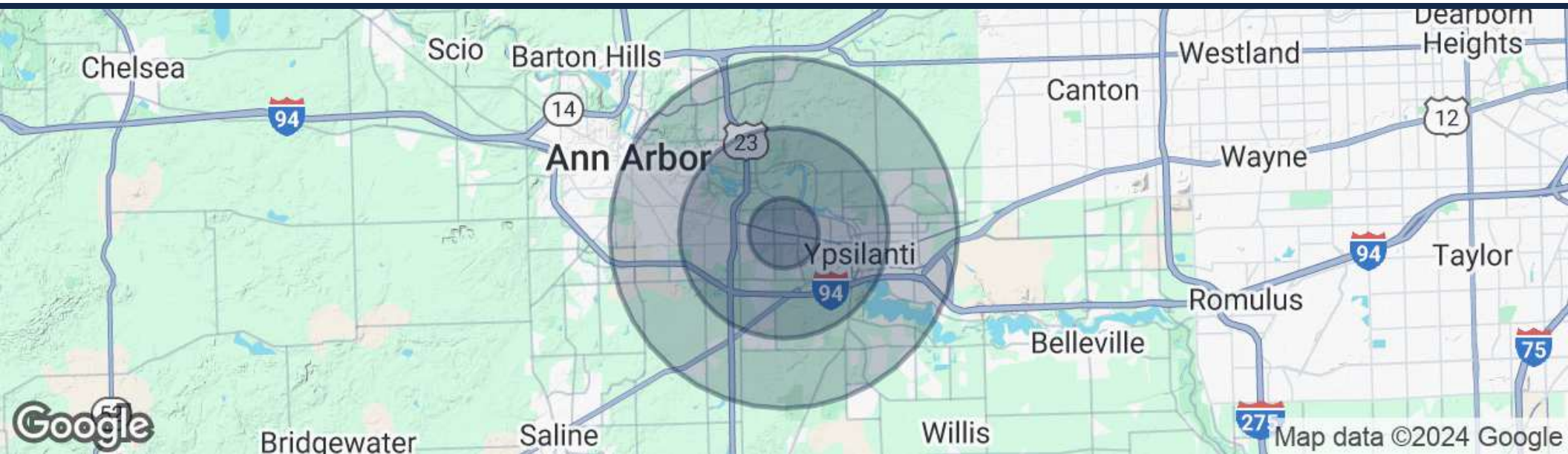

POPULATION	1 MILE	3 MILES	5 MILES
Total Population	13,228	66,201	166,180
Average Age	37	38	36
Average Age (Male)	36	37	35
Average Age (Female)	37	39	37
HOUSEHOLDS & INCOME	1 MILE	3 MILES	5 MILES
Total Households	6,310	29,285	67,782
# of Persons per HH	2.1	2.3	2.5
Average HH Income	\$80,293	\$95,727	\$100,339
Average House Value	\$251,326	\$342,772	\$389,602

Demographics data derived from AlphaMap



EXCLUSIVELY LISTED BY:

DANTE HARGIS

Senior Director

dhargis@encorereis.com

248.702.0289

DENO BISTOLARIDES

Managing Partner

denob@encorereis.com

248.702.0288