



PREMIER

DISTRIBUTION CENTER

1900 CONTINENTAL BLVD | CHARLOTTE, NC 28273



±123,000 SF

SUITE K



LM REAL ESTATE
PARTNERS

AVISON
YOUNG

SUITE K

1900 CONTINENTAL BLVD | CHARLOTTE, NC 28273

PROPERTY SPECIFICATIONS

Address 1900-K Continental Blvd. Charlotte, NC

Available SF ±123,000 sf

Clear Height 24' below the joists;
22' below the girders

Office Space Warehouse Office: ±1,340 sf
Retail/City Counter Office: ±1,332 sf
Total Office Space: ±2,672 sf

Column Spacing 42' x 42'

Fire Protection ESFR

Lighting LED

Dock High Doors Eighteen (18)

Drive-In Doors One (1)

Zoning ML-2

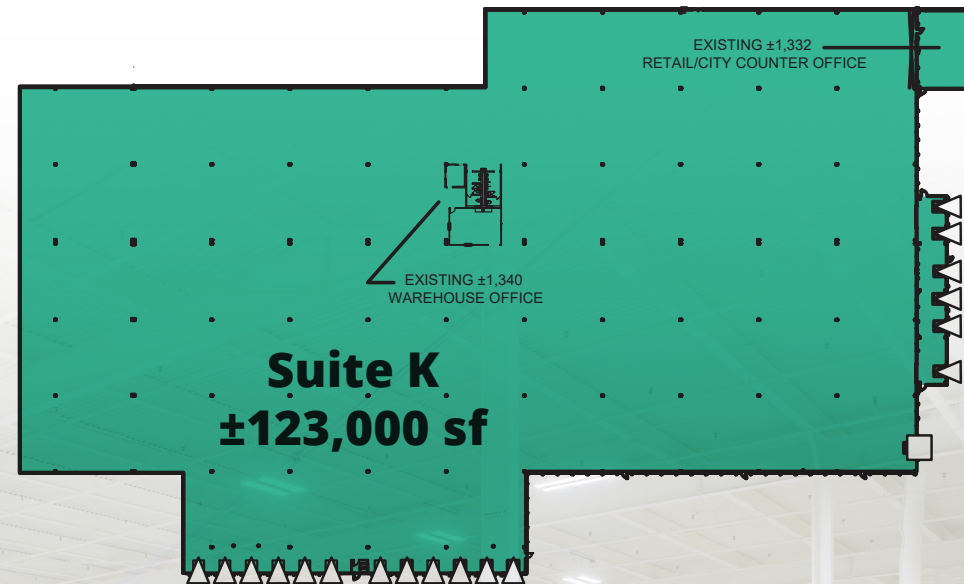
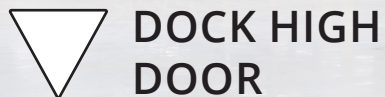

SITE PLAN

1900 CONTINENTAL BLVD | CHARLOTTE, NC 28273

Avison Young is pleased to offer 1900 Continental Blvd, or Premier Distribution Center available for lease. The $\pm 1,360,000$ sf building was built in 1966 and has recently been renovated. Located in one of Charlotte's most popular industrial submarkets,

this property is ideal for all industrial users seeking a presence in the Charlotte Market. The property offers tenants flexible floorplan solutions, flexible on-site trailer parking and outside storage areas, and immediate access to I-77 and I-485.



SUBMARKET

Westinghouse / Stateline



SITE AREA

± 68 acres



TOTAL BUILDING SF

$\pm 1,361,756$



ZONING

ML-2



YEAR BUILT

1966 (recently renovated)

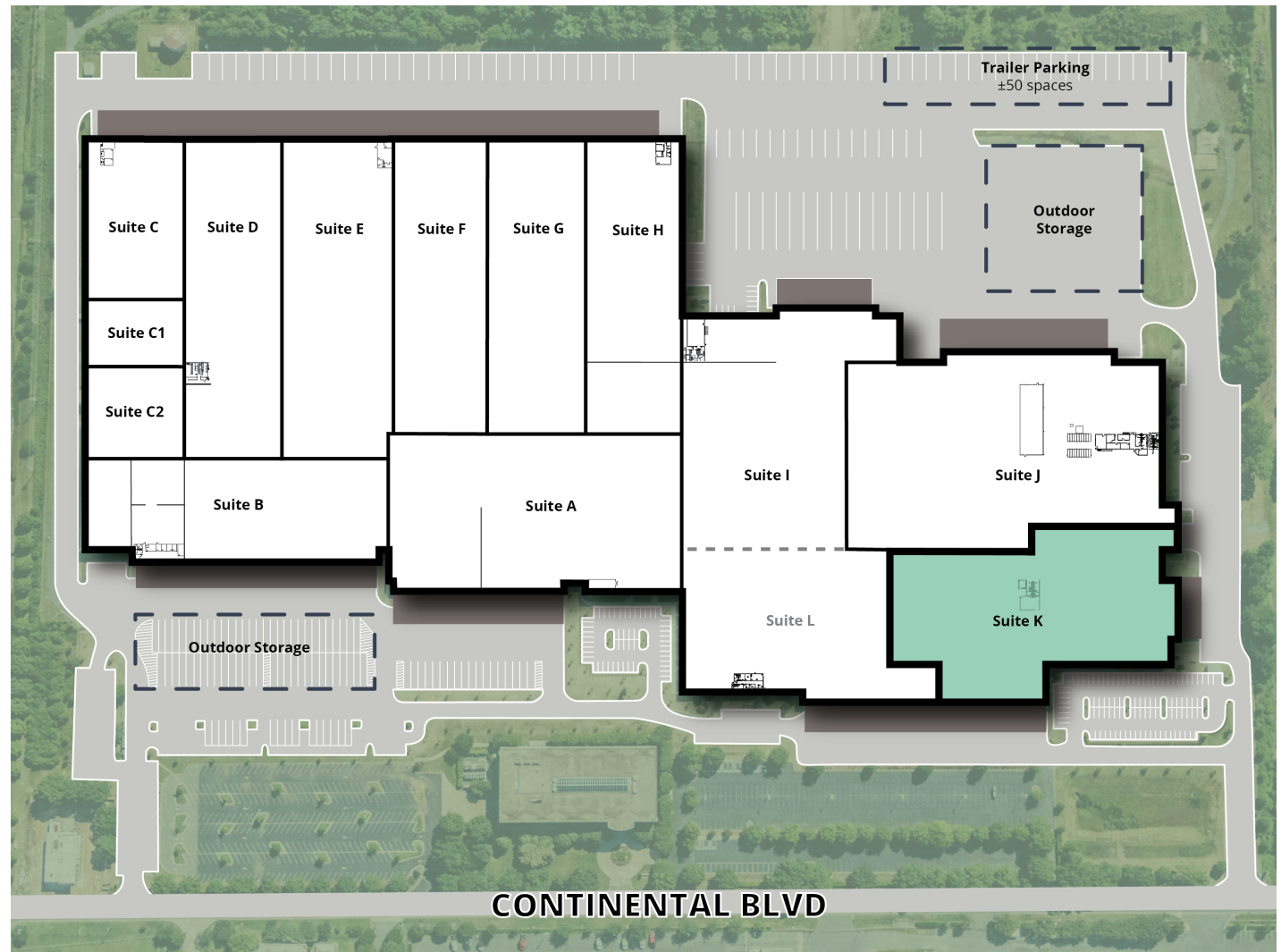

LOCATION OVERVIEW



FOR MORE INFORMATION:

Henry Lobb, SIOR
Principal
704 469 5964
henry.lobb@avisonyoung.com

Tom Tropeano, SIOR
Principal
704 413 0228
tom.tropeano@avisonyoung.com

Abby Rights
Senior Vice President
704 413 0235
abby.rights@avisonyoung.com



Interstate I-485 & I-77
LESS THAN ±1 MILE

NC/SC
Stateline

NC/SC Border
LESS THAN ±1 MILE



Uptown Charlotte
±10 MILES



Charlotte Douglas
International Airport
±11 MILES

**AVISON
YOUNG**



LM REAL ESTATE
PARTNERS