



133 128th St SW

Everett, WA

The property is currently occupied by Bargreen Ellingson and Tenant will vacate upon closing. The building is a tilt-up concrete construction situated on the interchange with I-5 and 128th St. SW, Everett, Washington. The building has glulam beam roof system, fully sprinklered and heated by suspended, Reznor-type heaters.

Building Features:

Building Size	30,240 SF
Land	83,200 SF (1.91 Acres)
Year Built	1994
Roof Replaced	2016
Loading Docks	2 dock high (truck well) doors with dock levelers
Sprinklers	Building fully sprinklered
Ceiling Height	14' - 18' (2/3 of the building is approx. 14' and 1/3 is 18')
Zoning	UC https://snohomish.county.codes/SCC/30.22.100

Many uses types of use allowed such as: Warehouse, Church, Retail, Schools, Office, Daycare, Laboratory, and Government to name a few.

FOR SALE

133 128th St SW
Everett, WA



Floor Plan

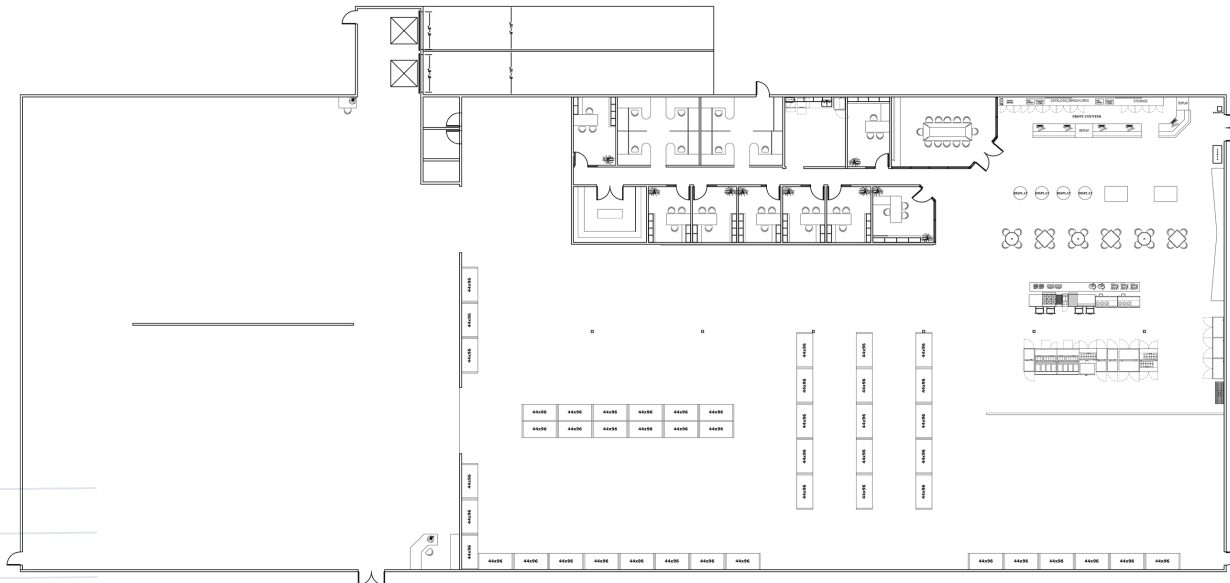

Building Photos



The distributor of this communication is performing acts for which a real estate license is required. The information contained herein has been obtained from sources deemed reliable but has not been verified and no guarantee, warranty or representation, either express or implied, is made with respect to such information. Terms of sale or lease and availability are subject to change or withdrawal without notice.

Building Photos



The distributor of this communication is performing acts for which a real estate license is required. The information contained herein has been obtained from sources deemed reliable but has not been verified and no guarantee, warranty or representation, either express or implied, is made with respect to such information. Terms of sale or lease and availability are subject to change or withdrawal without notice.

FOR SALE

133 128th St SW
Everett, WA



For more information, contact Matt Steiner at: 206.233.1999 | matt@beharcompany.com

beharcompany.com