

Millrise Station

150 Millrise Boulevard S.W. | Calgary, Alberta



Retail Leasing Opportunity



Ronmor Developers Inc.
Suite 250
5920 - 1A Street SW
Calgary, Alberta T2H 0G3

Angela Hill
Director, Leasing
403.692.4641 | 403.801.4045
ahill@ronmor.ca

  
ronmor.ca



PROPERTY OVERVIEW



Shopping centre is anchored by Sobeys and Shoppers Drug Mart



Pedestrian-friendly with pathway connections throughout



Close to public transportations routes and C-Train Station



Conveniently located close to MacLeod Trail and Shawnessy, Midnapore, and Evergreen



Diverse tenant mix



Adjacent to neighbouring multi-family development

Vacancy Information

Landlord's Legal Name:	Millrise Plaza Ltd.
Rentable Area:	1,536 SF Unit 3134 1,458 SF Unit 3141
Lease Rate:	Market
Annual Operating Costs:	±\$21.95 PSF (2026)
Availability:	Immediate
Term:	5-10 years
Parking:	Unassigned surface @ no charge



LOCATION

150 Millrise Boulevard S.W. | Calgary, Alberta



In the Area

- 1 Inverleigh Montessori School
- 2 Canvas at Millrise Apartments
- 3 Storage Mart
- 4 EMS Station #41
- 5 Fish Creek Vet Hospital
- 6 KFC
- 7 Petro-Canada

Shopping Centre Tenants

Sobeys
Shoppers Drug Mart
Starbucks
TD Bank
Kinjo Sushi & Grill
Rockwell Food & Taps

SITE PLAN



The information contained herein is provided for general information only and is subject to change at any time. Ronmor Developers Inc. and/or Ronmor Holdings Inc. (or its affiliates) will not be held responsible for any misrepresentation or misunderstanding arising from the contents of this marketing brochure.

FLOOR PLAN

Unit 3141 | Up to 3,128 SF

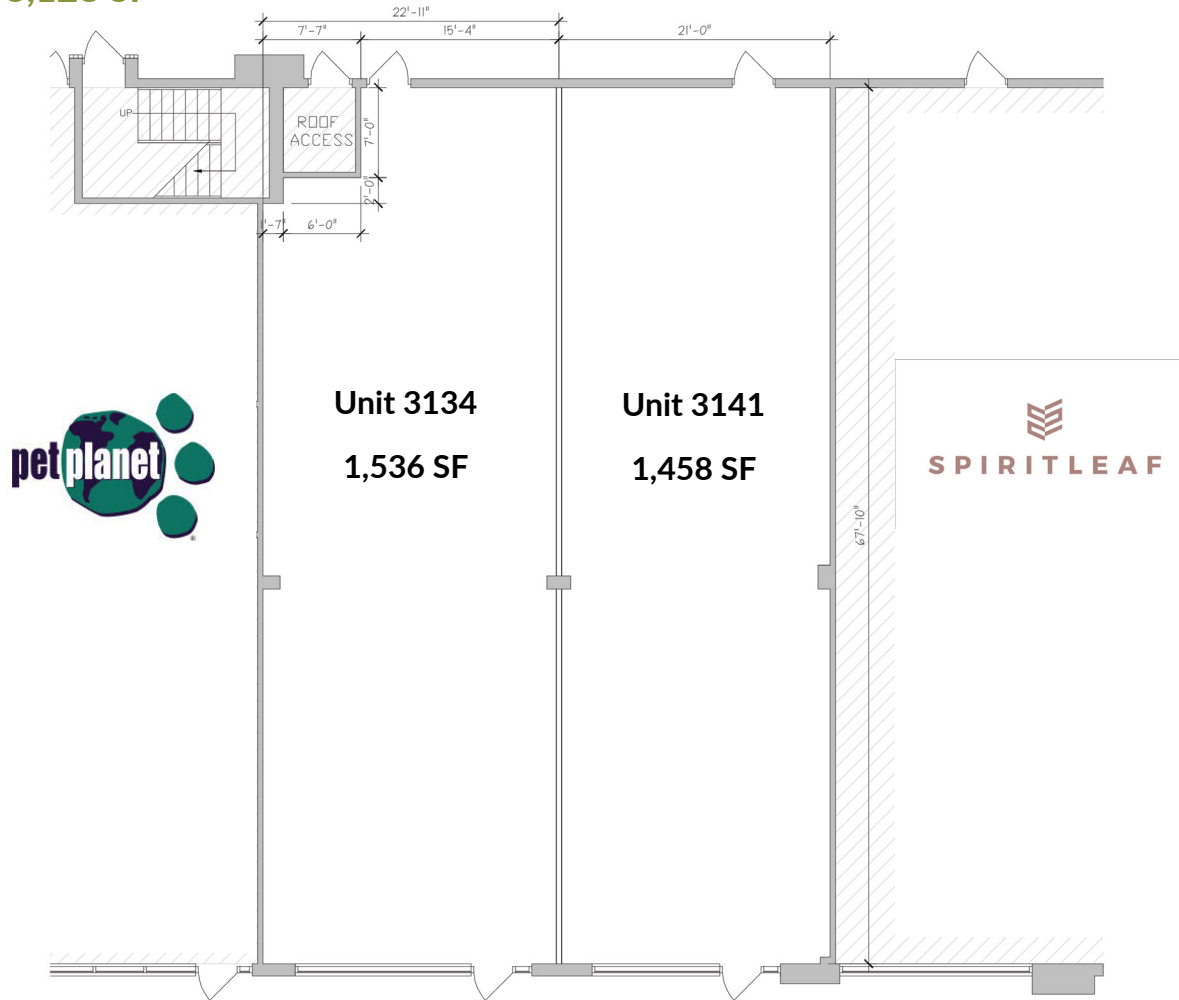

The information contained herein is provided for general information only and is subject to change at any time. Ronmor Developers Inc. and/or Ronmor Holdings Inc. (or its affiliates) will not be held responsible for any misrepresentation or misunderstanding arising from the contents of this marketing brochure.

PHOTOS

Unit 3141 | Up to 3,128 SF



IDEAL USES



Fitness



General Retail



Medical



Salon / Barbershop

DEMOGRAPHICS

	Aggregation	1 km Radius	3 km Radius	5 km Radius
Total Population	Sum	8,177	65,302	144,346
Daytime Population	Sum	7,160	44,088	95,672
Total Households	Sum	3,023	23,062	51,489



Median age
42 years old

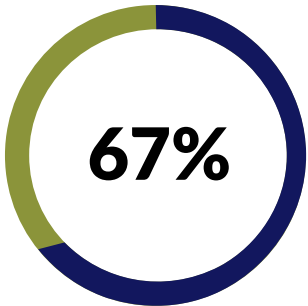

Employment Rate
within 1 km radius



Median Household Income
\$93,231

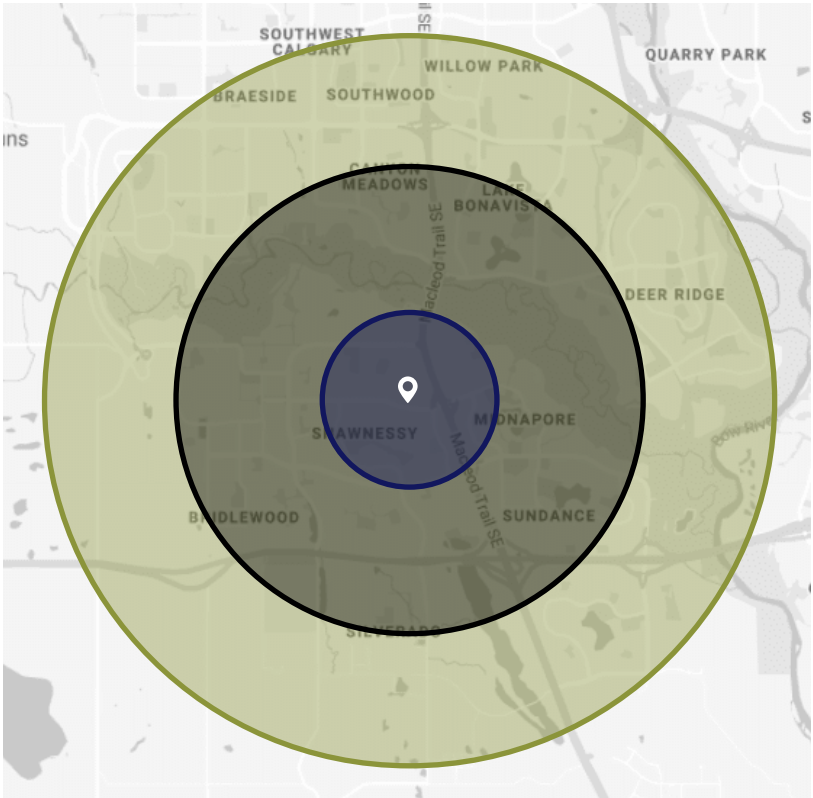

● 1 km Radius
 ● 3 km Radius
 ● 5 km Radius

 Primary age group
22-37
 year olds



A **MAJORITY** of the population is **university educated**