

11235

DISTRIBUTION AVE E

JACKSONVILLE, FLORIDA

FOR SUBLEASE

THROUGH JUNE 2028

SINGLE TENANT BUILDING

8,225 SF

AVAILABLE

Drake Chamberlin

Senior Associate

+1 772 285 3429

drake.chamberlin@cushwake.com

©2025 Cushman & Wakefield. All rights reserved. The information contained in this communication is strictly confidential. This information has been obtained from sources believed to be reliable but has not been verified. NO WARRANTY OR REPRESENTATION, EXPRESS OR IMPLIED, IS MADE AS TO THE CONDITION OF THE PROPERTY (OR PROPERTIES) REFERENCED HEREIN OR AS TO THE ACCURACY OR COMPLETENESS OF THE INFORMATION CONTAINED HEREIN, AND SAME IS SUBMITTED SUBJECT TO ERRORS, OMISSIONS, CHANGE OF PRICE, RENTAL OR OTHER CONDITIONS, WITHDRAWAL WITHOUT NOTICE, AND TO ANY SPECIAL LISTING CONDITIONS IMPOSED BY THE PROPERTY OWNER(S). ANY PROJECTIONS, OPINIONS OR ESTIMATES ARE SUBJECT TO UNCERTAINTY AND DO NOT SIGNIFY CURRENT OR FUTURE PROPERTY PERFORMANCE.

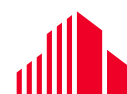

**CUSHMAN &
WAKEFIELD**

LOCATION

0.6 MILES to US-1
0.9 MILES to I-295
1.6 MILES to I-95



PROPERTY OVERVIEW

8,225

SQUARE
FEET

4

GRADE
DOORS

ADDRESS

11235 Distribution Ave E
Jacksonville, FL 32256

YEAR BUILT

2005

TOTAL AVAILABLE

8,225 SF

WAREHOUSE

7,696 SF

OFFICE

529 SF

LAND

0.48 Acres

CEILING HEIGHT

18'

CONSTRUCTION

Masonry and Steel

COLUMNS

Clear Span

CAR PARKING

10

DOORS

4 (14' x 14') Grade Level

ZONING

IL

SUBLEASE THROUGH

06/30/2028

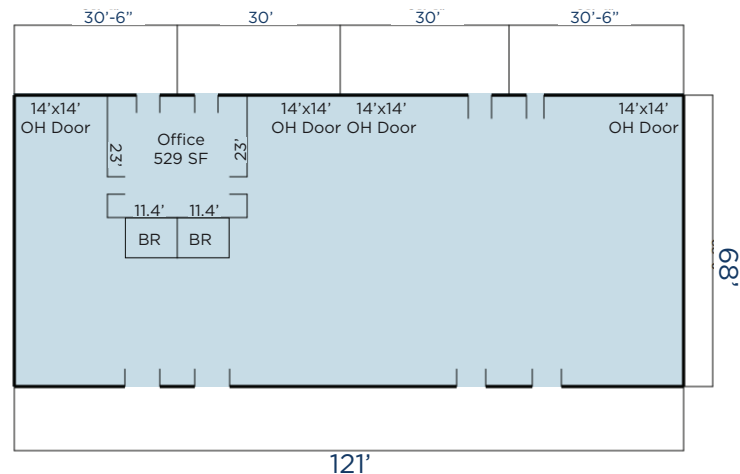

Drake Chamberlin
Senior Associate
+1 772 285 3429
drake.chamberlin@cushwake.com



©2025 Cushman & Wakefield. All rights reserved. The information contained in this communication is strictly confidential. This information has been obtained from sources believed to be reliable but has not been verified. NO WARRANTY OR REPRESENTATION, EXPRESS OR IMPLIED, IS MADE AS TO THE CONDITION OF THE PROPERTY (OR PROPERTIES) REFERENCED HEREIN OR AS TO THE ACCURACY OR COMPLETENESS OF THE INFORMATION CONTAINED HEREIN, AND SAME IS SUBMITTED SUBJECT TO ERRORS, OMISSIONS, CHANGE OF PRICE, RENTAL OR OTHER CONDITIONS, WITHDRAWAL WITHOUT NOTICE, AND TO ANY SPECIAL LISTING CONDITIONS IMPOSED BY THE PROPERTY OWNER(S). ANY PROJECTIONS, OPINIONS OR ESTIMATES ARE SUBJECT TO UNCERTAINTY AND DO NOT SIGNIFY CURRENT OR FUTURE PROPERTY PERFORMANCE.