

Industrial | For Lease



East El Paso Industrial

For Lease: 43,644 SF

12160 Rojas Drive, Ste. H
El Paso, Texas 79936
www.cbre.com/elpaso



East El Paso Industrial

12160 Rojas Drive, Ste H | El Paso, Texas 79936



Space Lease Information

- + Available Now
- + 43,644 SF Total Available
- + 20' Clear Height
- + 200' Building Depth
- + 92' Truck Court Depth
- + 8 Dock High Doors
- + 1 Drive-In Door
- + Immediate I-10 Access
- + Re-Striped Truck Court
- + New TPO Roof
- + New LED Lighting
- + "White Boxed Warehouse"
- + Fully HVAC Warehouse

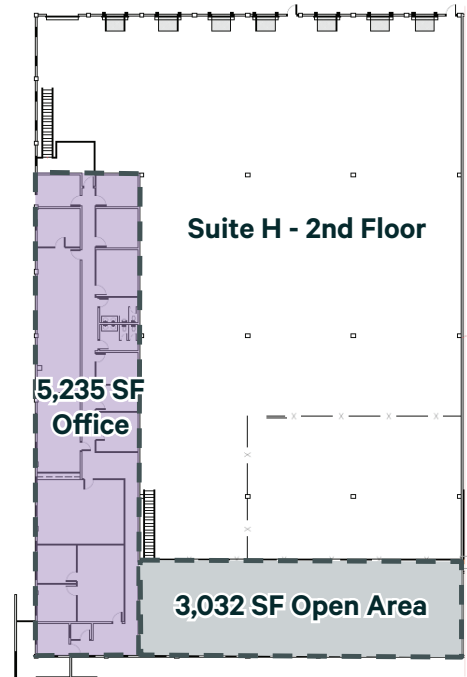
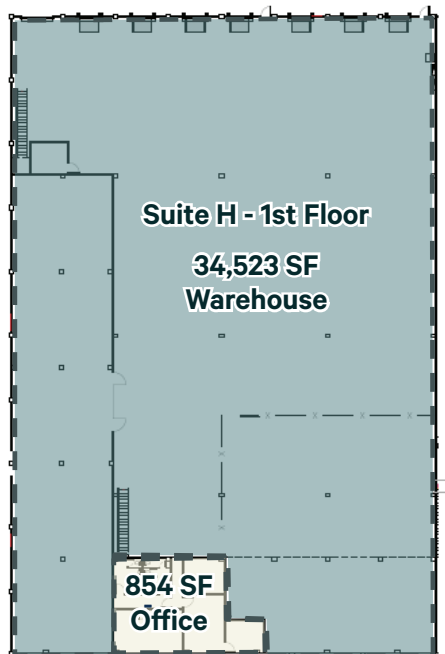
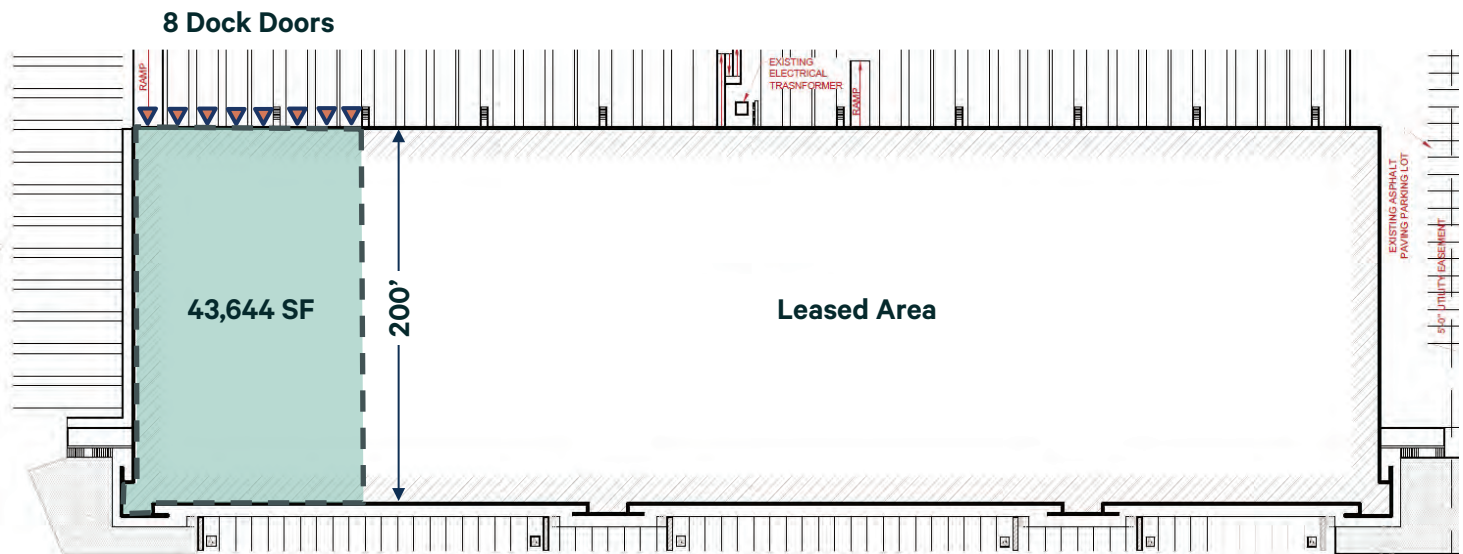

Area Breakdown

Warehouse	34,523 SF
Office - 1st Floor	854 SF
Office - 2nd Floor	5,235 SF
Open Mezz Area - 2nd Floor	3,032 SF
Total Area	43,644 SF

Capital Improvements

- + New TPO Roof (Complete)
- + Sealcoat/Stripped Truck Court (Complete)
- + Exterior Building Painting (Complete)
- + Interior Warehouse Painting (Planned)
- + New LED Warehouse Lighting (Planned)
- + Sprinkler Upgrades (Planned)
- + Replacement of 4 Levelers (Planned)

East El Paso Industrial

12160 Rojas Drive, Ste H | El Paso, Texas 79936

Property Photos

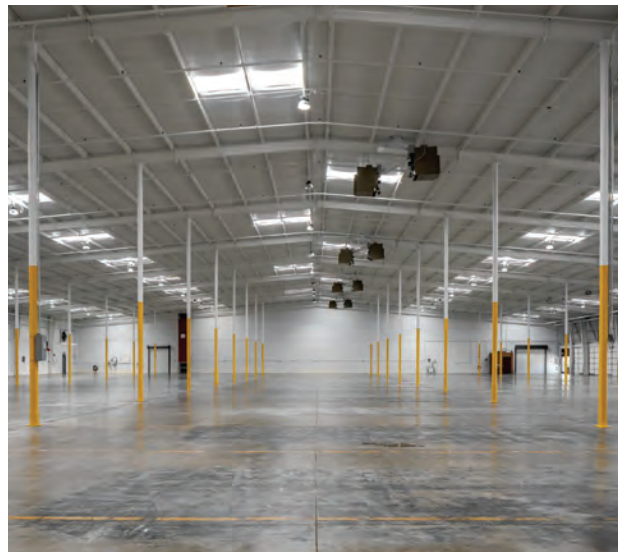
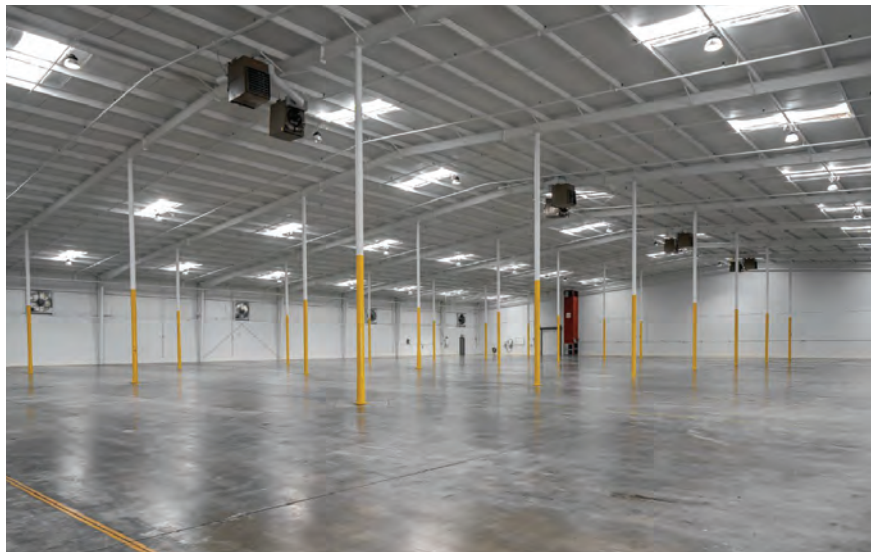

East El Paso Industrial

12160 Rojas Drive, Ste H | El Paso, Texas 79936

For Lease



Contact Us

Jacob Quinn

Senior Vice President

D: +1 915 313 8815

C: +1 915 269 6786

jacob.quinn@cbre.com

William Caparis, SIOR

Executive Vice President

D: +1 915 313 8804

C: +1 915 549 5365

bill.caparis@cbre.com

© 2025 CBRE, Inc. All rights reserved. This information has been obtained from sources believed reliable, but has not been verified for accuracy or completeness. You should conduct a careful, independent investigation of the property and verify all information. Any reliance on this information is solely at your own risk. CBRE and the CBRE logo are service marks of CBRE, Inc. All other marks displayed on this document are the property of their respective owners, and the use of such logos does not imply any affiliation with or endorsement of CBRE. Photos herein are the property of their respective owners. Use of these images without the express written consent of the owner is prohibited.

Invesco Real Estate

40 Years of Experience; Stability for our Tenants

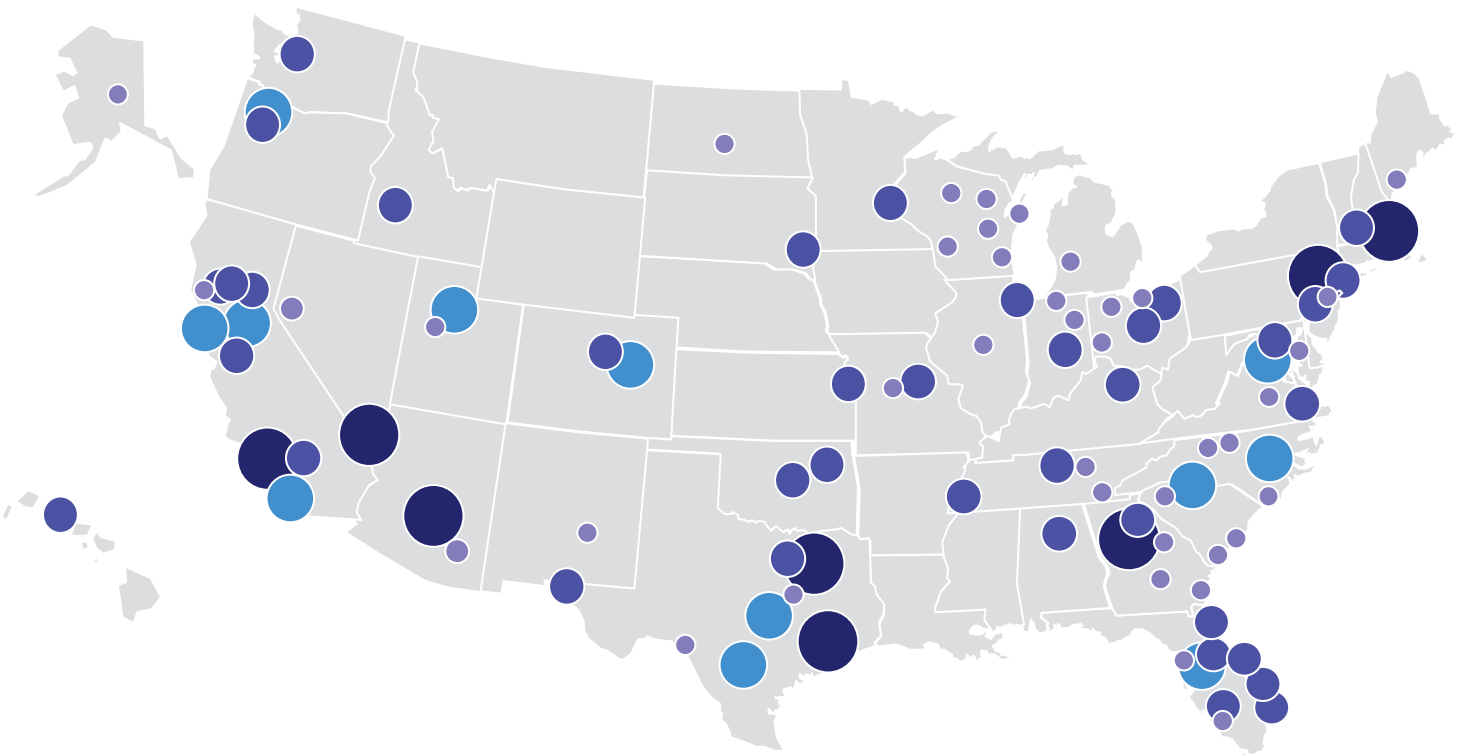

KEY: # of Investments

1

2-10

11-20

21+

 **Industrial**
~71M SF

 **Multifamily**
~40K Units

 **Office**
~26M SF

 **Medical Office**
~11M SF

 **Retail**
~10M SF

 **Single Family Rental**
~9M SF

 **Self Storage**
~5M SF

 **Life Science**
~1M SF

 **Other¹**
~5M SF

 **Real Estate Debt**
Over 100 Loans

¹Other includes Data Centers, Hotel, Land, Manufactured Housing, Senior Housing, Parking.

Source: Invesco Real Estate as of June 30, 2023, latest data available. Percentage of total gross asset value of all US direct real estate assets shown. For use with tenant prospects and brokers for discussion purposes only, and not for further distribution. This overview is designed to describe our platform. It is not to be construed as an offer to buy or sell any financial instruments and should not be relied upon as the sole factor in any investment making decision. Invesco Advisers, Inc. is an investment adviser; it provides investment advisory services to individual and institutional clients and does not sell securities.

~350
investments

~170M
square feet

100
markets

40
years of experience

Invesco Real Estate is a global leader in the real estate investment management business with \$88.9 billion in real estate assets under management, 612 employees and 21 regional offices across the U.S., Europe and Asia. Invesco Real Estate was established in 1983 and today invests across the risk return spectrum, from core to opportunistic; in equity and debt; listed and direct; locally and globally. Invesco Real Estate is a business name of Invesco Advisers, Inc., an indirect, wholly owned subsidiary of Invesco Ltd. Invesco Ltd. is an independent investment management firm dedicated to delivering an investment experience that helps people get more out of life. NYSE: IVZ; <http://www.invesco.com/realestate>



