

For
Lease

41,220 SF
Available

11720 W Grand Avenue

NORTHLAKE, ILLINOIS

PROPERTY HIGHLIGHTS

82,380 SF industrial building with 41,220 SF available for lease. Great location off of Grand Avenue, just south of O'Hare Airport's South Cargo Entrance. Minutes from interchanges to I-290 and I-294, with I-294 visibility. Institutionally owned & managed.

AVAILABLE	41,220 SF
TOTAL BUILDING	82,380 SF
OFFICE AREA	1,717 SF
CLEAR HEIGHT	22'
LOADING	4 Interior Docks 1 Drive-In Door
POWER	800 Amps @ 480 Volts
SPRINKLERED	Fully
PARKING	40 Cars
ZONED	I-2
LEASE RATE:	Subject to Offer

OWNED & MANAGED BY:



Contact

Terry Herlihy
+1 630 693 0664
therlihy@hiffman.com

Mark Baumhart, CCIM
+1 630 691 0550
mbaumhart@hiffman.com

One Oakbrook Terrace
Suite 400
Oakbrook Terrace, Illinois 60181
+1 630 932 1234

SITE PLAN

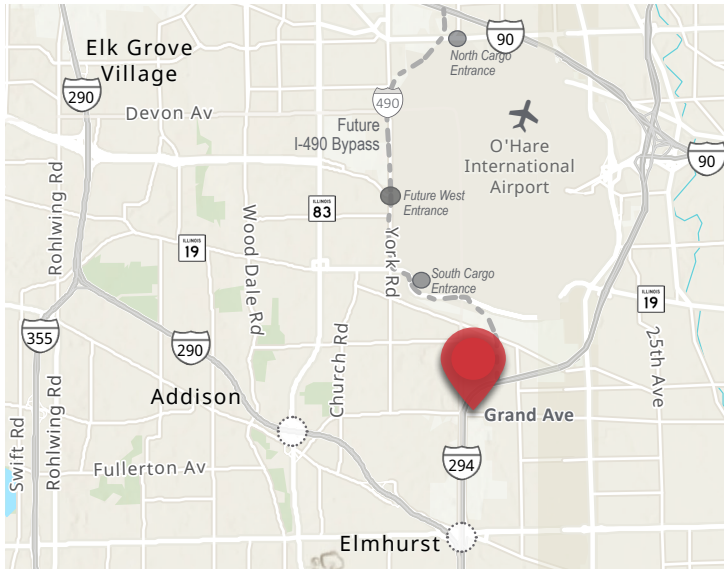
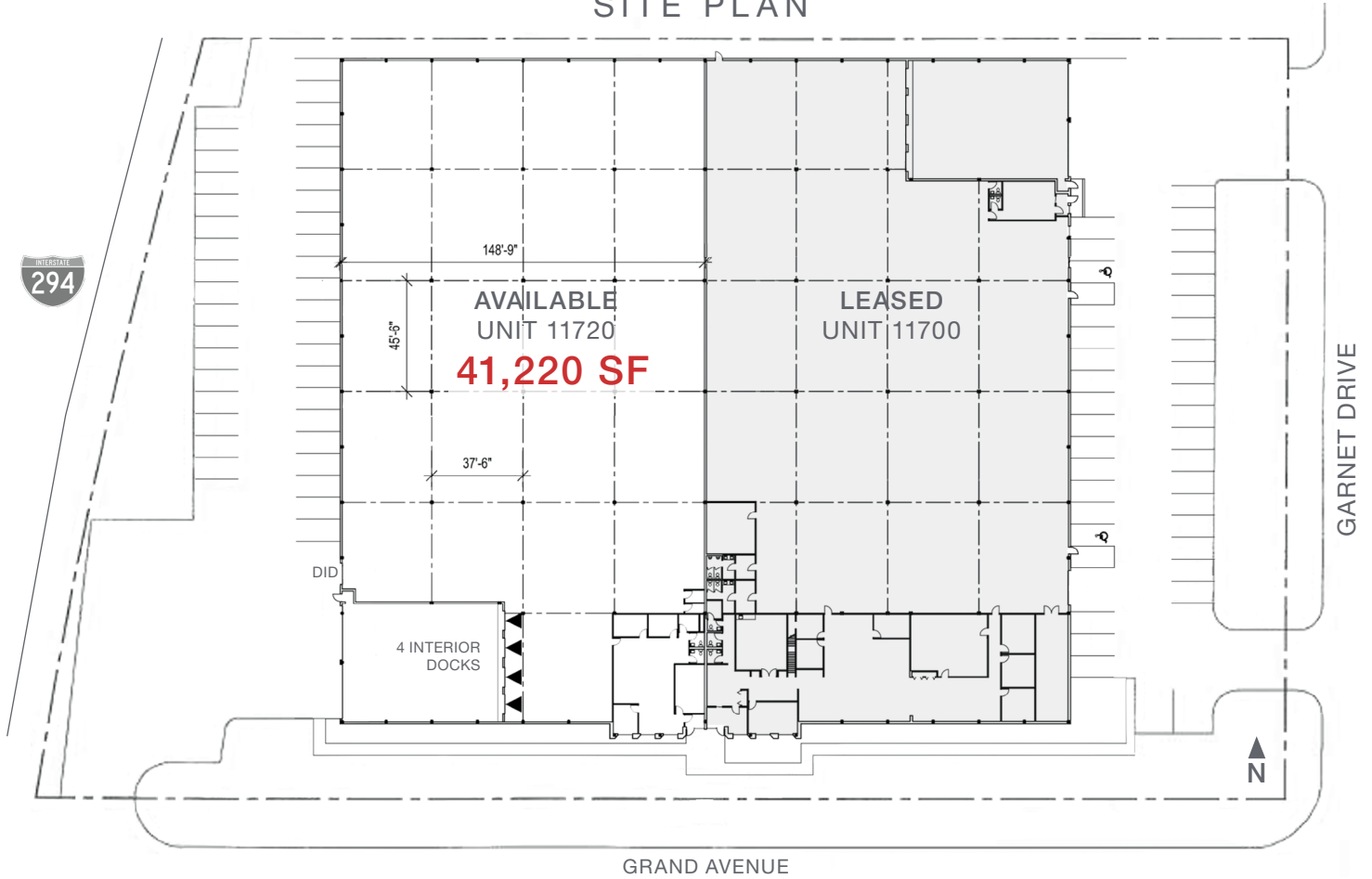

OWNED & MANAGED BY



One Oakbrook Terrace
Suite 400
Oakbrook Terrace, Illinois 60181
+1 630 932 1234

hiffman.com