

AVAILABLE - JR. ANCHOR SPACE

COLEMAN LANDINGS
750 NEWHALL DR | SAN JOSE, CA

[CLICK FOR TRAILER](#)

Site



86,199 ADT

33,832 ADT

Coleman Ave

±30,000 SF AVAILABLE

JEFF BADSTUBNER
Managing Director, Retail
+1 415 395 4916
jeff.badstubner@jll.com
RE License #01155279

DAVE WHITE
Vice President, Retail
+1 916 440 1831
dave.white@jll.com
RE License #01759894

JOHN BRECHER
Vice President, Retail
+1 916 440 1826
john.brecher@jll.com
RE License #01897931

Jones Lang LaSalle Brokerage, Inc.,
Real estate license #01856260



COLEMAN LANDINGS - JR. ANCHOR SPACE

750 NEWHALL DR - OVERVIEW

- +/- 30,000 SF Available for Sublease
- Building is a former Lowe's with open ceiling and high clear heights
- Space is demised and power separated
- Exceptional parking in the center
- Anchored by At Home, City Sports Club, and Staples
- In-N-Out, Chipotle, Starbucks and Chevron drive consistent traffic on the pads



FLOOR PLAN

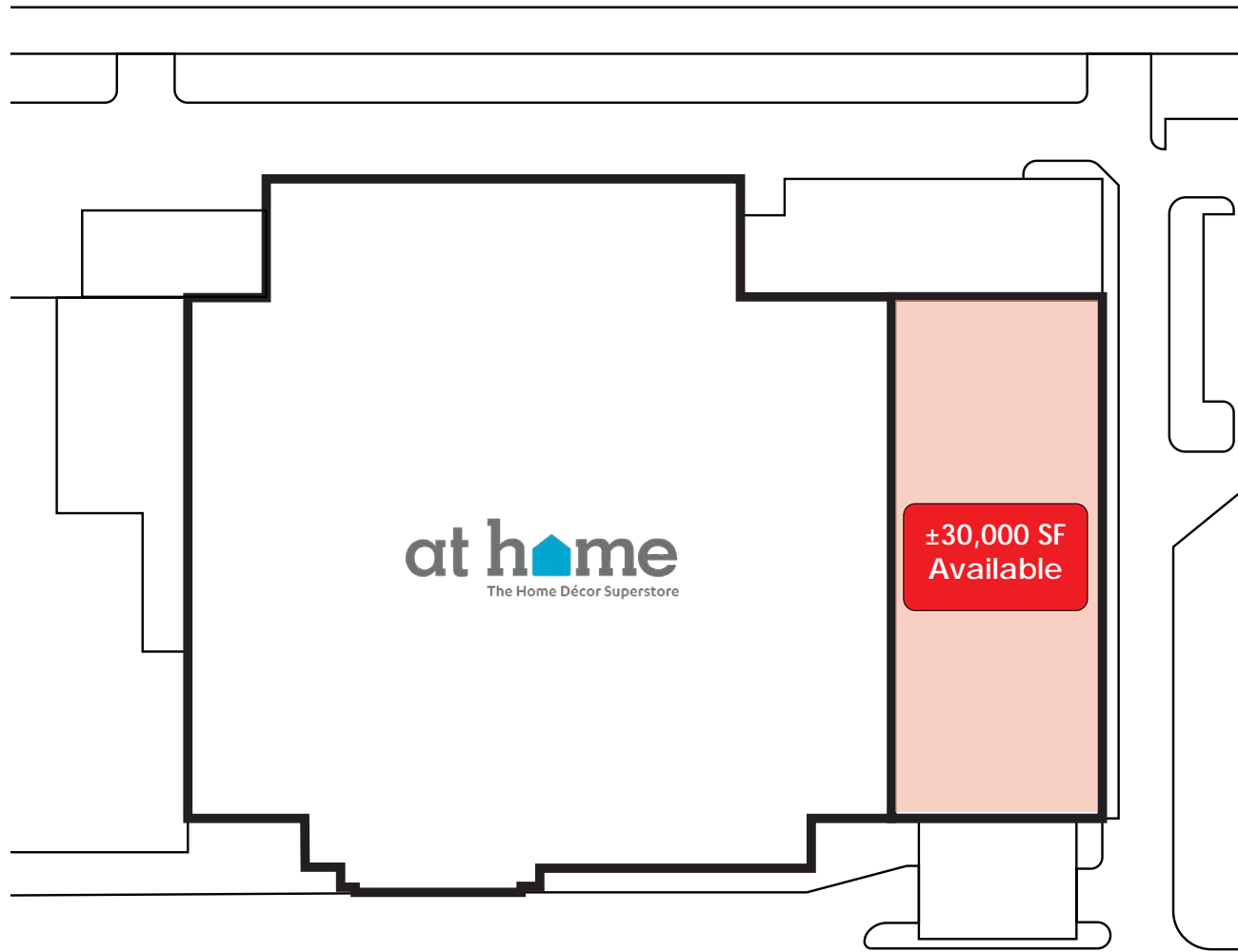

AERIAL



±30,000 SF

at home
The Home Décor Superstore

STAPLES

PayPal Park

CITY SPORTS CLUB

Starbucks
CHIPOTLE MEXICAN BURRITOS
TOGO'S

Chevron

IN-N-OUT BURGER

SMOKING PIG BBQ COMPANY
HIKIN

INTERSTATE CALIFORNIA 880

86,199 ADT

33,832 ADT

Coleman Ave

5 MILE DEMOGRAPHICS

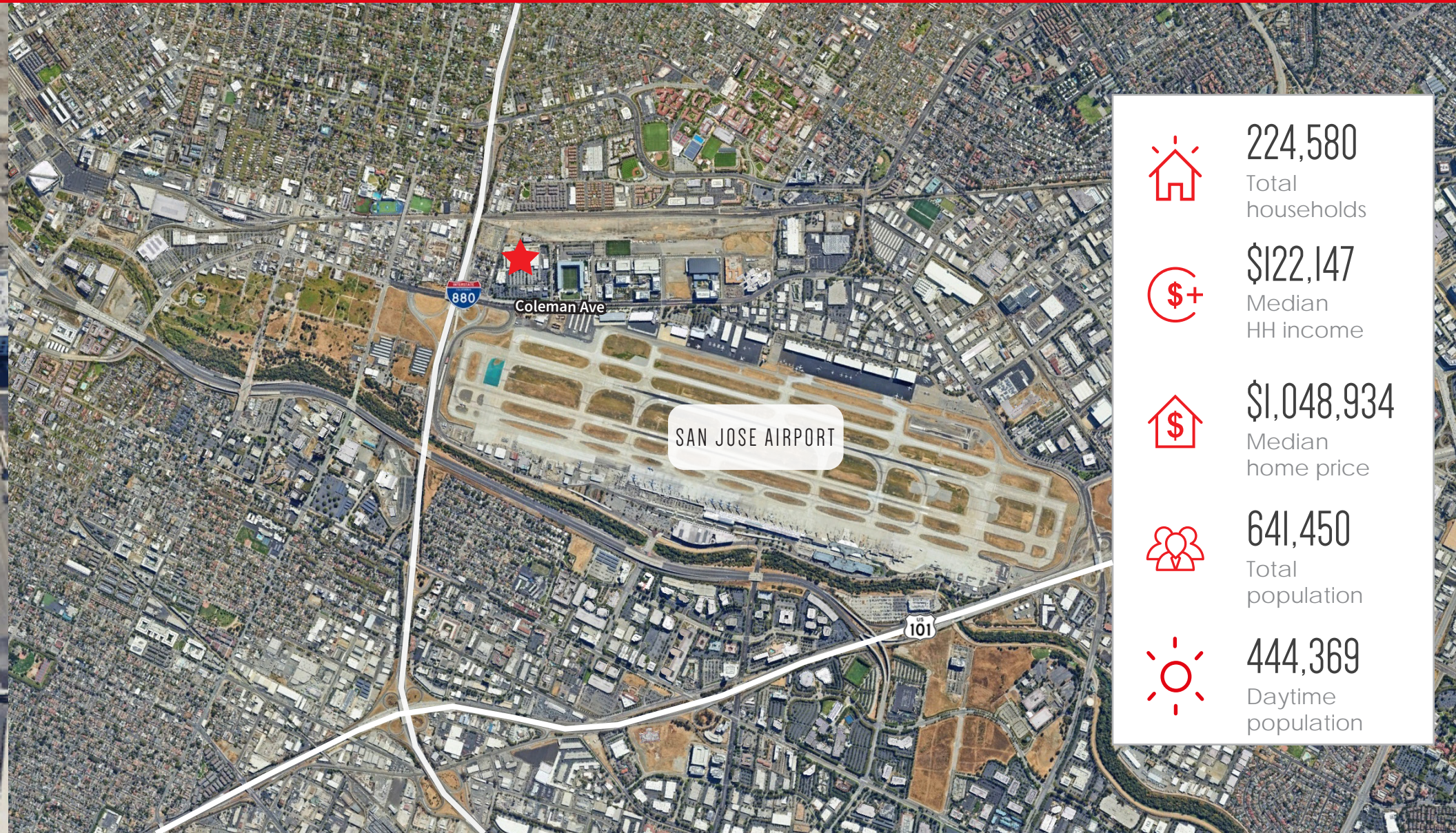

750 NEWHALL DR | SAN JOSE, CA



JEFF BADSTUBNER

Managing Director, Retail
+1 415 395 4916
jeff.badstubner@jll.com
RE License #01155279

DAVE WHITE

Vice President, Retail
+1 916 440 1831
dave.white@jll.com
RE License #01759894

JOHN BRECHER

Vice President, Retail
+1 916 440 1826
john.brecher@jll.com
RE License #01897931

Although information has been obtained from sources deemed reliable, JLL does not make any guarantees, warranties or representations, express or implied, as to the completeness or accuracy as to the information contained herein. Any projections, opinions, assumptions or estimates used are for example only. There may be differences between projected and actual results, and those differences may be material. JLL does not accept any liability for any loss or damage suffered by any party resulting from reliance on this information. If the recipient of this information has signed a confidentiality agreement with JLL regarding this matter, this information is subject to the terms of that agreement. ©2024 Jones Lang LaSalle Brokerage, Inc. All rights reserved.



* - representative photo. Not actual building.