

FOR SALE

100/200 GALLERIA OFFICENTRE
SOUTHFIELD, MI 48034



RENDERING

100/200 GALLERIA OFFICENTRE SOUTHFIELD, MI 48034

PROPERTY HIGHLIGHTS:

- Ideal, build-to-suit, for flex office/tech center users
- Approximately 150,000 SF tech space and 100,000 SF office space
- Centrally located to all south-eastern Michigan's major markets
- Located in the heart of Southfield Office Market with proximity to all area freeways: I-696, Northwestern Hwy, John C Lodge Fwy
- Prominent building signage available along Northwestern Hwy and 12 Mile Rd

The information provided herein along with any attachment(s) was obtained from sources believed to be reliable, however, Friedman Real Estate makes no guarantees, warranties, or representations as to the completeness or accuracy of such information and legal counsel is advised. All information provided is subject to verification and no liability for reliance on such information or errors or omissions is assumed. The presentation of this property is submitted subject to errors, omissions, change of price or conditions, prior sale or lease, or withdrawal without notice. Copyright © 2023 Friedman Real Estate. All rights reserved.

FOR MORE INFORMATION PLEASE CONTACT:



ROBERT GAGNIUK
robert.gagniuk@freg.com



JORDAN FRIEDMAN
jordan.friedman@freg.com

248.324.2000

eCODE 304

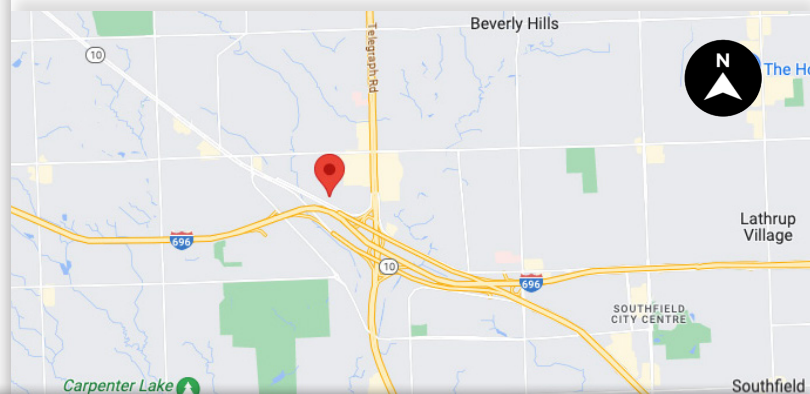

FOR SALE

**100/200 GALLERIA OFFICENTRE
SOUTHFIELD, MI 48034**



FOR SALE

100/200 GALLERIA OFFICENTRE
SOUTHFIELD, MI 48034

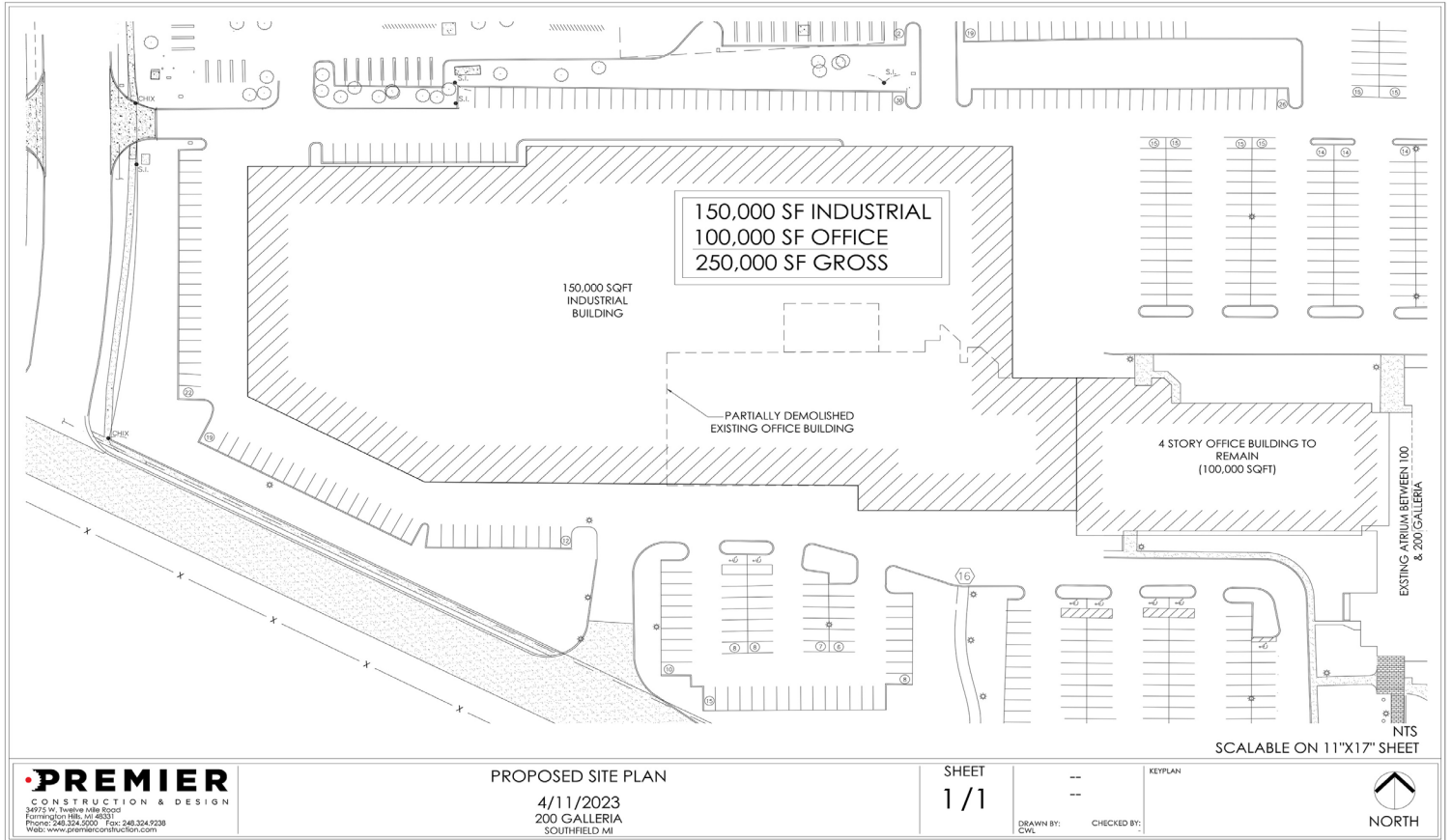

FOR MORE INFORMATION PLEASE CONTACT:



ROBERT GAGNIUK
robert.gagniuk@freg.com



JORDAN FRIEDMAN
jordan.friedman@freg.com