

# 2400

**N. GLENVILLE DRIVE**

RICHARDSON, TX 75082



**23,635 RSF SUBLEASE AVAILABLE**

Divisible Down to 10,000 RSF





# 2400

N. GLENVILLE DRIVE  
RICHARDSON, TX 75082

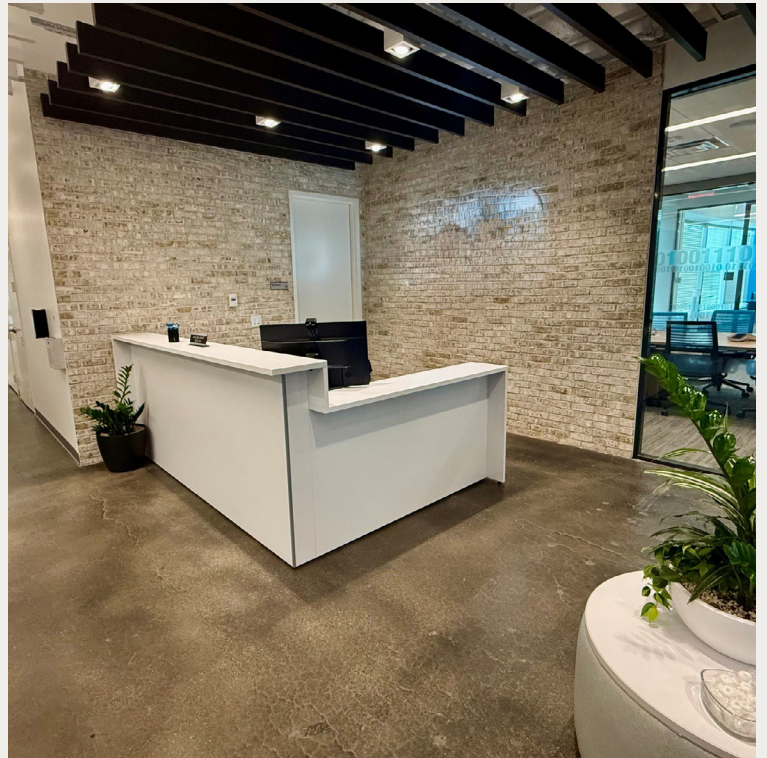

PROPERTY HIGHLIGHTS:



**23,635 RSF**  
on the 4th floor



**EXPIRES**  
May 31st, 2028



**ASKING RENT:**  
\$18.50 NNN (\$11.25)  
plus E (\$1.19)



**FULLY  
FURNISHED**



# PROPERTY PHOTOS



## FLOOR PLAN

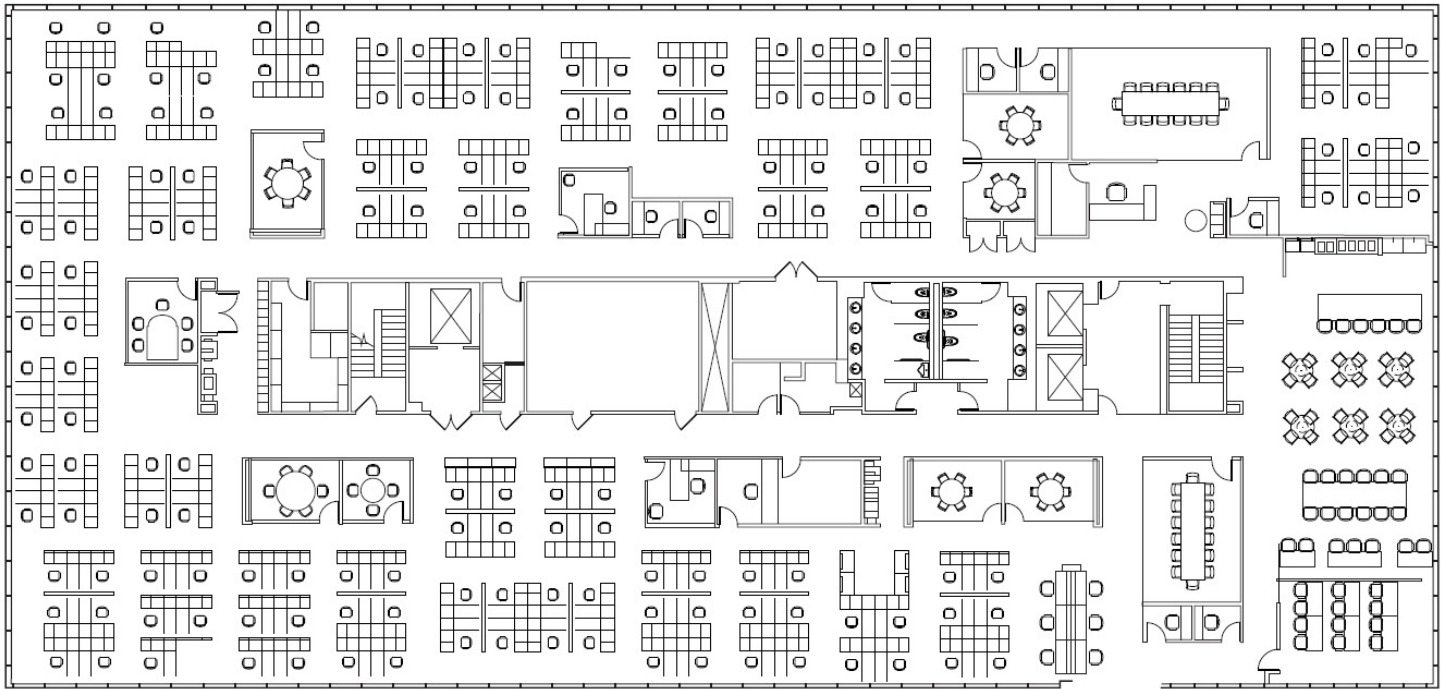

### PROPERTY FEATURES

- 110 Parking Spaces At No Charge
- Large Break Room/Cafeteria, Game Room, Approximately 144 Workstations, 3 Large Conference Rooms, 6 Small Conference/Huddle Rooms
- 24-7 Security
- Building Cafeteria, Tenant Lounge, 2 Building Conference Rooms, Training Room, Fitness Center, Outdoor Landscaped Courtyard 24-7 Security

# LOCATION MAP

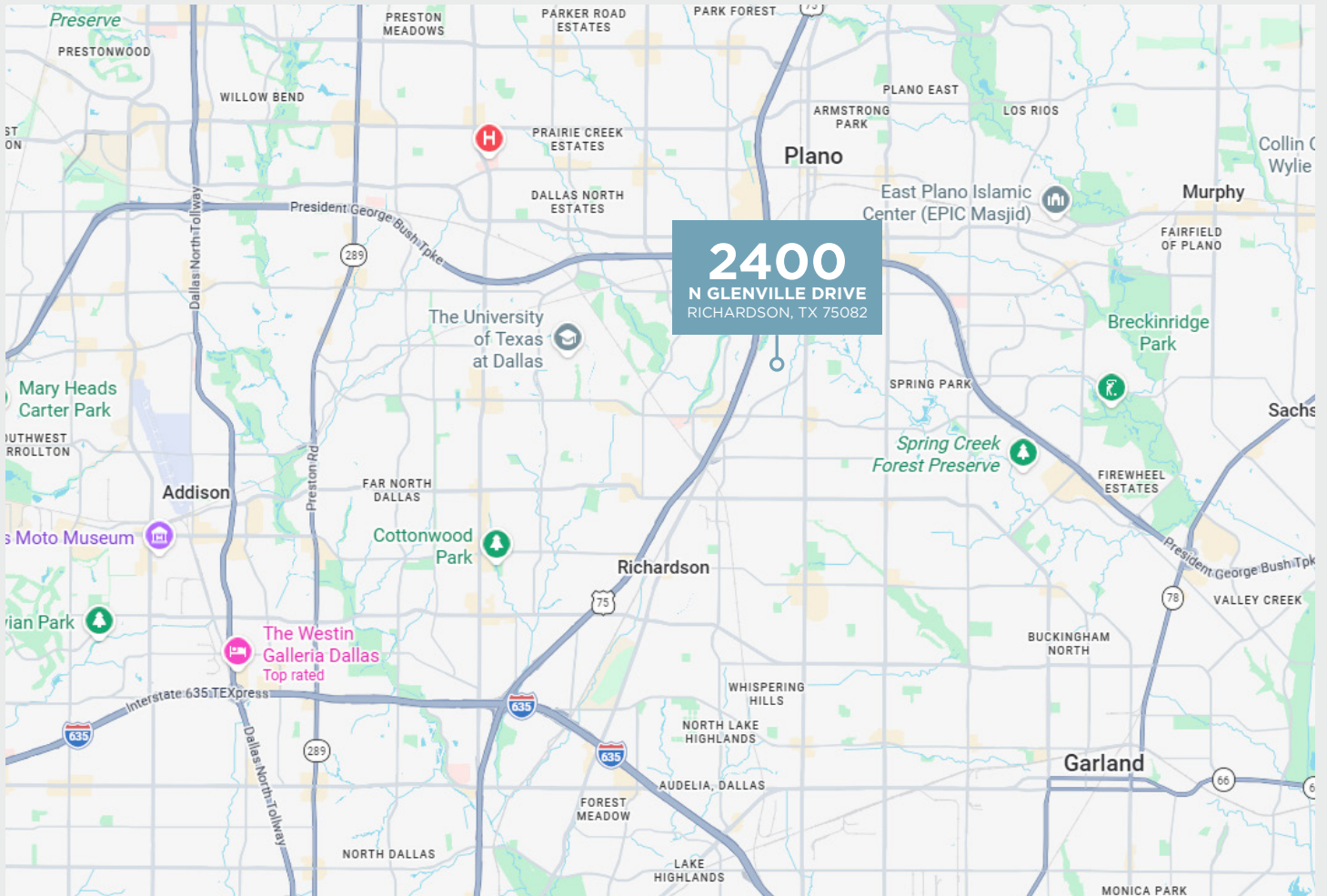

## TRAVIS BOOTHE

Executive Managing Director  
+1 972 663 9843  
travis.boothe@cushwake.com

## ALEXANDRA BOURY

Senior Director  
+1 972 663 9659  
alexandra.bouyry@cushwake.com

2021 McKinney Avenue  
Suite 900 Dallas, TX  
Main +1 972 663 9600  
[cushmanwakefield.com](http://cushmanwakefield.com)

