



Dimensional
Place Two

Two

6300 Bee Caves Road



Watch The Video

Elevate Your Work Environment

Dimensional Place is a two-building, 22-acre corporate campus located among the lush landscape of West Lake Hills, just seven miles from Downtown Austin. Building Two encompasses 157,783 square feet and five stories of exceptionally designed office space.

The incredible floor-to-ceiling windows allow natural light to pour in while showcasing panoramic views of the rolling hills, making this the ultimate work environment for companies seeking elevated office space away from the stress of Downtown. With expansive hills to the west and the city skyline to the east, every view can be captured from this curvilinear building.

Dimensional Place Two





6300 Bee Caves Road



Dimensional Place Two



Space for *Sunsets* & Spectacular *Views*



Nearby local artisan coffee shops



Nearby grocery store, restaurants and gym



Onsite pocket park and outdoor space



4:1,000 parking ratio with structured garage

Amenities Abound



Dimensional Place Two

2244

360

1

2244

360

3

2

1 - Amenity List

- The Grove Wine Bar and Kitchen
- Lola Savannah Coffee Lounge Westlake
- County Line on the Hill
- The Well Westlake
- Jimmy John's
- Bank of America Financial Center
- Club Pilates

Dimensional Place Two



Time in Minutes

1

H-E-B Grocery & Pharmacy

6

Davenport Village

13

Galleria in Bee Cave

17

Downtown Austin

*2&3 –
Amenity List*

H-E-B & Pharmacy
Whole Foods
Kerbey Lane Cafe
Chick-fil-A
Lupe Mexican Tortilla
MOD Pizza

Finley's Barber Shop
Izumi Sushi
Tacodeli
Starbucks
CAVA
AT&T Store

P Terry's Burger Stand
Gold's Gym Westlake
FedEx Dropbox
Southwest Bank

6300 Bee Caves Road

Floors *Available*

2

Suite 200 - 25,614 SF

**Potential Demising Plans >>*





6300 Bee Caves Road

Floor 2

Suite 200 - 25,614 SF

**Potential Demising Plans >>*



6300 Bee Caves Road

Floor 2

Potential Demising Plan

**View As-Built >>*

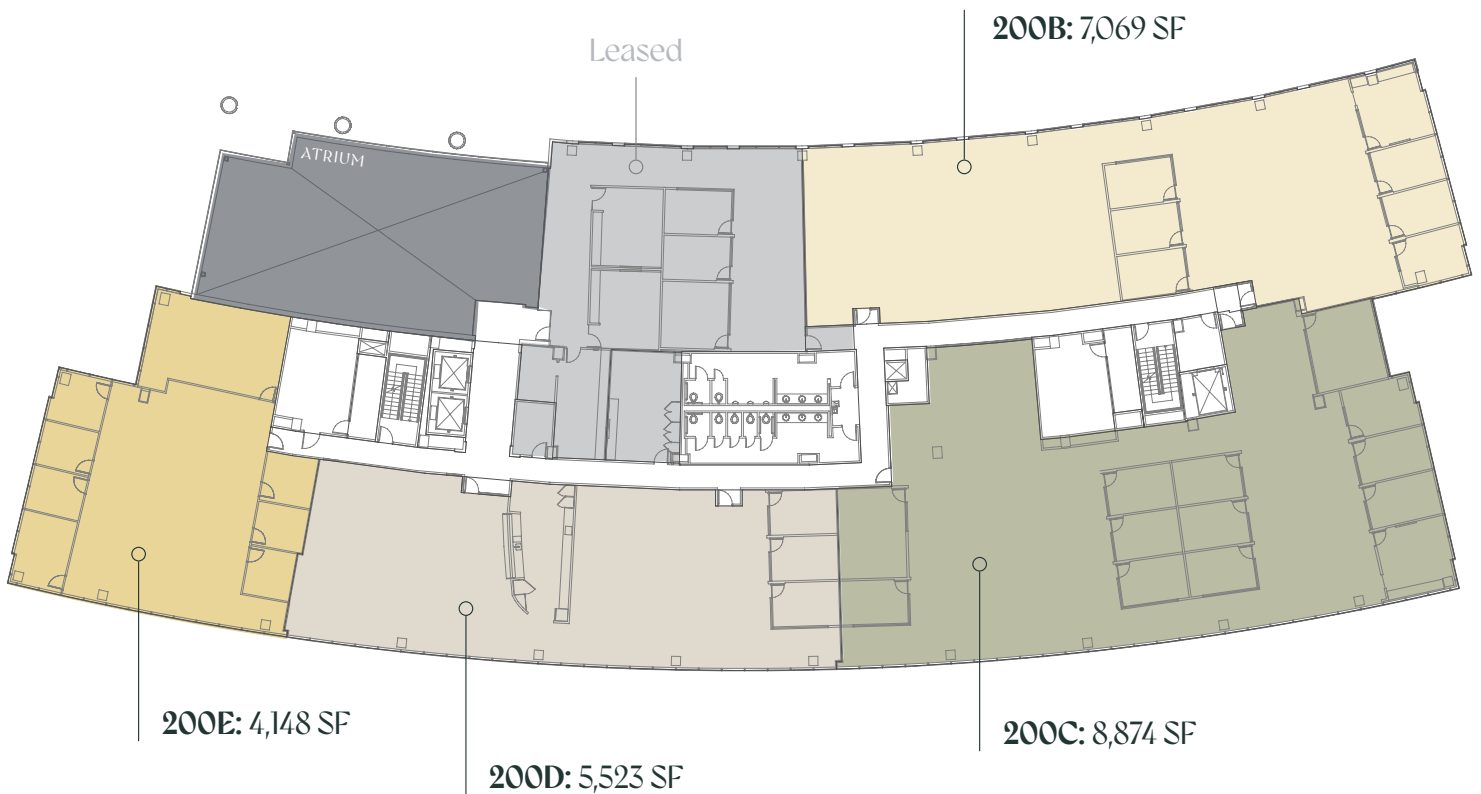

Dimensional Place Two



Rachel Coulter

RACHEL.COULTER@STREAMREALTY.COM
512.481.3058

Travis Rogers

TRAVIS.ROGERS@STREAMREALTY.COM
512.481.3059

Brita Hovde

BRITA.HOVDE@STREAMREALTY.COM
512.481.3048