

LANDSCAPE PROPERTY REPORT



PROPERTY INFORMATION

LOCATION DETAILS

PROPERTY ADDRESS: 54217 Rge Rd 260

NEIGHBOURHOOD: Rural NW

ROLL #: 131385

PLAN #: NW 18 54 25 W4

BLOCK #:

LOT #:

RURAL LEGAL MERIDIAN: 4

RANGE: 25

TOWNSHIP: 54

SECTION: 18

YEAR BUILT:

LAND USE ZONING: Transitional (TRN)

PROPERTY ASSESSMENT

PROPERTY CLASS:

TAXATION YEAR: 2025

ASSESSMENT CLASS: 8001

GROSS PROPERTY ASSESSMENT: \$32,300.00

CURRENT TAX LEVY: \$363.68

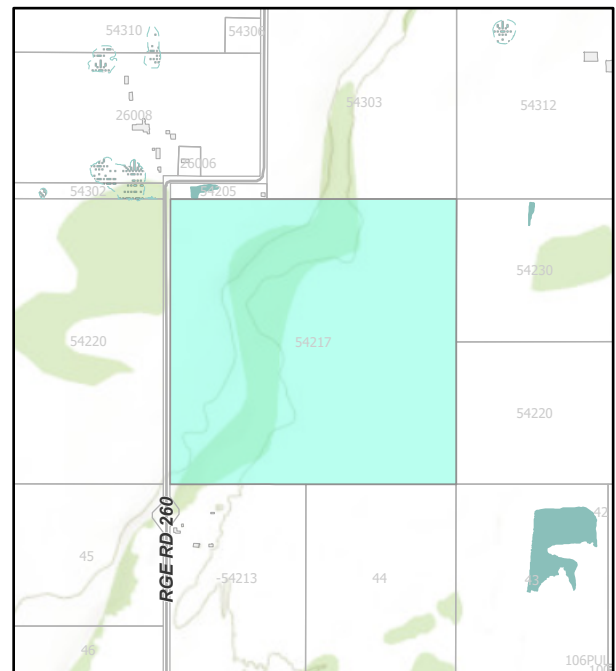
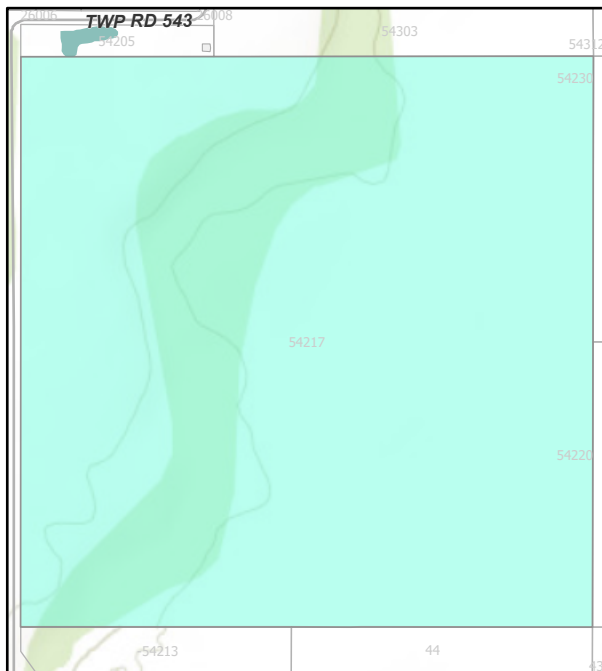

Report generated for the 2025 tax year by the City of St. Albert.

This summary represents information taken from the 2025 City of St. Albert tax roll. The information contained in this document is subject to change on an annual basis, and the City is not liable for damages or losses that may result from the use of the information in this document.

For questions regarding the content of this report, including properties with multiple assessment codes, separately titled parking and/or storage units contact the **Assessment Department** at **780-459-1603**.