

PID PHASE 1 IMPROVEMENT MAP FOR: SAND HOLLOW GATEWAY

LOCATED ON SAND HOLLOW RD, HURRICANE
WASHINGTON COUNTY, UTAH

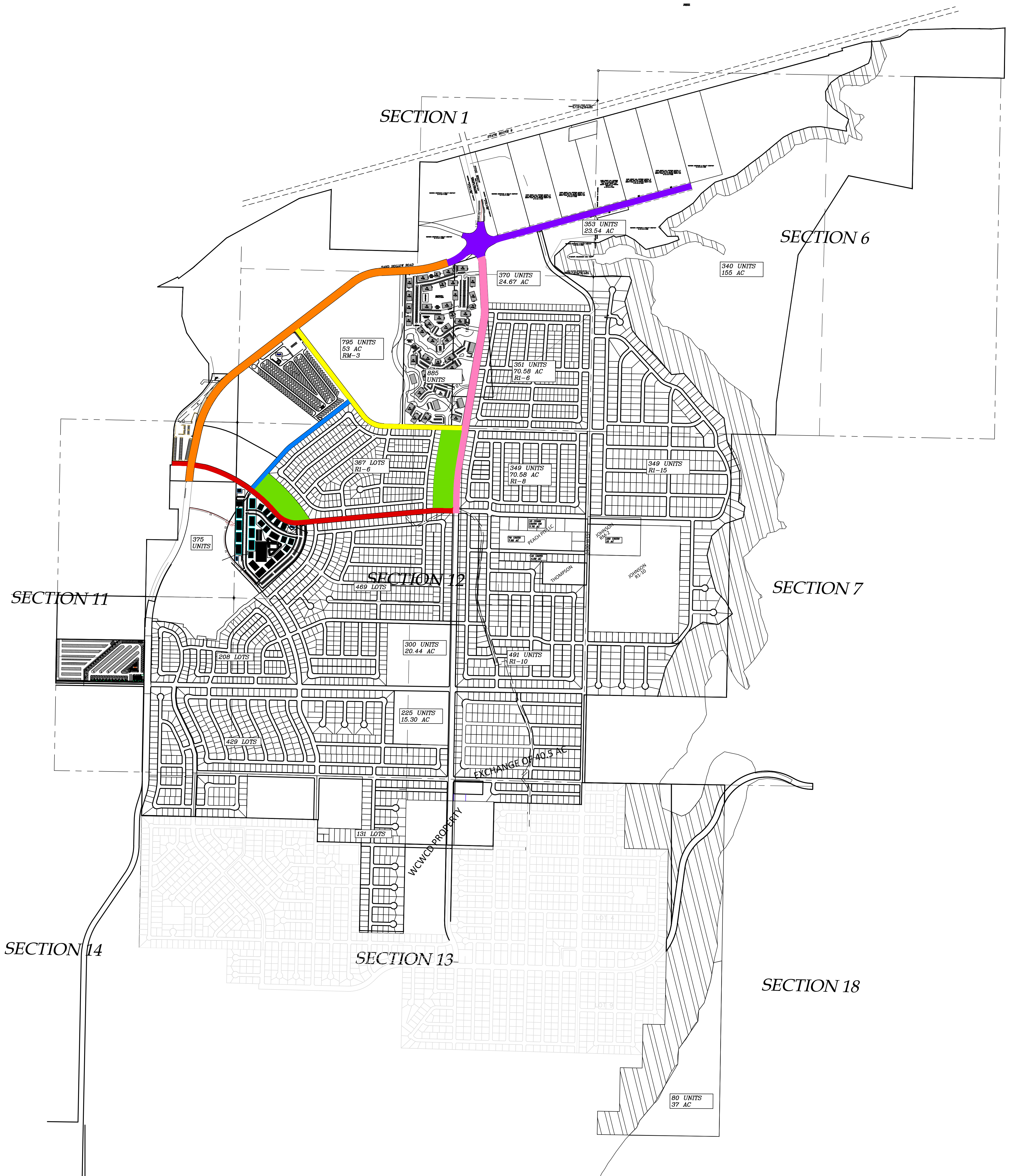
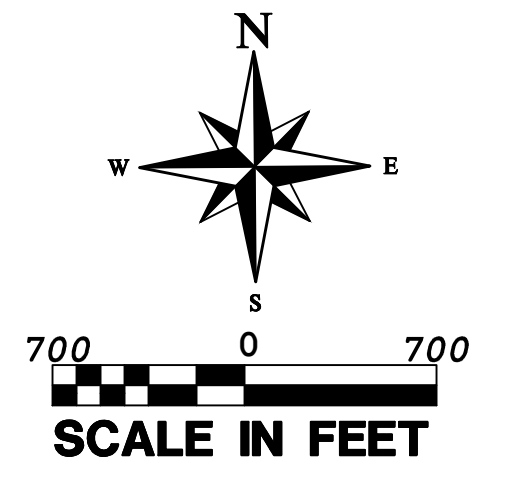

TABLE OF IMPROVEMENTS

MAP LOCATION	ITEM	P.I.D. PHASE 1 ESTIMATE			
A	ROAD A (70') South Leg	4552 LF	\$ 795.00	\$ 3,618,840.00	
B	ROAD B (70') North Leg	3272 LF	\$ 795.00	\$ 2,601,240.00	
C	ROAD C (90') 3700 West	3859 LF	\$ 875.00	\$ 3,376,625.00	
D	ROAD D (106') S.H. RD	5712 LF	\$ 998.00	\$ 5,700,576.00	
E	ROAD E (60') BEHIND RV's	2032 LF	\$ 765.00	\$ 1,554,480.00	
F	PARKS	14 ACRES	\$ 250,000.00	\$ 3,500,000.00	
G	STARGATE AVE - ROUND	1 LS	\$ 3,400,000.00	\$ 3,400,000.00	
	LESS CYPRUSS HALF	2500 LF	\$ (437.50)	\$ (1,093,750.00)	
				\$ 22,658,011.00	

MASTER PLAN MAP

copyright © 2013 provalue engineering inc.

JOB NO.
28-006
SHEET NO.
1 OF 1

DATE: 1/12/2011
SCALE: 1"=120'

PID PHASE 1 IMPROVEMENT MAP FOR:
SAND HOLLOW GATEWAY
SAND HOLLOW RD
HURRICANE, WASHINGTON COUNTY, UTAH

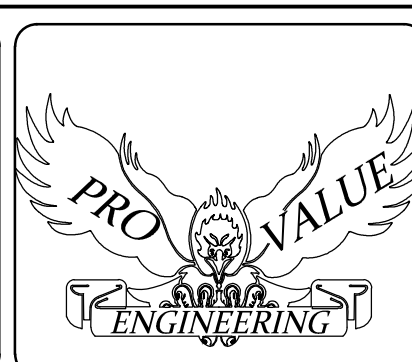

PROVALUE ENGINEERING, INC.
Engineers - Land Surveyors - Land Planners
20 South 850 West, Suite 1
Hurricane City, Utah 84717
Phone: (435) 668-8307

REVISIONS			
NO	DESCRIPTION	DATE	BY