

FOR SUBLEASE

PINNACLE CORPORATE PARK - BLDG 550

550 W CYPRESS CREEK ROAD | FORT LAUDERDALE, FL 33309



PROPERTY OVERVIEW

- 22,774 RSF sublease in Cypress Creek's premier office complex, Pinnacle Corporate Park.
- Hurricane code construction with newly built building amenities: fitness center, conferencing rooms, café, tenant lounge, on-site management, and EV charging stations.
- 4:1,000 parking ratio and one of two office buildings walking distance to Cypress Creek Tri-Rail Station.
- Fully built-out, furnished office space with open bullpen accommodating: one hundred two (102) workstations, eight (8) conferencing/huddlerooms, eight (8) private offices, data center, and break room(s).
- Sublease term through August 31, 2030
- Building top signage available*
**Subject to prime landlord's consent.*

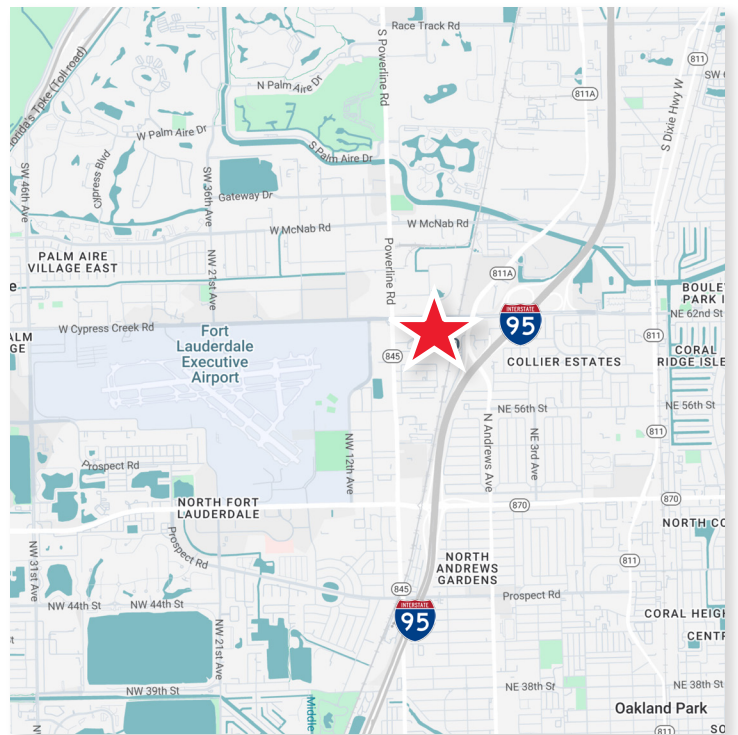

FOR SUBLEASE PINNACLE CORPORATE PARK - BLDG 550

550 W CYPRESS CREEK ROAD | FORT LAUDERDALE, FL 33309

FLOOR PLAN | SUITE 200 - 22,774 SF

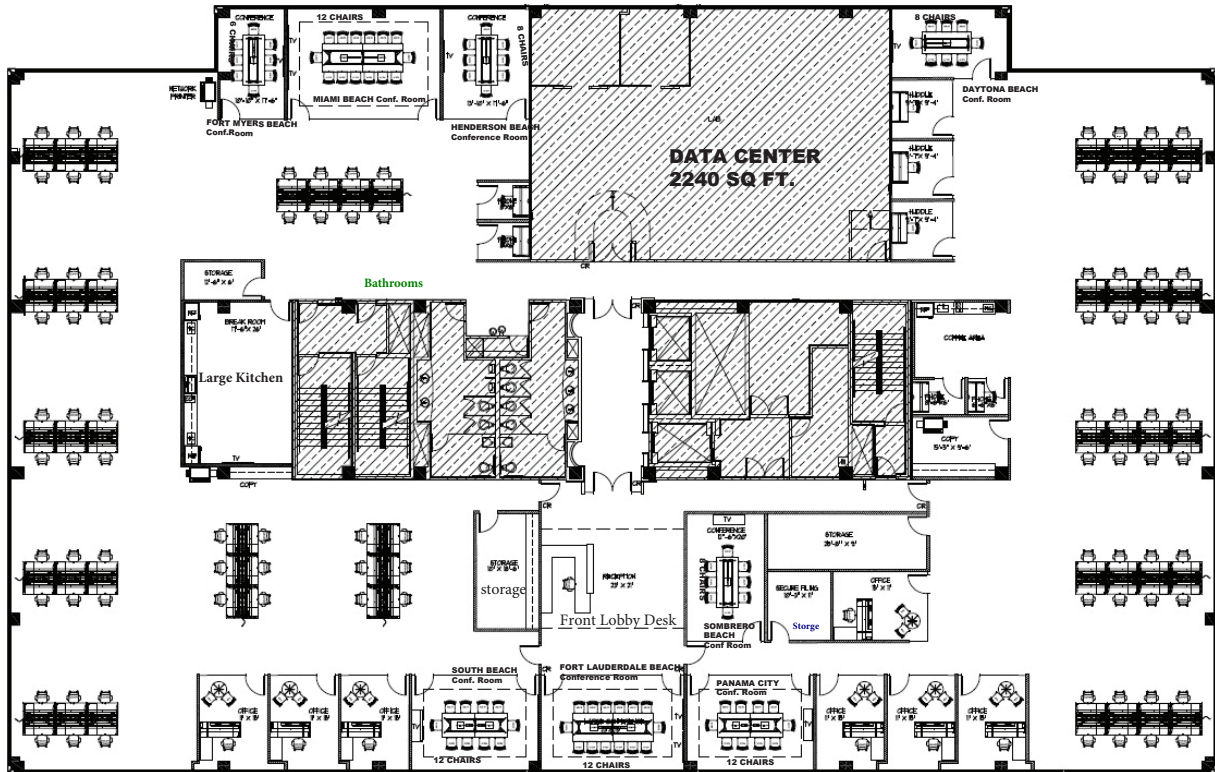

PHOTOGRAPHY



CONTACTS:

A.J. BELT
Managing Director
+1 954 377 0511
aj.belt@cushwake.com

JEFF HOLDING
Executive Director
+1 954 377 0512
jeff.holding@cushwake.com

TRENT SLATTERY
Senior Associate
+1 954 938 2619
trent.slattery@cushwake.com

OFFICE ADDRESS:
515 E Las Olas Boulevard
Fort Lauderdale, FL 33301

©2024 Cushman & Wakefield. All rights reserved. The information contained in this communication is strictly confidential. This information has been obtained from sources believed to be reliable but has not been verified. No warranty or representation, express or implied, is made as to the condition of the property (or properties) referenced herein or as to the accuracy or completeness of the information contained herein, and same is submitted subject to errors, omissions, change of price, rental or other conditions, withdrawal without notice, and to any special listing conditions imposed by the property owner(s). Any projections, opinions or estimates are subject to uncertainty and do not signify current or future property performance.

