



HILLSBOROUGH COUNTY PROPERTY APPRAISER

([//www.hcpafl.org](http://www.hcpafl.org))

Parcel Result

Folio: 148656-0000

PROPERTY RECORD CARD

**JOHNSON CASPER
JOHNSON SONIA
HOFFMANN LOLITA**

Mailing Address

11104 RICHLYNE ST
TEMPLE TERRACE, FL 33617-3020

Site Address

7411 N HUTTON PL, TAMPA

PIN:	A-28-28-19-46B-000046-00001.0
Folio:	148656-0000
Prior PIN:	
Prior Folio:	000000-0000
Tax District:	TA TAMPA
<u>Property Use:</u>	1000 VACANT COMM
Plat Book / Page:	<u>10 / 63</u>
Neighborhood:	214002.00 40th St N of River, S of Busch Area
Subdivision:	46B TEMPLE CREST UNIT NO 3

Value Summary & GIS Map

Value Summary

Taxing District	Market Value	Assessed Value	Exemptions	Taxable Value
County	\$223,044	\$211,008	\$0	\$211,008
Public Schools	\$223,044	\$223,044	\$0	\$223,044
Municipal	\$223,044	\$211,008	\$0	\$211,008
Other Districts	\$223,044	\$211,008	\$0	\$211,008

Note: This section shows Market Value, Assessed Value, Exemptions, and Taxable Value for taxing districts. Because of changes in Florida Law, it is possible to have different assessed and taxable values on the same property. For example, the additional \$25,000 Homestead Exemption and the non-homestead CAP do not apply to public schools, and the Low Income Senior Exemption only applies to countywide and certain municipal millages.

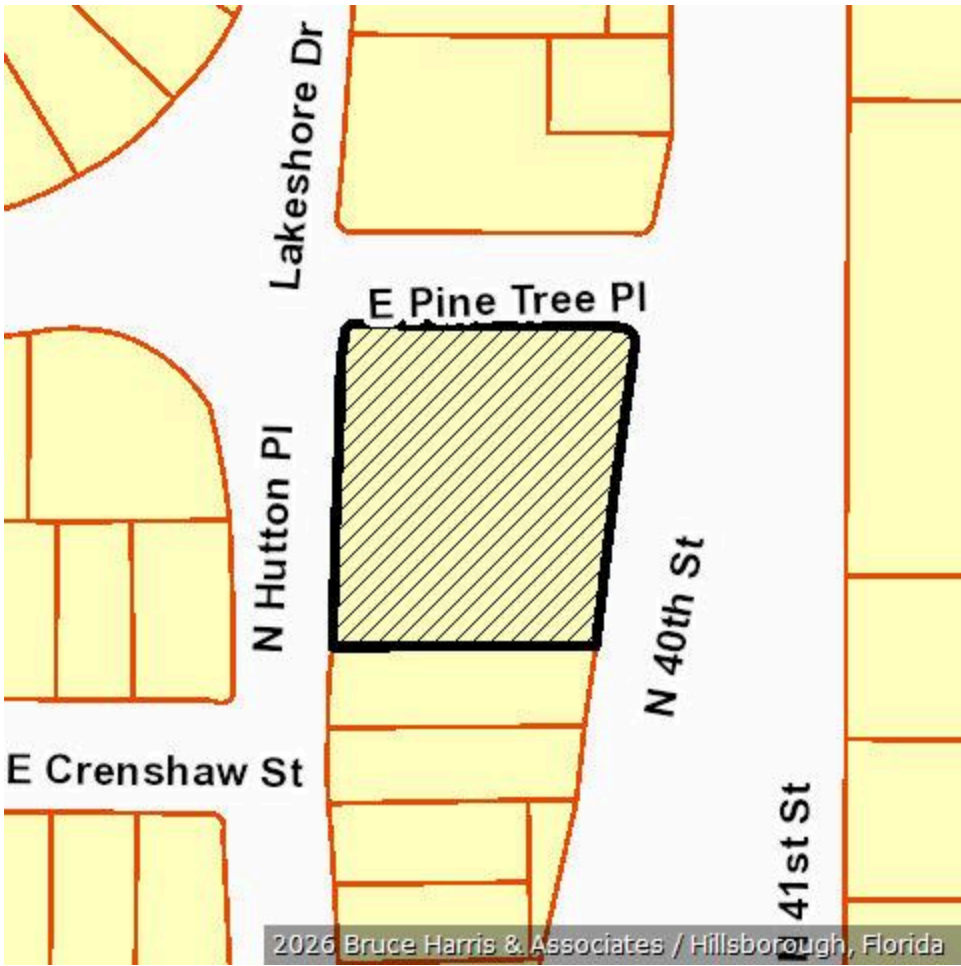

[View Map](#)

2026 Bruce Harris & Associates / Hillsborough, Florida

Sales History

Official Record Instrument	Date	Type	Inst	Qualified or Unqualified	Vacant or Improved	Sale Price
Book / Page	Number	Month	Year			
<u>25809 / 0043</u>	<u>2018217266</u>	05	2018	WD	Qualified	Vacant \$150,000
<u>25416 / 1955</u>	<u>2017473473</u>	12	2017	PR	Unqualified	Vacant \$100
<u>1490 / 0702</u>		08	1965	FD	Unqualified	Vacant \$0

Land Lines

LN	Use Code	Description	Zone	Front	Depth	Unit	Type	Total Land Units	Land Value
1	COE2	Comm Class 5	CG	0	0	SF	SQUARE FEET	31,195.00	\$223,044.00

Legal Lines

LN	Legal Description
1	TEMPLE CREST UNIT NO 3 LOTS 1 2 3 4 & LOTS 42 TO 49 INCL & CLOSED ALLEY ABUTTING SAID LOTS BLOCK 46 LESS RD R/W

Please note that property values on this site are continually being updated and are a work in progress throughout the year. The final values are certified in October of each year.

Last Updated: 3/20/2026
version: v20250422A