

BURTON CORNERS

2450-2480 S CENTER ROAD, BURTON, MI 48519

1,200 SF AVAILABLE

FOR LEASE



PETER ABRO

248.835.3134
pabro@keystonecres.com

GREG NEWMAN

248.406.7113
gnewman@keystonecres.com



BURTON CORNERS

2450-2480 S CENTER ROAD, BURTON, MI 48519

ADDITIONAL PHOTOS



PETER ABRO

248.835.3134

pabro@keystonecres.com

GREG NEWMAN

248.406.7113

gnewman@keystonecres.com



BURTON CORNERS

2450-2480 S CENTER ROAD, BURTON, MI 48519

TRADE AERIAL



Map data ©2024 Google Imagery ©2024 Airbus, CNES / Airbus, Landsat / Copernicus, Maxar Technologies

PETER ABRO

248.835.3134

pabro@keystonecres.com

GREG NEWMAN

248.406.7113

gnewman@keystonecres.com



BURTON CORNERS

2450-2480 S CENTER ROAD, BURTON, MI 48519

SITE PLAN



PETER ABRO

248.835.3134

pabro@keystonecres.com

GREG NEWMAN

248.406.7113

gnewman@keystonecres.com



BURTON CORNERS

2450-2480 S CENTER ROAD, BURTON, MI 48519

FLOOR PLAN

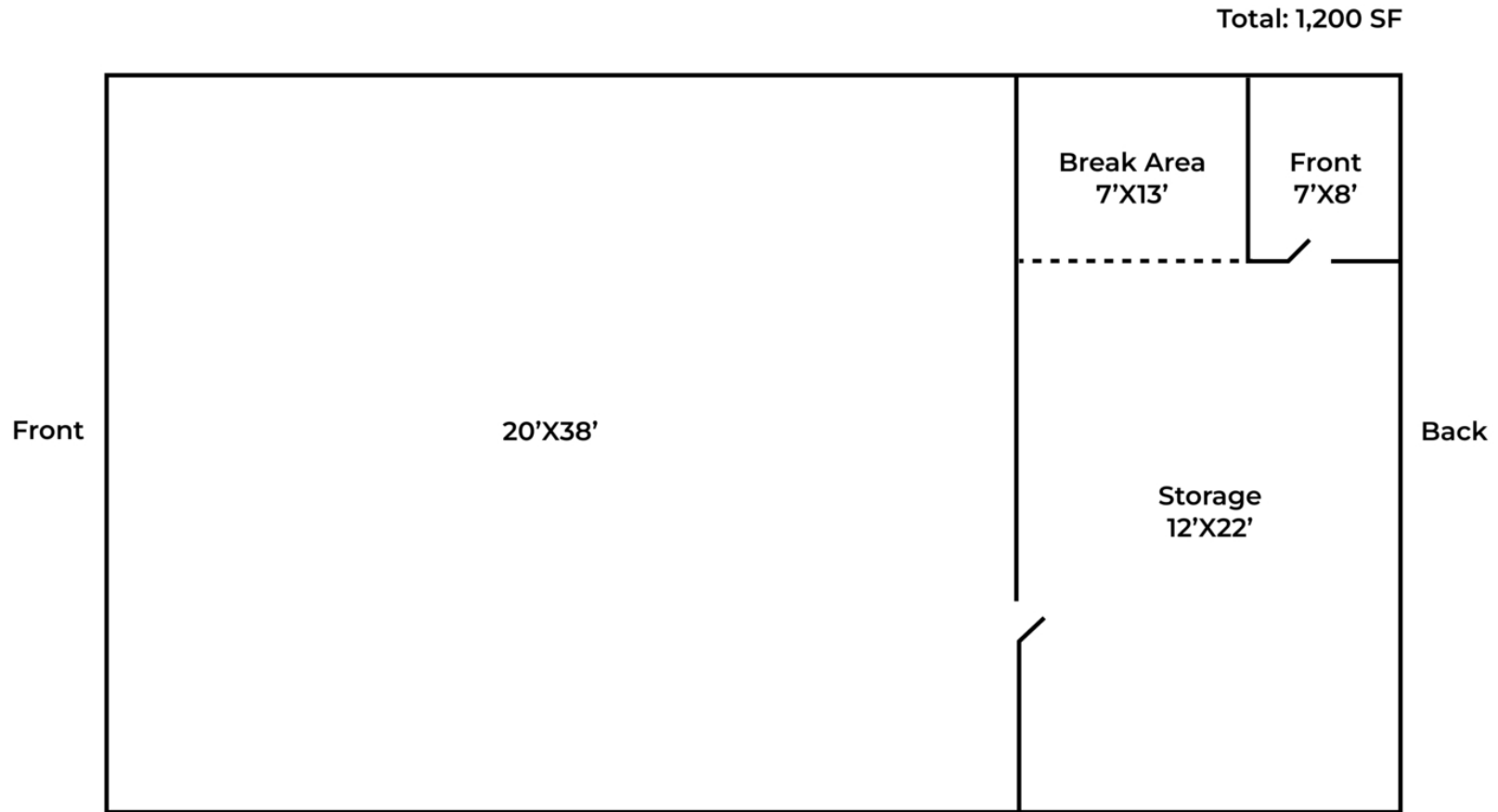

PETER ABRO

248.835.3134
pabro@keystonecres.com

GREG NEWMAN

248.406.7113
gnewman@keystonecres.com



BURTON CORNERS

2450-2480 S CENTER ROAD, BURTON, MI 48519

DEMOGRAPHICS

POPULATION	1 MILE	3 MILES	5 MILES
Total Population	4,971	49,940	137,486
Average Age	36.1	39.3	39.2
Average Age (Male)	30.7	37.0	38.5
Average Age (Female)	38.7	40.5	39.6

HOUSEHOLDS & INCOME	1 MILE	3 MILES	5 MILES
Total Households	2,789	24,599	67,071
# of Persons per HH	1.8	2.0	2.0
Average HH Income	\$35,974	\$46,573	\$51,681
Average House Value	\$44,011	\$69,966	\$106,855

RACE	1 MILE	3 MILES	5 MILES
Total Population - White	2,762	32,734	92,886
Total Population - Black	1,908	14,378	34,220
Total Population - Asian	34	433	1,691
Total Population - Hawaiian	0	7	25
Total Population - American Indian	38	103	286
Total Population - Other	79	282	2,004

* Demographic data derived from 2020 ACS - US Census



PETER ABRO

248.835.3134
pabro@keystonecres.com

GREG NEWMAN

248.406.7113
gnewman@keystonecres.com



BURTON CORNERS

2450-2480 S CENTER ROAD, BURTON, MI 48519

BROKERS



PETER ABRO

Advisor

pabro@keystonecres.com



GREG NEWMAN

Principal

gnewman@keystonecres.com

PETER ABRO

248.835.3134

pabro@keystonecres.com

GREG NEWMAN

248.406.7113

gnewman@keystonecres.com

