

RETAIL & RESTAURANT SPACE FOR LEASE

4-1543 KUHIO HWY

KAPAA, HI 96746



KAPAA TOWN MAP



NEIGHBORHOOD MAP



DEMOGRAPHICS (2024)

	3 Mile	5 Mile	15 Mile
ESTIMATED POPULATION	12,698	21,846	47,558
ESTIMATED AVG. HOUSEHOLD INCOME	\$114,486	\$127,314	\$126,865
ESTIMATED MEDIAN AGE	41.0	41.4	43.1

AREA HIGHLIGHTS

- 1,903 Visitor Units in the Kapaa Area
- Additional 1,736 Visitor Units in the nearby Lihue Area
- Kauai received 1.37 million visitors in 2024
- Total Kauai resident population (2024): 74,244

LEASING DIAGRAM

Not to scale

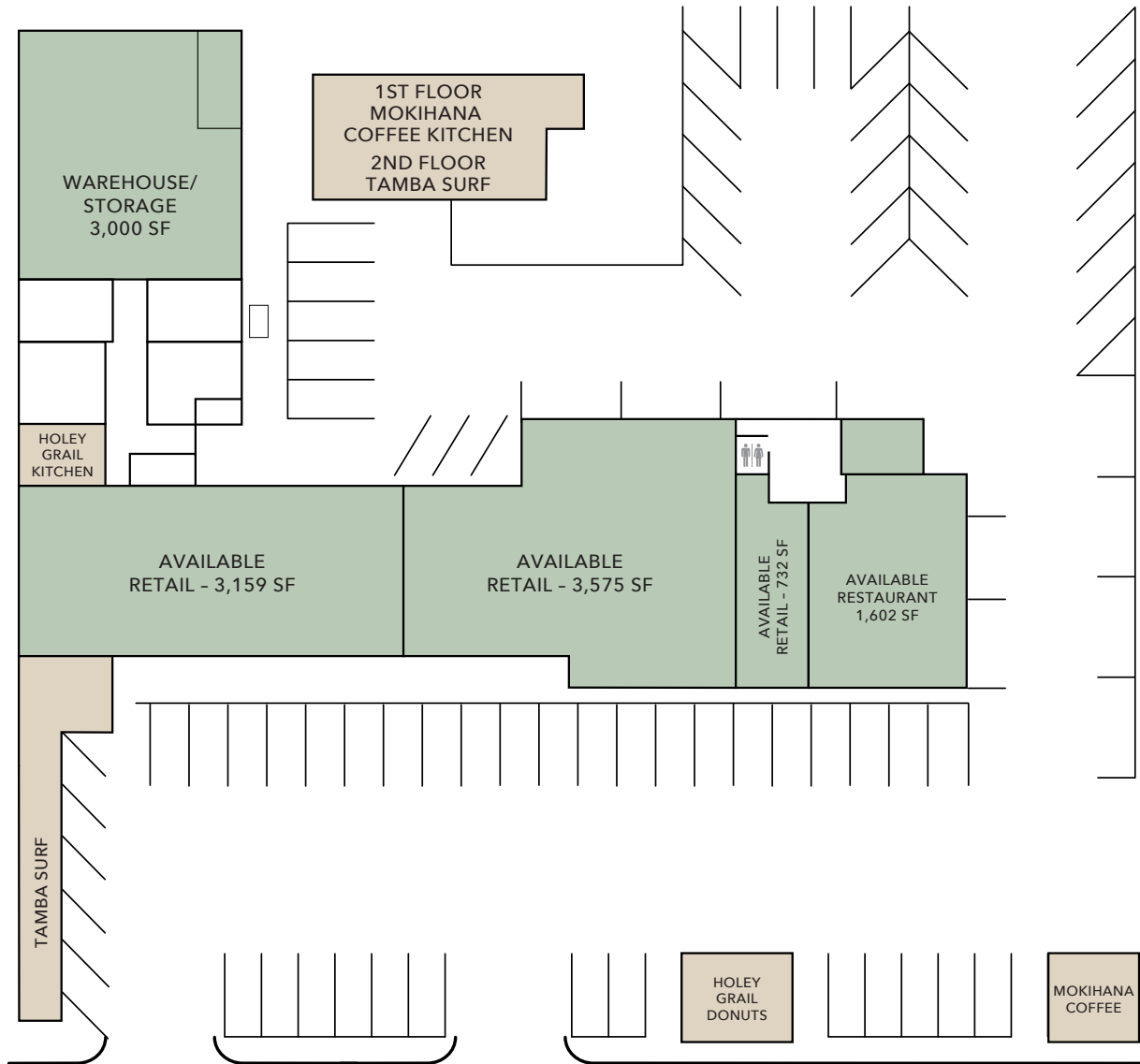

4-1543 KUHIO HWY This easily accessible property is located along the eastern shore of the beautiful island of Kauai in Kapaa Town and the home of the former Kojima Store, which served Kauai residents for many years. This is a great opportunity for a market or restaurant to have prime location along Kuhio Highway with ample parking.

PROPERTY HIGHLIGHTS:

SPACE AVAILABLE	500-12,000 SF
BASE RENT	Negotiable
CAM	\$1.00 PSF/Mo
PERCENTAGE RENT	8%



