

46777 GRATIOT AVENUE  
CHESTERFIELD TOWNSHIP, MICHIGAN

RETAIL FOR SALE OR LEASE  
5,232 Square Feet Available



**SIGNATURE  
ASSOCIATES**  
KNOW SIGNATURE | KNOW RESULTS



## PROPERTY FEATURES

- 5,232 square feet available
- Turnkey restaurant with liquor license and FF&E available
- Great signage, visibility and curb appeal
- Abundant parking on 1.54-acre lot
- Many new developments in the area
- Lease Rate: \$12.00/sq. ft. NNN
- Sale Price: \$1,495,000 (\$285.74 sq. ft.)

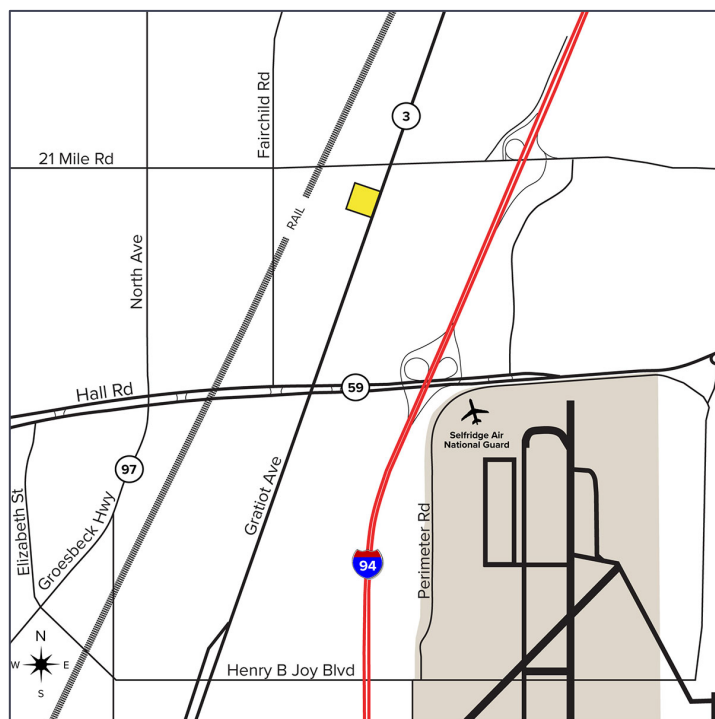

For more information, please contact:

**PETER VANDERKAAY**  
(248) 359 3837

[pvanderkaay@signatureassociates.com](mailto:pvanderkaay@signatureassociates.com)

**BEN WILKIEMEYER**  
(248) 359 0624

[bwilkiemeyer@signatureassociates.com](mailto:bwilkiemeyer@signatureassociates.com)

**SIGNATURE ASSOCIATES**  
One Towne Square, Suite 1200  
Southfield, MI 48076  
[www.signatureassociates.com](http://www.signatureassociates.com)

46777 Gratiot Avenue – Chesterfield Township, MI  
Retail For Sale or Lease

5,232  
Square Feet  
AVAILABLE

Site Plan

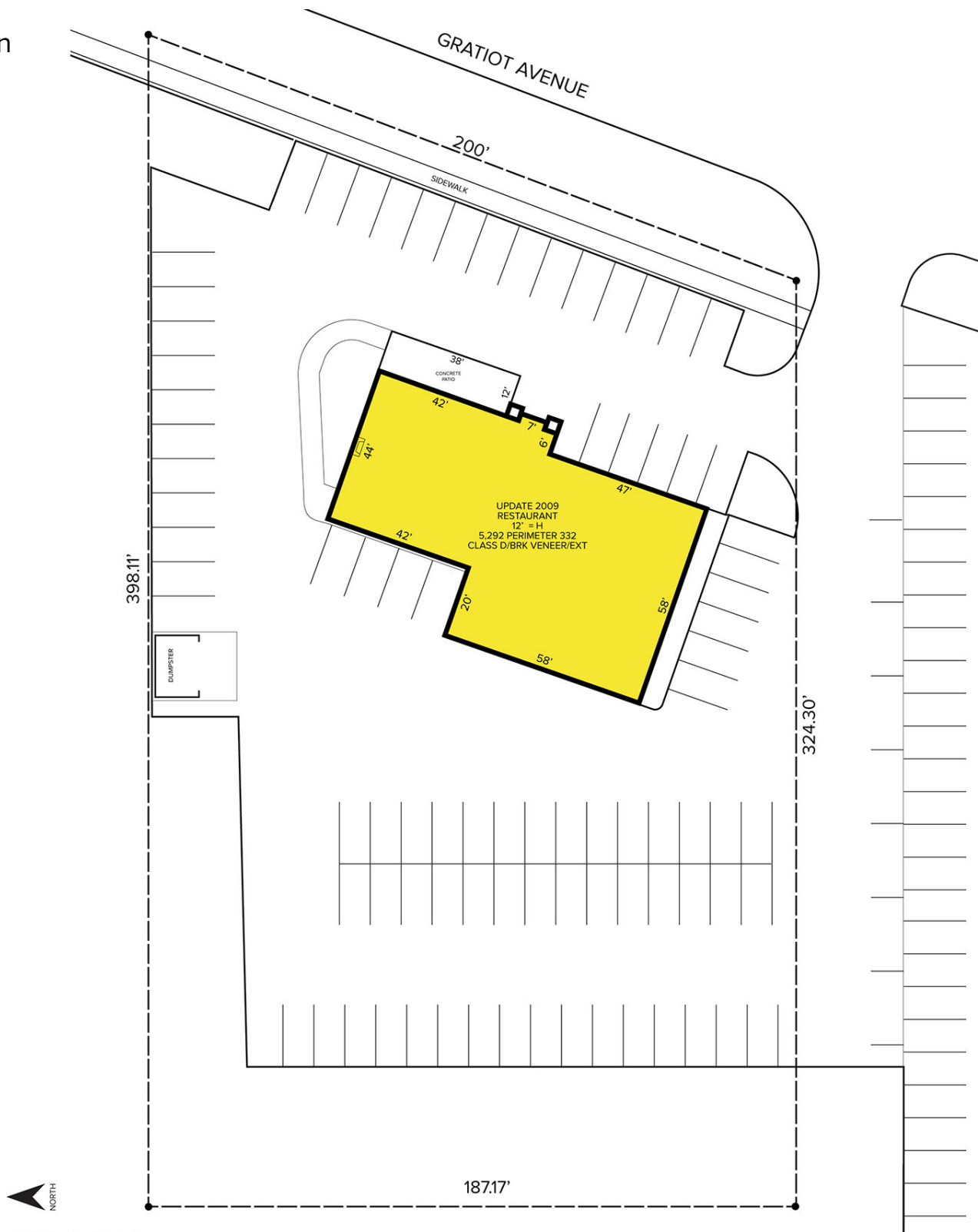

For more information, please contact:

**PETER VANDERKAAY**  
(248) 359 3837  
pvanderkaay@signatureassociates.com

**BEN WILKIEMEYER**  
(248) 359 0624  
bwilkiemeyer@signatureassociates.com

**SIGNATURE ASSOCIATES**  
One Towne Square, Suite 1200  
Southfield, MI 48076  
www.signatureassociates.com



# 46777 Gratiot Avenue – Chesterfield Township, MI

## Retail For Sale or Lease

5,232  
Square Feet  
AVAILABLE



### DEMOGRAPHICS

	POPULATION	MED. HH INCOME
1 MILE	6,219	\$101,485
3 MILE	53,437	\$85,410
5 MILE	154,356	\$91,930

### TRAFFIC COUNTS (TWO-WAY)

38,388	Gratiot Ave. N. of 21 Mile Rd.
32,814	Gratiot Ave. S. of 21 Mile Rd.
27,649	21 Mile Rd. E. of Gratiot Ave.
27,178	21 Mile Rd. W. of Gratiot Ave.



For more information, please contact:

**PETER VANDERKAAY**

(248) 359 3837

[pvanderkaay@signatureassociates.com](mailto:pvanderkaay@signatureassociates.com)

**BEN WILKIEMEYER**

(248) 359 0624

[bwilkiemeyer@signatureassociates.com](mailto:bwilkiemeyer@signatureassociates.com)

**SIGNATURE ASSOCIATES**

One Towne Square, Suite 1200

Southfield, MI 48076

[www.signatureassociates.com](http://www.signatureassociates.com)