



Accelerating success.



FOR SUBLEASE

# Premium medical office space available for sublease

**James Bailey**  
Executive Vice President  
+1 973 299 3013  
[James.Bailey@colliers.com](mailto:James.Bailey@colliers.com)

**Bryn Cinque**  
Vice Chair  
+1 973 299 3016  
[Bryn.Cinque@colliers.com](mailto:Bryn.Cinque@colliers.com)

# Essex Square

## 184 Essex Street

### Lodi, New Jersey

#### Details

- 5,084 square feet
- Term through January 16, 2029
- Fully built out urgent-care/medical space
- Furniture available
- 10 exam rooms
- X-ray/imaging room
- Large reception and employee lounge
- Ample parking on-site
- Directly off Route 17 with easy access to Route 80, Route 46, Route 4 and Garden State Parkway



#### Floor Plan

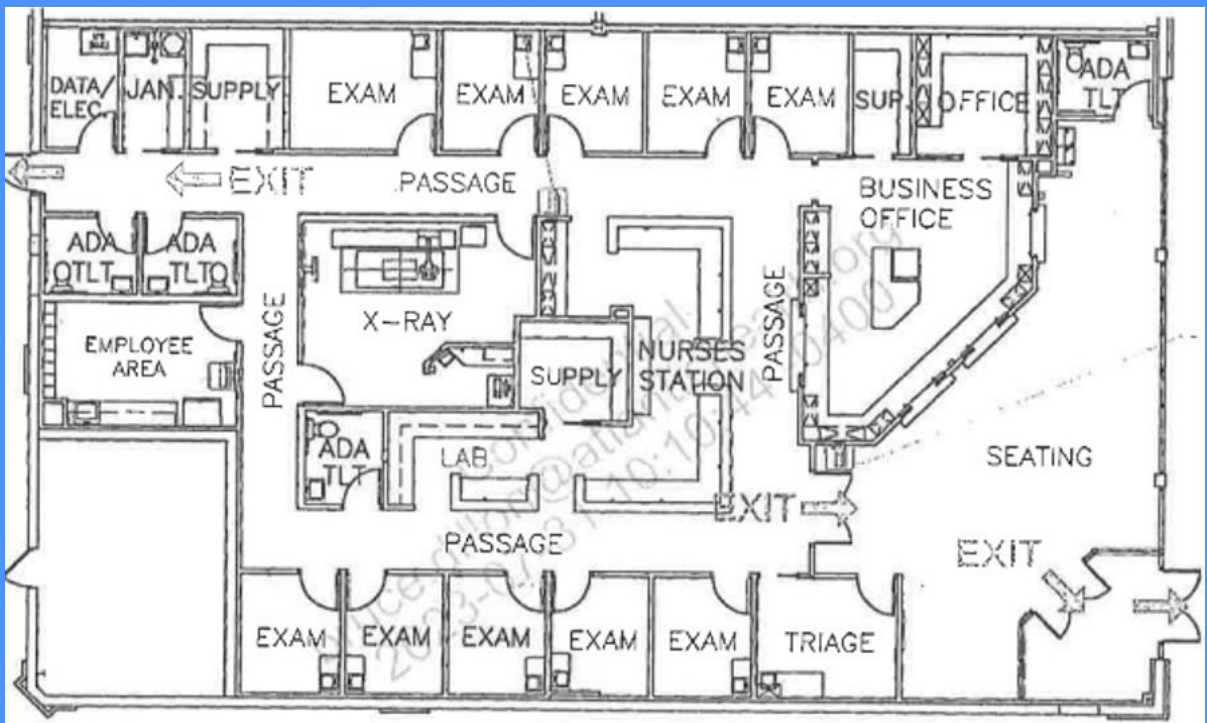









Contact us:

**James Bailey**  
Executive Vice President  
+1 973 299 3013  
James.Bailey@colliers.com

**Bryn Cinque**  
Vice Chair  
+1 973 299 3016  
Bryn.Cinque@colliers.com



**Colliers International**  
20 Waterview Boulevard  
Parsippany, NJ 07054  
+1 973 299 3000

This document/email has been prepared by Colliers for advertising and general information only. Colliers makes no guarantees, representations or warranties of any kind, expressed or implied, regarding the information including, but not limited to, warranties of content, accuracy and reliability. Any interested party should undertake their own inquiries as to the accuracy of the information. Colliers excludes unequivocally all inferred or implied terms, conditions and warranties arising out of this document and excludes all liability for loss and damages arising there from. This publication is the copyrighted property of Colliers and /or its licensor(s). © 2025. All rights reserved. This communication is not intended to cause or induce breach of an existing listing agreement. Colliers International NJ.

Colliers.com