



RETAIL PROPERTY FOR LEASE

550 OYSTER POINT ROAD

550 OYSTER POINT ROAD, NEWPORT NEWS, VA 23602



550 OYSTER POINT ROAD

550 OYSTER POINT ROAD, NEWPORT NEWS, VA 23602

PROPERTY OVERVIEW



OFFERING SUMMARY

Available SF:	2,790 SF
Lease Rate:	Contact Agent
Lease Type:	NNN
Building Size:	14,220 SF
Zoning:	C-1

PROPERTY HIGHLIGHTS

- Prime location near the intersection of Jefferson Avenue and Oyster Point Road
- Suite G; 2,790 SF endcap next to FedEx - Available Now
- Monument signage available
- 30,000 VPD

AVAILABLE SPACES	SF
Suite G	2,790 SF

DEMOGRAPHICS	1 Mile	3 Miles	5 Miles
Total Households:	4,217	31,175	65,583
Total Population:	10,049	77,232	166,246
Average HH Income:	\$66,708	\$67,626	\$70,183

550 OYSTER POINT ROAD

550 OYSTER POINT ROAD, NEWPORT NEWS, VA 23602

SITE PLAN

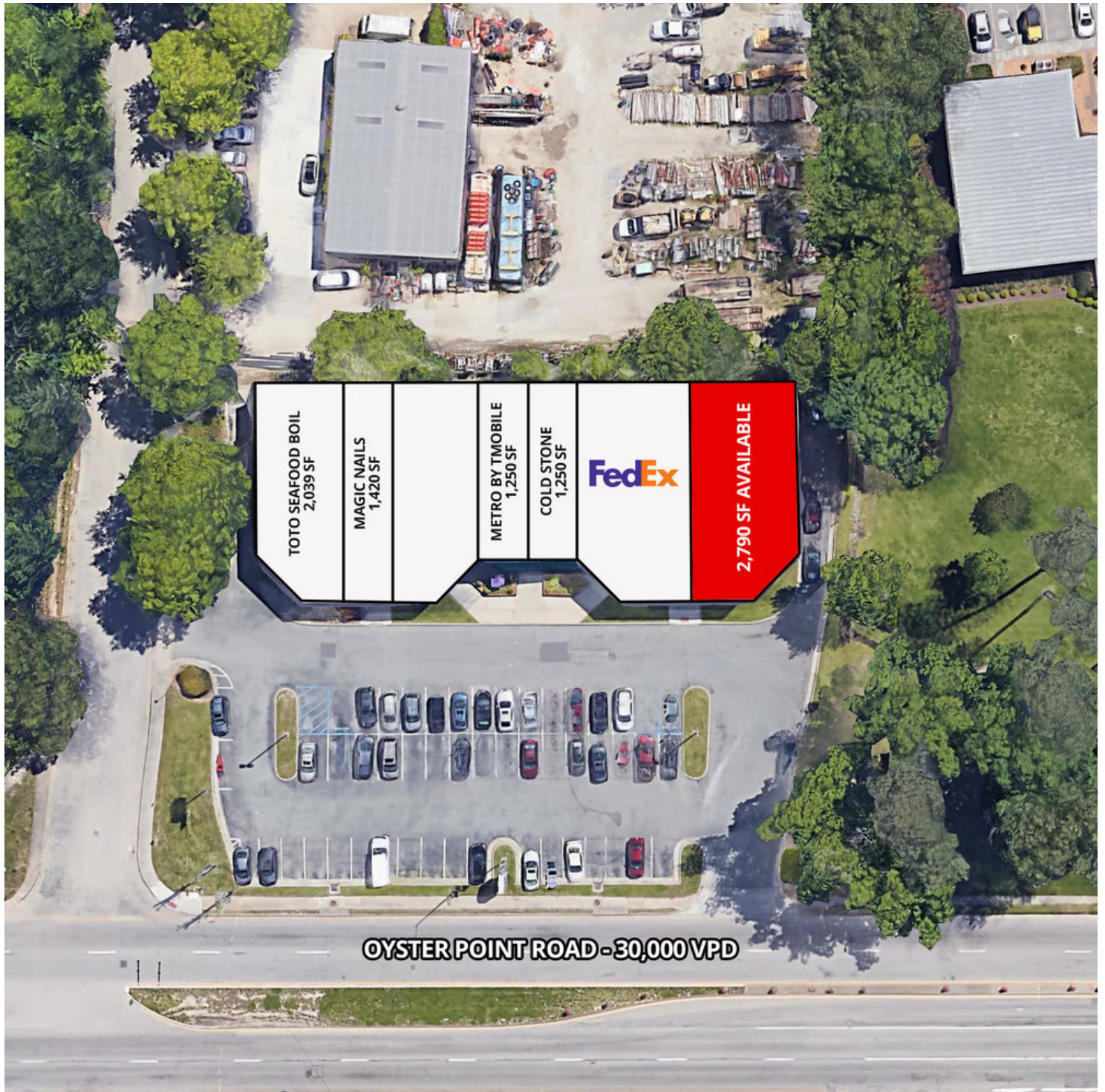

550 OYSTER POINT ROAD

550 OYSTER POINT ROAD, NEWPORT NEWS, VA 23602

CORNER SUITE FLOOR PLAN



Approx location of sewer stub-up

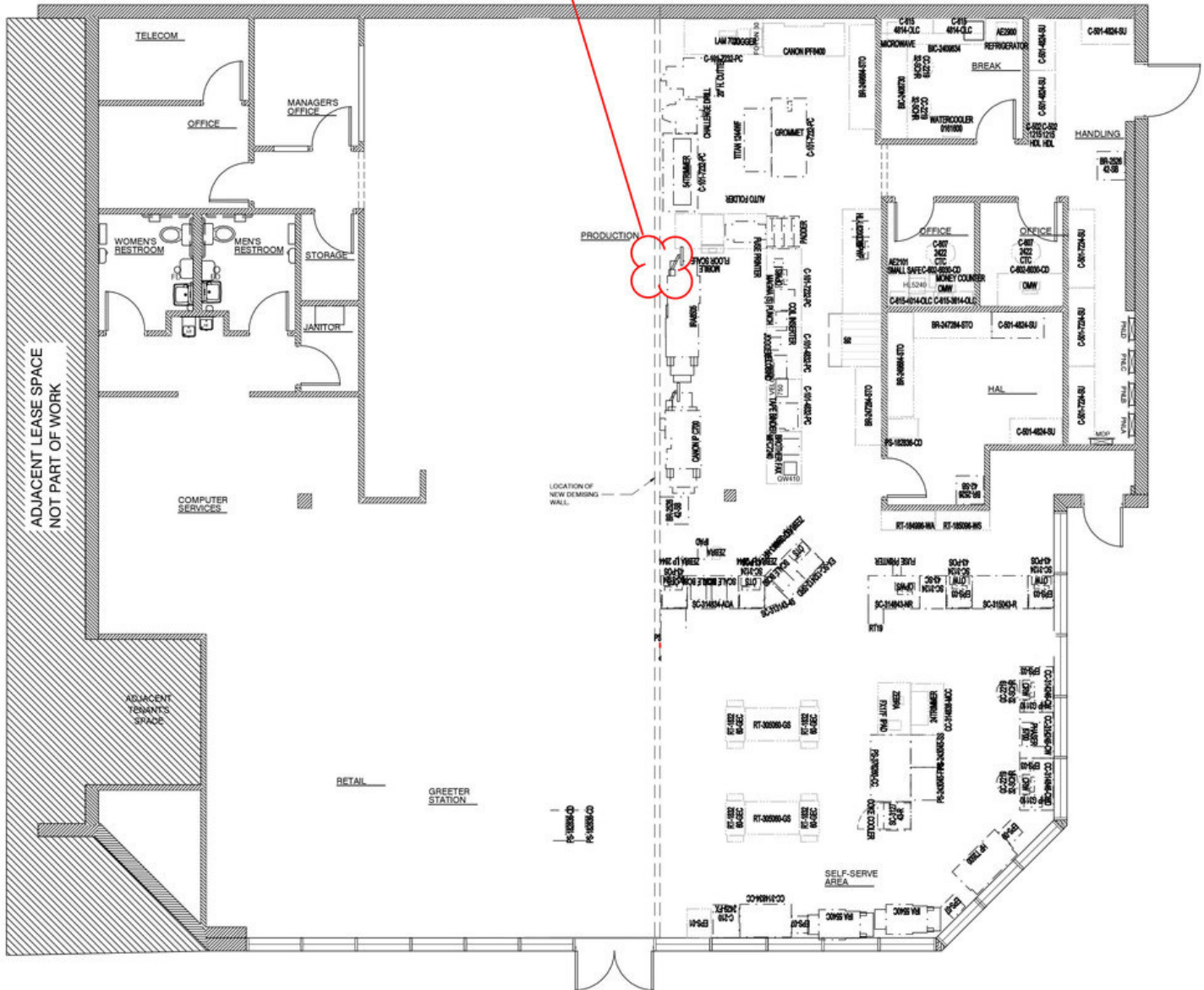

550 OYSTER POINT ROAD

550 OYSTER POINT ROAD, NEWPORT NEWS, VA 23602

RETAILER MAP



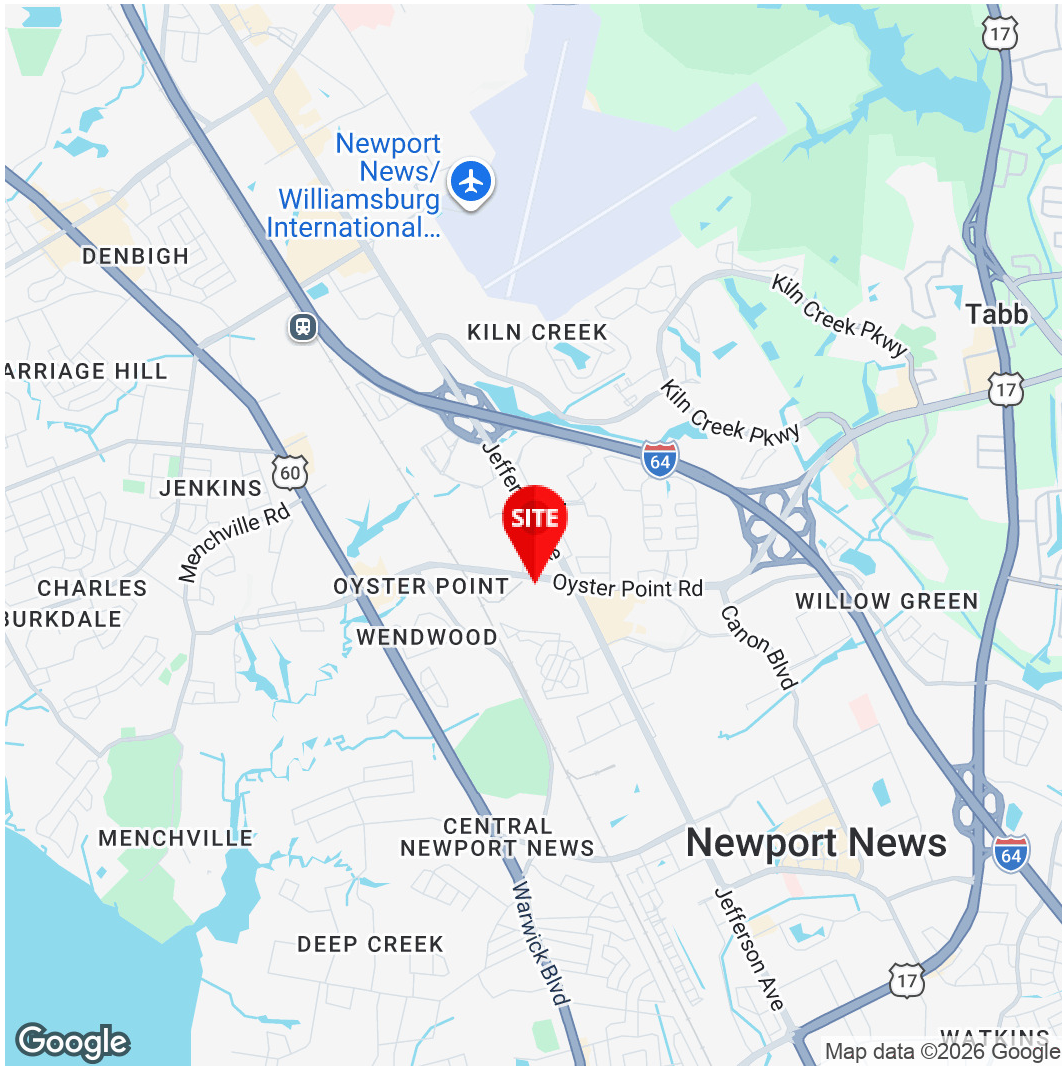

Neal Sadler
 Retail Sales And Leasing
 Associate
 757.333.4333
 Neal.Sadler@Divaris.Com

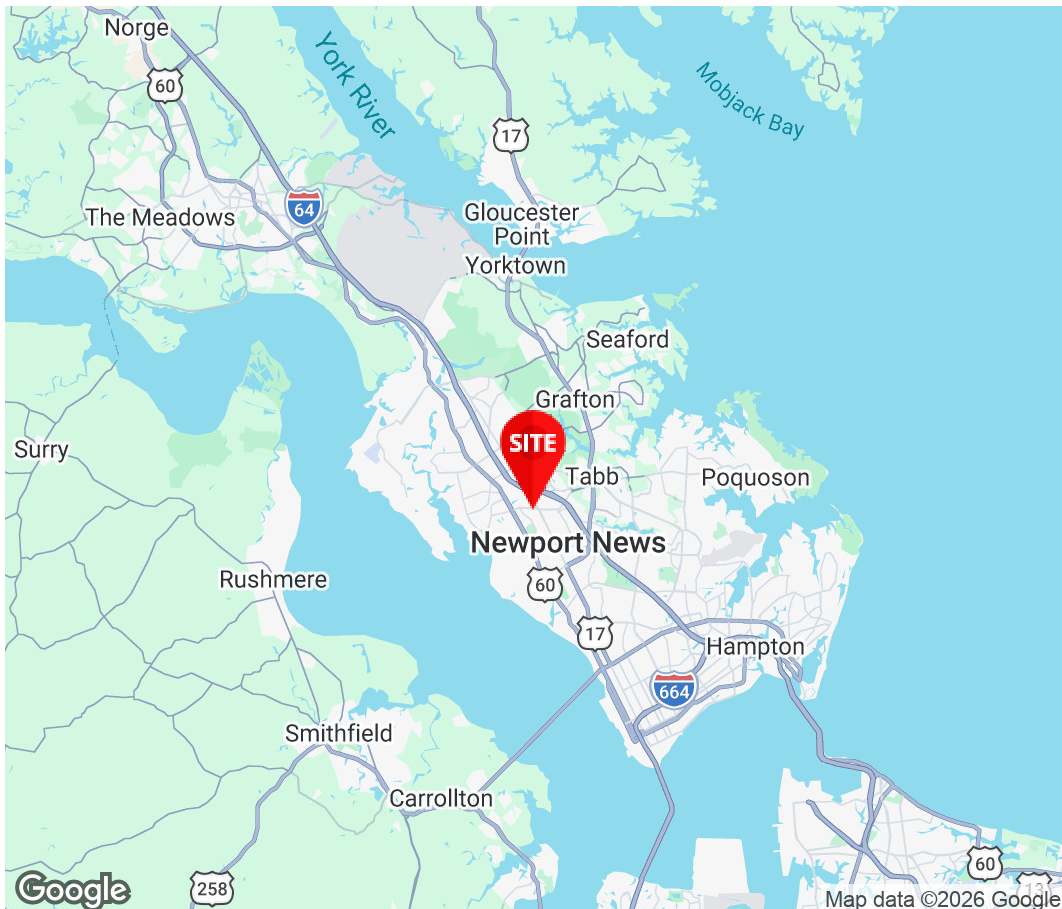

The information contained herein should be considered confidential and remains the sole property of Divaris Real Estate, Inc. at all times. Although every effort has been made to ensure accuracy, no liability will be accepted for any errors or omissions. Disclosure of any information contained herein is prohibited except with the express written permission of Divaris Real Estate, Inc.