

# FOR LEASE

1,429-5,737 SF | \$1.35/SF/MO. NNN

## Nolan Town Center Retail/Fitness Space

915 SW Rimrock Way, Redmond, OR 97756



### PROPERTY DETAILS

**Bldg. 2A:** 1,429-5,737 SF  
**Rate:** \$1.35/SF/Mo. NNN  
**NNNs:** Est. at \$0.63/SF/Mo.  
**Parking:** Abundant on-site parking  
**Date Avail.:** January 1, 2025

### HIGHLIGHTS

- Turnkey fitness facility or can be converted to other retail use
- Center is located at a signalized intersection
- Across from Redmond High School and American Legion Park
- Excellent visibility and monument signage
- Join M&W Market, Starbucks, Cibelli's Pizza, McDonalds, Yo Wild, Fiesta Mazatlan, and more!

Jay Lyons, SIOR, CCIM | Russell Huntamer, CCIM  
Eli Harrison, Broker

600 SW Columbia St., Ste. 6100 | Bend, OR 97702  
541.383.2444 | [www.CompassCommercial.com](http://www.CompassCommercial.com)

COMPASS  
COMMERCIAL

REAL  
ESTATE  
SERVICES



# FOR LEASE

## 5,737 SF | \$1.35/SF/MO. NNN

# Nolan Town Center Retail/Fitness Space

## 915 SW Rimrock Way, Redmond, OR 97756

### APPROXIMATE FLOOR PLAN

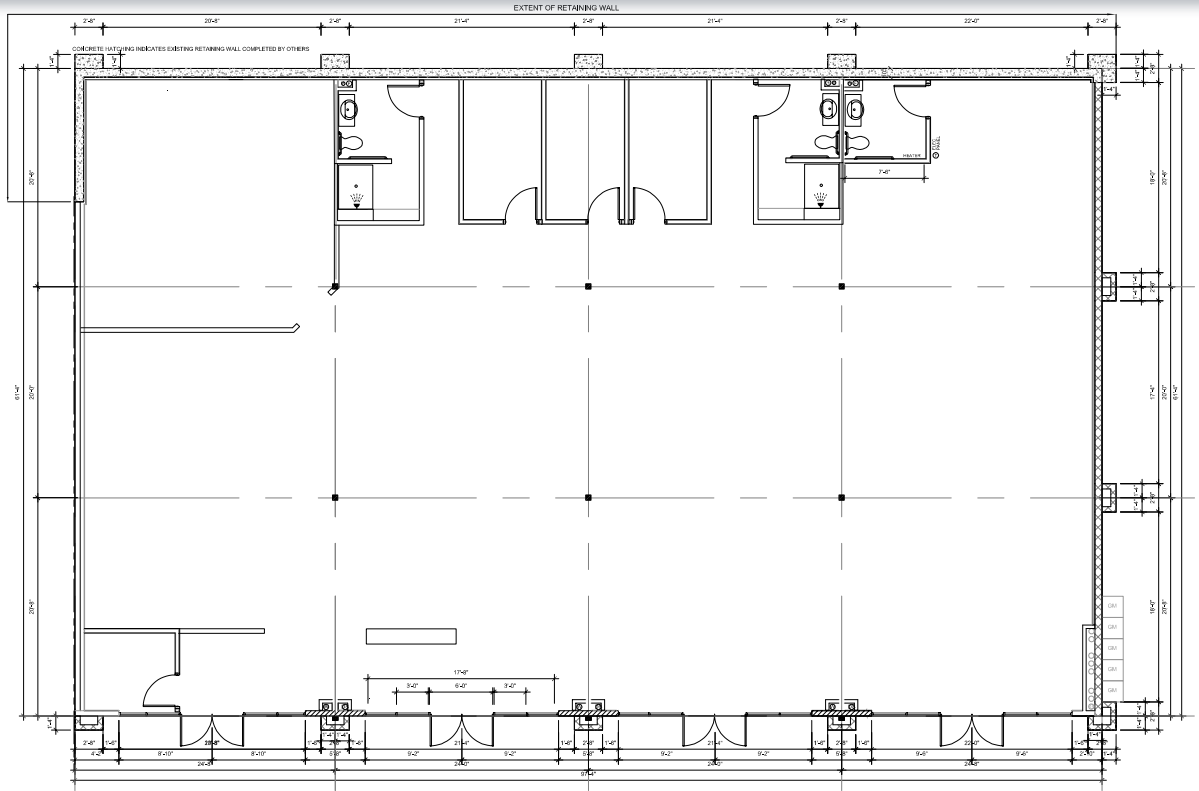

Brokers are licensed in the state of Oregon. This information has been furnished from sources we deem reliable, but for which we assume no liability. This is an exclusive listing. The information contained herein is given in confidence with the understanding that all negotiations pertaining to this property be handled through Compass Commercial Real Estate Services. All measurements are approximate.



**Jay Lyons, SIOR, CCIM**  
Partner, Principal Broker  
Cell 541.410.6519  
jlyons@compasscommercial.com



**Russell Huntamer, CCIM**  
Partner, Principal Broker  
Cell 541.419.2634  
rh@compasscommercial.com



**Eli Harrison**  
Broker  
Cell 541.977.2890  
eharrison@compasscommercial.com

**COMPASS COMMERCIAL**  
REAL ESTATE SERVICES