

Specifications

±0.43 Acres Vacant Land
LOT SIZE

Block 4305, Lot 34.01
BLOCK & LOT

22,155
AVE DAILY TRAFFIC COUNT

BB Industrial District Business Retail
ZONING

Nearby Amenities Include Banks,
Restaurants, Groceries, Pharmacies,
Schools
NOTES

\$16,986.76
TAXES (2025)

\$899,000
SALE PRICE

Across From NJ Bus 114 to New York
0.9 Miles to GSP Exit 139
1.1 Miles to Route 22
2.3 Miles to I-78
ACCESSIBILITY

For additional property information or to arrange an inspection, please contact the following brokers:

Jason M. Crimmins, CCIM, SIOR, *President*, 973.379.6644 x 122, jmcrimmins@blauberg.com
Alessandro (Alex) Conte, CCIM, SIOR, *Executive Vice President*, 973.379.6644 x 131, acont@blauberg.com
Peter J. Murano, Jr., *Managing Executive Director*, 973.379.6644 x 114, pjmurano@blauberg.com

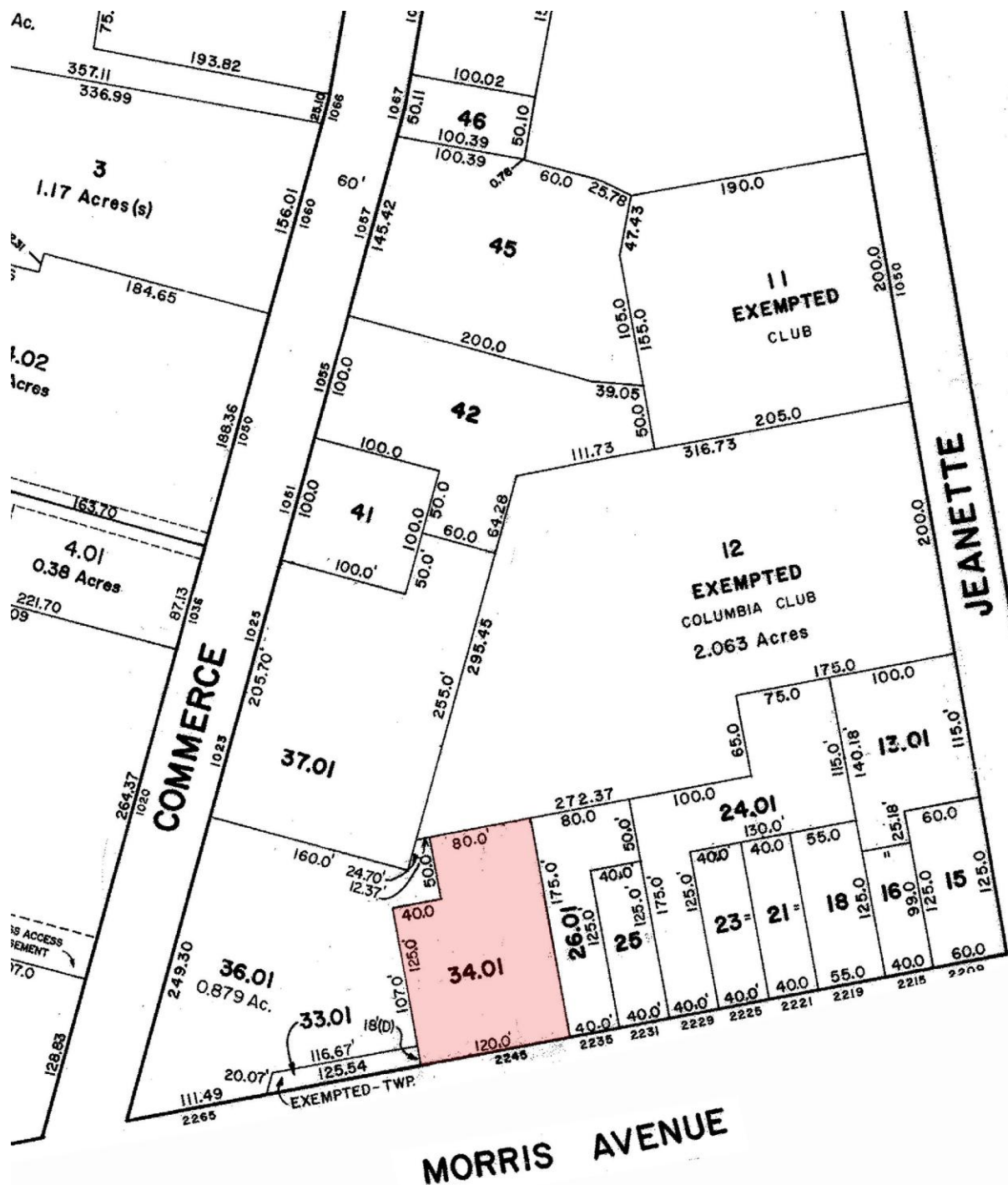

For additional property information or to arrange an inspection, please contact the following brokers:

Jason M. Crimmins, CCIM, SIOR, *President*, 973.379.6644 x 122, jmcrimmins@blauberg.com
 Alessandro (Alex) Conte, CCIM, SIOR, *Executive Vice President*, 973.379.6644 x 131, aconte@blauberg.com
 Peter J. Murano, Jr., *Managing Executive Director*, 973.379.6644 x 114, pjmurano@blauberg.com

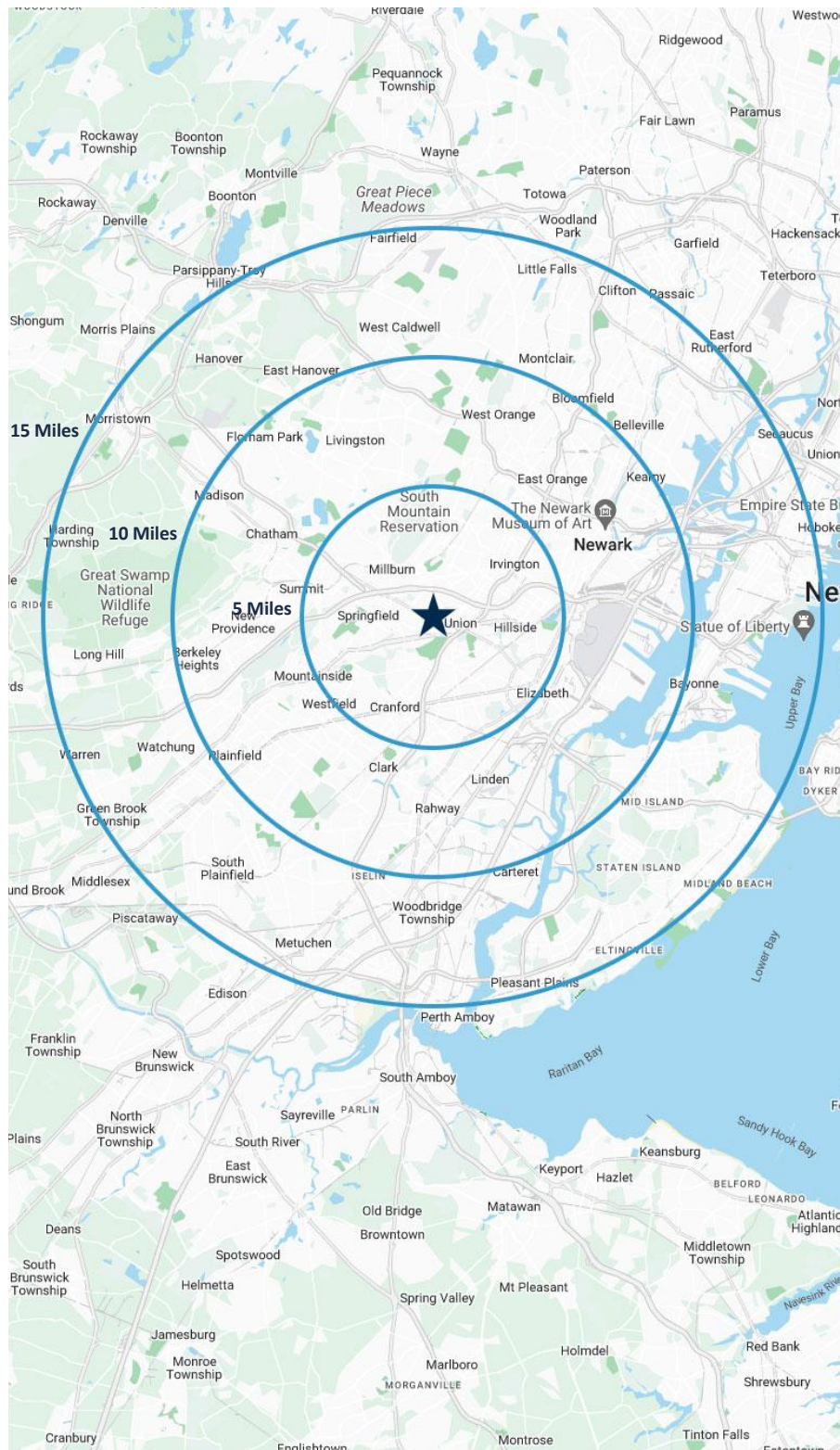

5 MILES

- Total Population: 610,939
- Households: 222,143
- Median Household Income: \$104,034
- Average Household Size: 2.7
- Transportation to Work: 320,978
- Labor Force: 484,419

10 MILES

- Total Population: 1.84M
- Households: 674,174
- Median Household Income: \$105,266
- Average Household Size: 2.7
- Transportation to Work: 951,404
- Labor Force: 1.47M

15 MILES

- Total Population: 3.9M
- Households: 1.48M
- Median Household Income: \$113,002
- Average Household Size: 2.6
- Transportation to Work: 2.06M
- Labor Force: 3.16M

For additional property information or to arrange an inspection, please contact the following brokers:

Jason M. Crimmins, CCIM, SIOR, *President*, 973.379.6644 x 122, jmcrimmins@blauberg.com
Alessandro (Alex) Conte, CCIM, SIOR, *Executive Vice President*, 973.379.6644 x 131, aconte@blauberg.com
Peter J. Murano, Jr., *Managing Executive Director*, 973.379.6644 x 114, pjmurano@blauberg.com

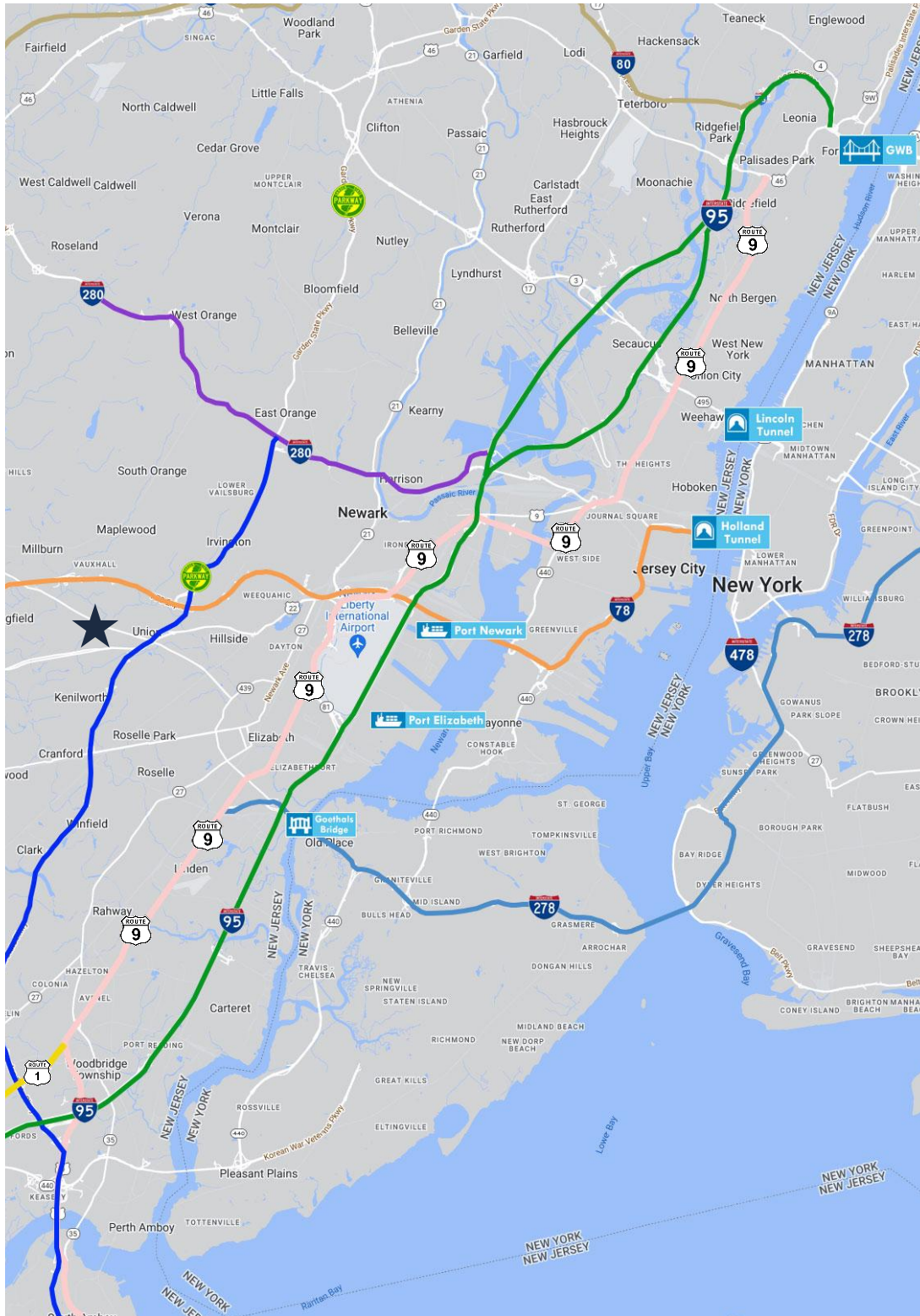

ACCESSIBILITY



0.9 MI
GSP Exit 139



1.1 MI
Route 22



2.3 MI
I-78 Exit 49



6.0 MI
US Hwy 1 & 9



6.7 MI
Newark Airport



7.35 MI
I-95 Exit 14



8.0 MI
Ports Newark
& Elizabeth



8.2 MI
Penn Station



14.5 MI
Holland Tunnel



18.5 MI
Lincoln Tunnel

For additional property information or to arrange an inspection, please contact the following brokers:

Jason M. Crimmins, CCIM, SIOR, *President*, 973.379.6644 x 122, jmcrimmins@blauberg.com
Alessandro (Alex) Conte, CCIM, SIOR, *Executive Vice President*, 973.379.6644 x 131, aconte@blauberg.com
Peter J. Murano, Jr., *Managing Executive Director*, 973.379.6644 x 114, pjmurano@blauberg.com

The information contained herein has been obtained from sources considered to be reliable, but no guarantee of its accuracy is made by this company. In addition, no representation is made respecting zoning, condition of title, dimensions, or any matters of a legal or environmental nature. Such matters should be referred to legal counsel for determination. Terms and conditions are subject to change without prior notice. Subject to errors and omissions.