

Silverstone
Commercial



MEDICAL/PROFESSIONAL OFFICES

950 S. Bascom Avenue • San Jose, California

The information contained herein has been obtained from sources we deem reliable. We cannot, however, assume responsibility for its accuracy.

950 S. Bascom Avenue • San Jose, California

FOR LEASE

Available Suites

<u>Floor</u>	<u>Suite</u>	<u>SF Available</u>
(Divisible to 1,000± SF)	1011	2,220±SF
	1017	2,702± SF
2nd Floor	2011	2,342± SF
	2122	3,519± SF
3rd Floor	3009	2,017±SF
	3010	2,903± SF
	3013	1,902± SF

- Centrally located with convenient access to Hwys. 17 & 280 and public transportation.
- Minutes from Downtown San Jose and San Jose International Airport.
- Three Story Class B Building with plenty of surface parking and under the building reserved parking.
- Available office suites range from 312± RSF to 3,519± RSF.
- New paint and carpet, with additional TI allowances available
- Property Manager on Site
- 24 Hour Access
- Close proximity to amenities.
- Call to Tour and For Pricing
- Medical Potential

The information contained herein has been obtained from sources we deem reliable. We cannot, however, assume responsibility for its accuracy.

950 S. Bascom Avenue • San Jose, California

Office Suites Available with 30—Day Notice

Available Suites

ES-106..... 480 SF ES-123.... 354 SF

ES-109..... 385 SF ES-125....355 SF

Executive Spaces Rates:

\$4.00/sf for Perimeter Spaces

\$3.25/sf for Internal Spaces

The information contained herein has been obtained from sources we deem reliable. We cannot, however, assume responsibility for its accuracy.

950 S. Bascom Avenue • San Jose, California

Executive Suites

First Floor Office Suites:

- 1011 2,220± SF
- 1017 2,702± SF
(Divisible to 1,000± SF)

BASCOM BUSINESS CENTER
950 S. BASCOM AVENUE
SAN JOSE, CA

FIRST FLOOR
 (As Measured: November 2019)
 (Last Updated: October 2020)

LEASE PLAN

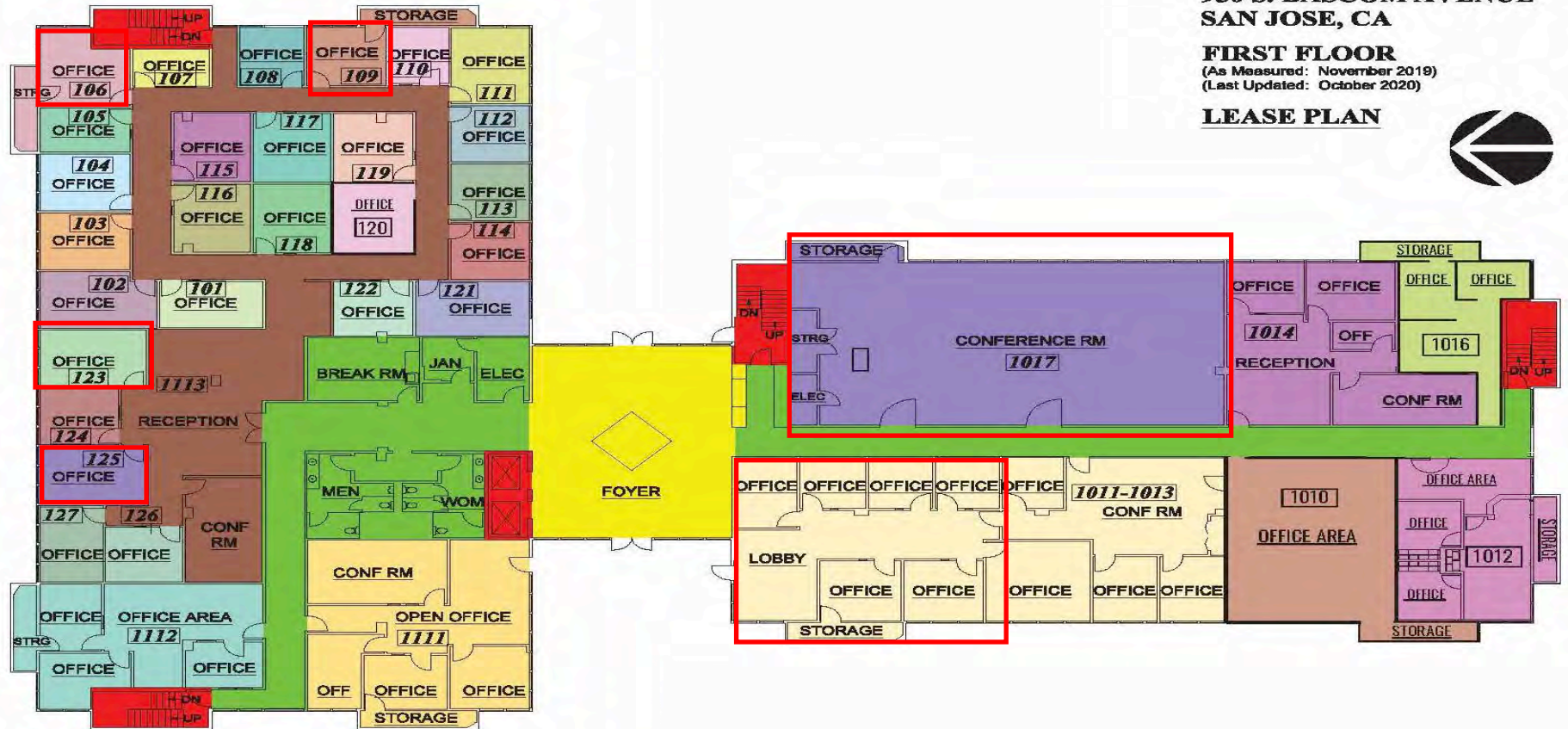

The information contained herein has been obtained from sources we deem reliable. We cannot, however, assume responsibility for its accuracy.

950 S. Bascom Avenue • San Jose, California

Second Floor Office Suites:

Suite 2011: 2,342±SF

Suite 2122: 3,519± SF

BASCOM BUSINESS CENTER
950 S. BASCOM AVENUE
SAN JOSE, CA

SECOND FLOOR
(As Measured: November 2019)
(Last Updated: October 2020)

LEASE PLAN

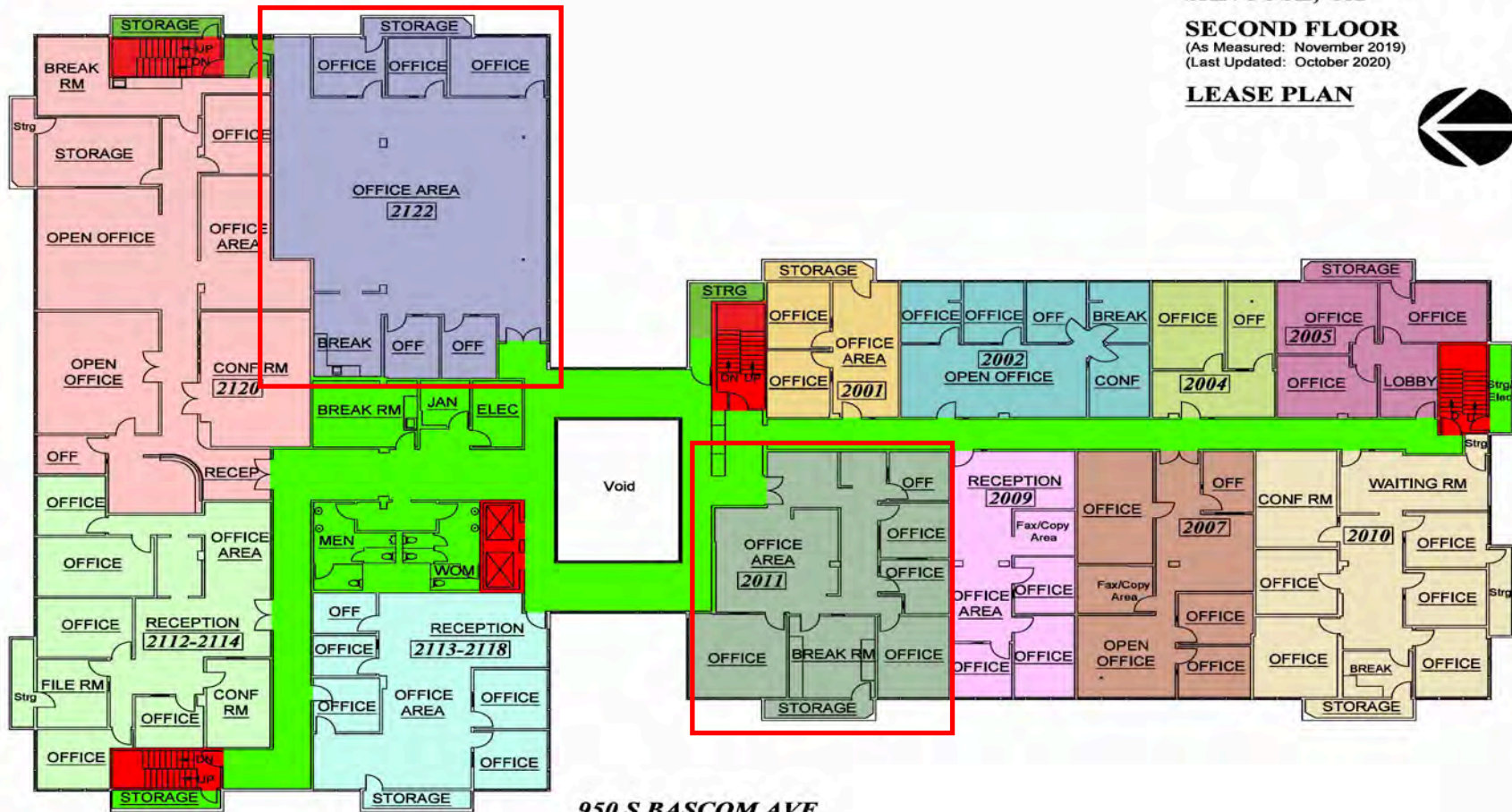

950 S BASCOM AVE

The information contained herein has been obtained from sources we deem reliable. We cannot, however, assume responsibility for its accuracy.

950 S. Bascom Avenue • San Jose, California

Third Floor Office Suites:

Suite 3009	2,017±SF
Suite 3010 (divisible to 603sf)	2,903± SF
Suite 3013	1,902± SF

BASCOM BUSINESS CENTER
950 S. BASCOM AVENUE
SAN JOSE, CA

THIRD FLOOR
(As Measured: November 2019)
(Last Updated: October 2020)

LEASE PLAN

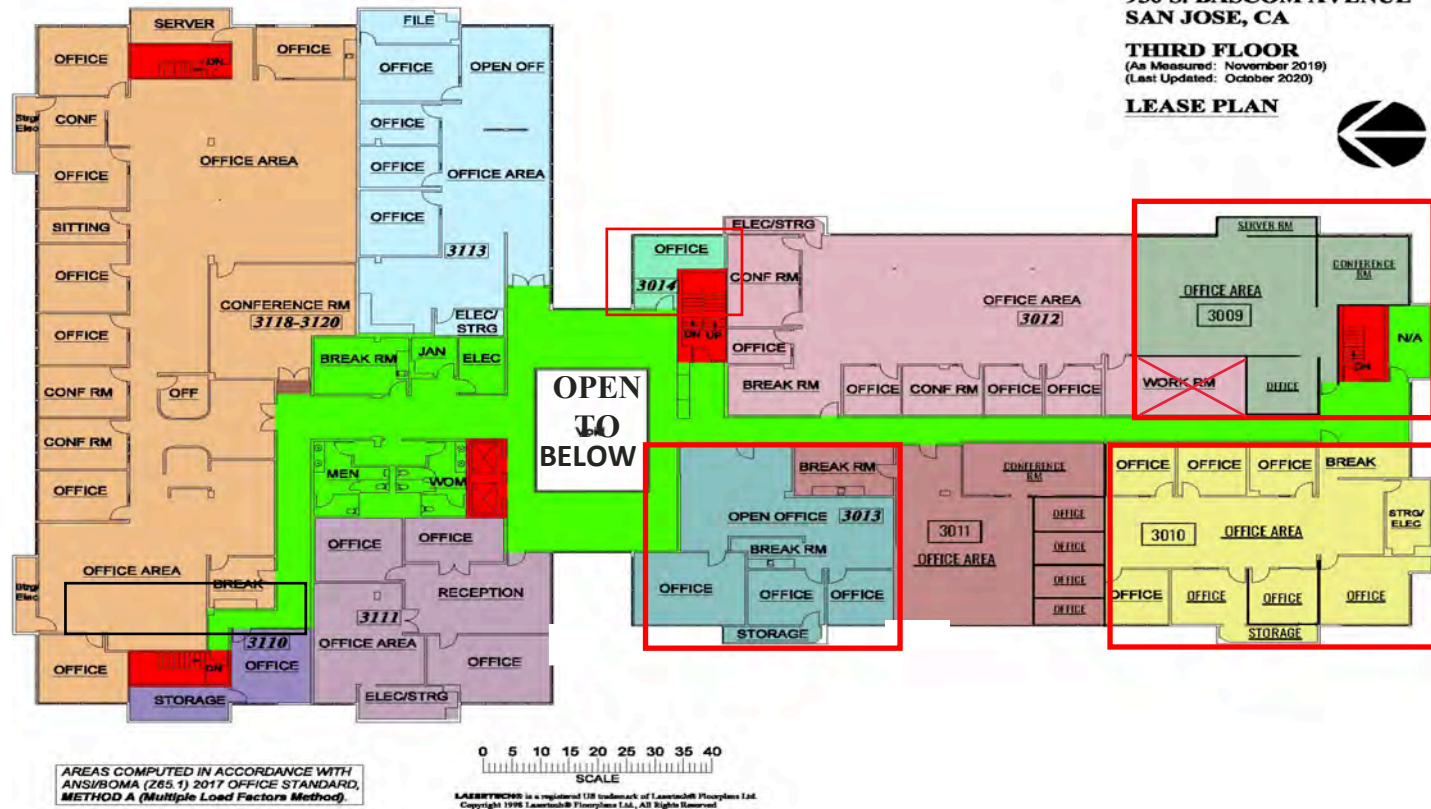

The information contained herein has been obtained from sources we deem reliable. We cannot, however, assume responsibility for its accuracy.

950 S. Bascom Avenue • San Jose, California



The information contained herein has been obtained from sources we deem reliable. We cannot, however, assume responsibility for its accuracy.

950 S. Bascom Avenue • San Jose, California



The information contained herein has been obtained from sources we deem reliable. We cannot, however, assume responsibility for its accuracy.

950 S. Bascom Avenue • San Jose, California



The information contained herein has been obtained from sources we deem reliable. We cannot, however, assume responsibility for its accuracy.

950 S. Bascom Avenue • San Jose, California

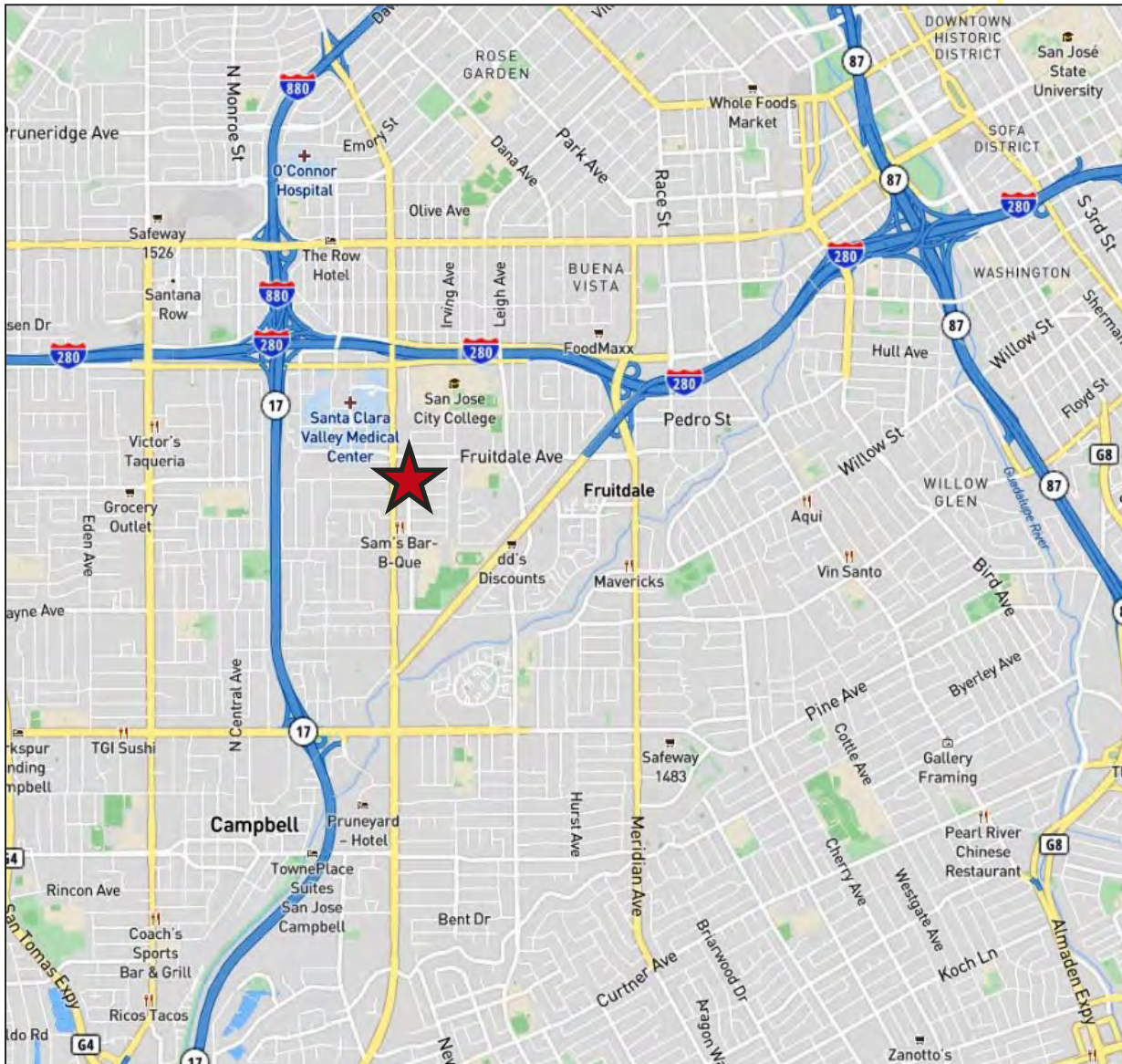

for more information contact:

Michael Joseph

Silverstone Commercial

Lic. #01382905

mjoseph@silverstonecommercial.com

(408) 375-5572

The information contained herein has been obtained from sources we deem reliable. We cannot, however, assume responsibility for its accuracy.

**Silverstone
Commercial**



www.SilverstoneCommercial.com

