

1553 ALPINE AVENUE NW
GRAND RAPIDS, MICHIGAN

OFFICE FOR SALE
2,088 Square Feet Available



**SIGNATURE
ASSOCIATES**
KNOW SIGNATURE | KNOW RESULTS

FULL CITY BLOCK



PROPERTY FEATURES

- 2,088 total square foot building
- Located on 0.59 acres
- Zoned TN-TBA
- Built in 1970; Retrofit 2001
- Sale Price: \$775,000 (\$371.17/sf)

Comments: Free standing brick building on a lighted intersection along busy Alpine Avenue. Ample private parking. Zoned TN-TBA, allowing a variety of uses for commercial, office and retail. Site has a small pad adjacent building that can be redeveloped. Site has over 250' of frontage along Alpine Avenue.



For more information, please contact:

JOE RIZQALLAH
(616) 822 6310
jrizzqallah@signatureassociates.com

SIGNATURE ASSOCIATES
1188 East Paris Ave SE, Suite 220
Grand Rapids, MI 49546
www.signatureassociates.com

1553 Alpine Avenue NW – Grand Rapids, Michigan

Office for Sale

2,088
Square Feet
AVAILABLE

Site Plan

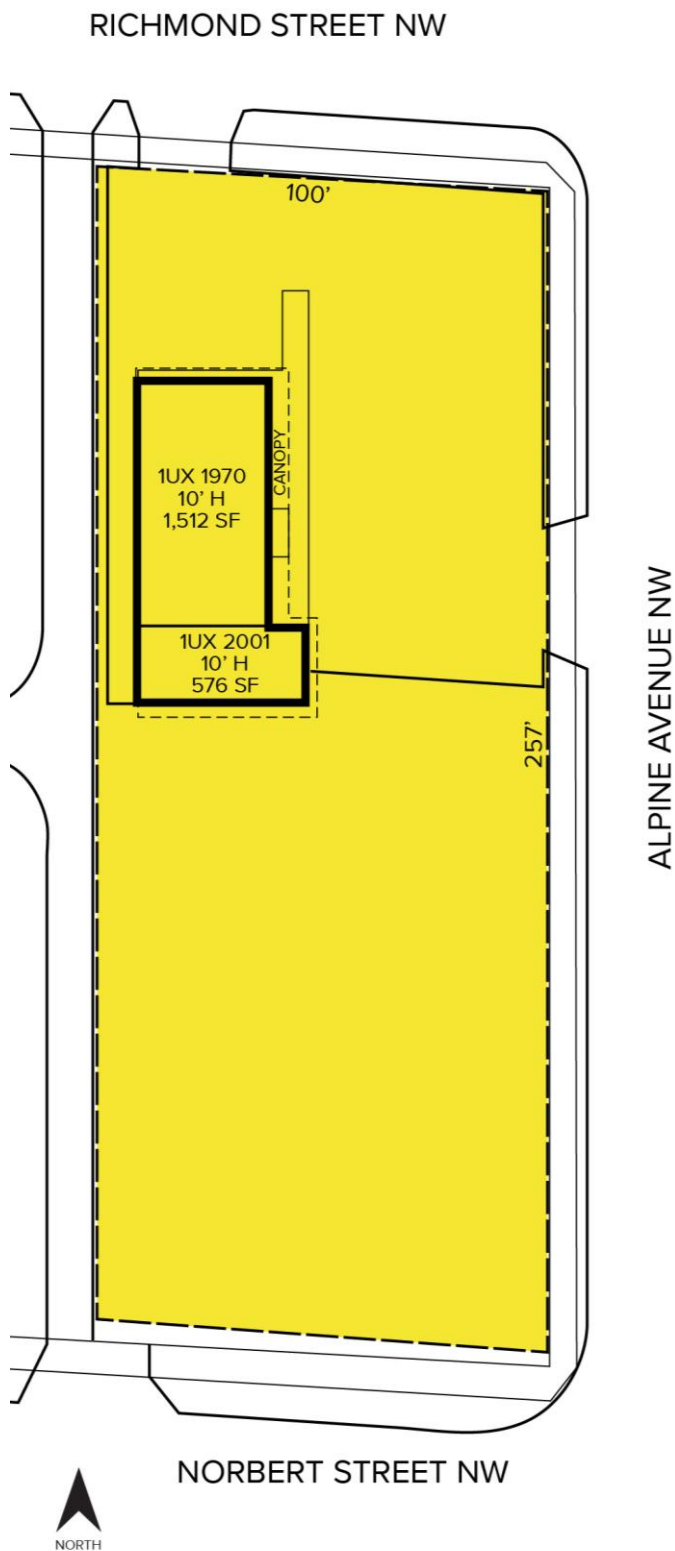

For more information, please contact:

JOE RIZQALLAH
(616) 822 6310
jrizzqallah@signatureassociates.com

SIGNATURE ASSOCIATES
1188 East Paris Ave SE, Suite 220
Grand Rapids, MI 49546
www.signatureassociates.com

1553 Alpine Avenue NW – Grand Rapids, Michigan

Office for Sale

2,088
Square Feet
AVAILABLE

Additional Photos



For more information, please contact:

JOE RIZQALLAH
(616) 822 6310
jrizqallah@signatureassociates.com

SIGNATURE ASSOCIATES
1188 East Paris Ave SE, Suite 220
Grand Rapids, MI 49546
www.signatureassociates.com

1553 Alpine Avenue NW – Grand Rapids, Michigan
Office for Sale

2,088
Square Feet
AVAILABLE

Aerial



For more information, please contact:

JOE RIZQALLAH
(616) 822 6310
jrizqallah@signatureassociates.com

SIGNATURE ASSOCIATES
1188 East Paris Ave SE, Suite 220
Grand Rapids, MI 49546
www.signatureassociates.com

Information is subject to verification and no liability for errors or omissions is assumed. Price is subject to change and listing withdrawal.