

FOR LEASE | OFFICE



500 N WASHINGTON AVE, TITUSVILLE, FL 32796

PROPERTY FEATURES:

- Building Size: 25,243 SF
- 996 SF - 4,435 SF Available
- Built-out, move-in ready, medical office suites in a strategically located building
- Within a mile from Parrish Medical Center and its 1,200 employees
- Within a mile from Eastern Florida State College campus which has a student/faculty population of 1,711 and its 1,200 employees
- Adjacent to the Space Coast Cancer Center
- Ample Parking: 5.28/1,000 SF

2024 DEMOGRAPHICS

	1 MILE	3 MILES	5 MILES
Population	5,892	33,287	57,789
Total Daytime Population	9,605	33,348	54,662
Median Age	48.3	44.8	45.4
Average HH Income	\$59,227	\$68,669	\$71,826

TRAFFIC COUNT

US 1/N. Washington Ave. 26,500 AADT

MAP



Contact us now for more information

RUSTY STOECKEL
BROKER/ASSOCIATE
(407) 422-8191
rusty@dresi.com

LUC PICOTTE
SALES ASSOCIATE
(425) 275-3346
lpicotte@demetreeglobal.com

Demetree Global
941 W. Morse Blvd, Suite 315 | Winter Park, FL 32789
DemetreeGlobal.com



Contact us now for more information

RUSTY STOECKEL
BROKER/ASSOCIATE
 (407) 422-8191
rusty@dresi.com

LUC PICOTTE
SALES ASSOCIATE
 (425) 275-3346
lpicotte@demetreeglobal.com

Demetree Global
 941 W. Morse Blvd, Suite 315 | Winter Park, FL 32789
DemetreeGlobal.com

No warranty or representation, express or implied, is made as to the accuracy of the information contained herein, and same is submitted subject errors, omissions, change of price, rental or other conditions, withdrawal without notice, and to any special listing and conditions imposed by our principals.



Contact us now for more information

RUSTY STOECKEL
BROKER/ASSOCIATE
(407) 422-8191
rusty@dresi.com

LUC PICOTTE
SALES ASSOCIATE
(425) 275-3346
lpicotte@demetreeglobal.com

Demetree Global
941 W. Morse Blvd, Suite 315 | Winter Park, FL 32789
DemetreeGlobal.com

No warranty or representation, express or implied, is made as to the accuracy of the information contained herein, and same is submitted subject errors, omissions, change of price, rental or other conditions, withdrawal without notice, and to any special listing and conditions imposed by our principals.



Contact us now for more information

RUSTY STOECKEL
BROKER/ASSOCIATE
(407) 422-8191
rusty@dresi.com

LUC PICOTTE
SALES ASSOCIATE
(425) 275-3346
lpicotte@demetreeglobal.com

Demetree Global
941 W. Morse Blvd, Suite 315 | Winter Park, FL 32789
DemetreeGlobal.com

No warranty or representation, express or implied, is made as to the accuracy of the information contained herein, and same is submitted subject errors, omissions, change of price, rental or other conditions, withdrawal without notice, and to any special listing and conditions imposed by our principals.

Entrance Area



Courtyard Area



Contact us now for more information

RUSTY STOECKEL
BROKER/ASSOCIATE
(407) 422-8191
rusty@dresi.com

LUC PICOTTE
SALES ASSOCIATE
(425) 275-3346
lpicotte@demetreeglobal.com

Demetree Global
941 W. Morse Blvd, Suite 315 | Winter Park, FL 32789
DemetreeGlobal.com

No warranty or representation, express or implied, is made as to the accuracy of the information contained herein, and same is submitted subject errors, omissions, change of price, rental or other conditions, withdrawal without notice, and to any special listing and conditions imposed by our principals.

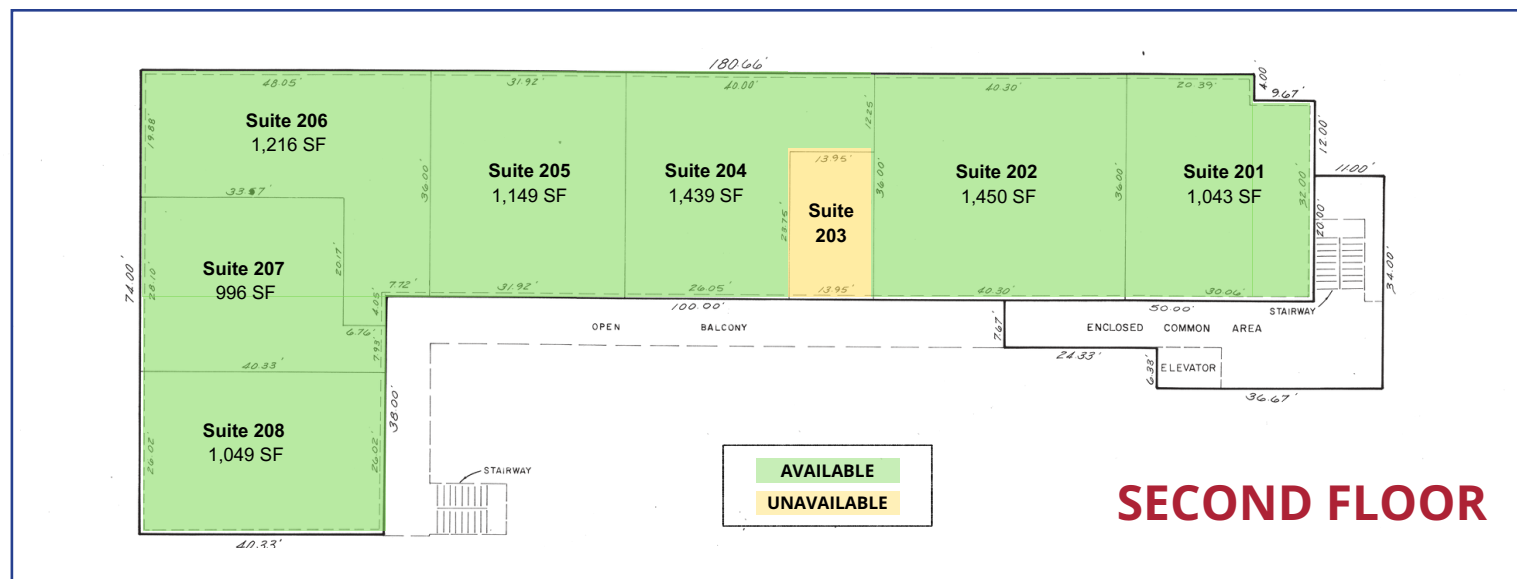
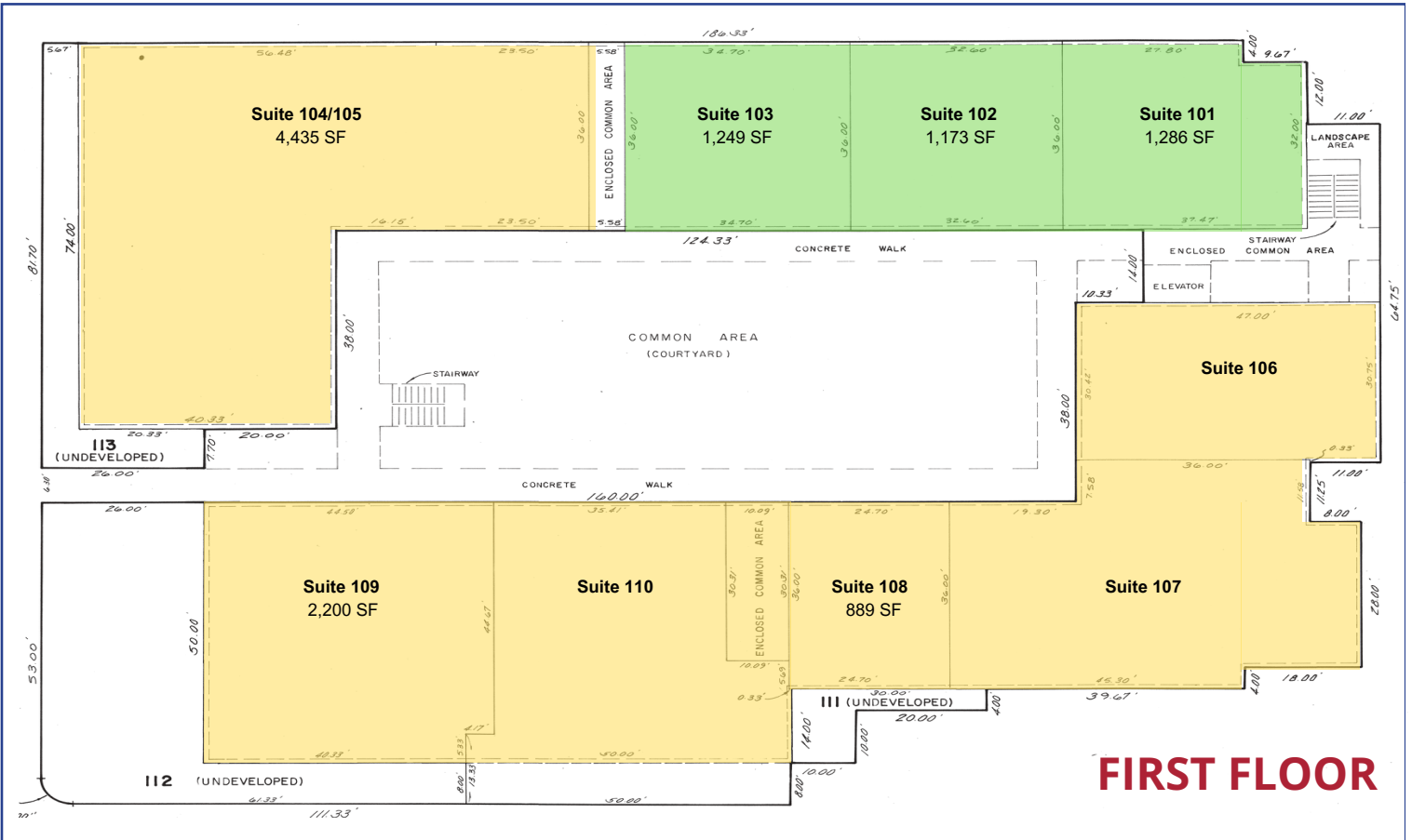

Contact us now for more information

RUSTY STOECKEL
BROKER/ASSOCIATE
(407) 422-8191
rusty@dresi.com

LUC PICOTTE
SALES ASSOCIATE
(425) 275-3346
lpicotte@demetreeglobal.com

Demetree Global
941 W. Morse Blvd, Suite 315 | Winter Park, FL 32789
DemetreeGlobal.com