



1751 Suddath Park St.

Tampa, FL 33619

136,080 SF Class A Warehouse



Contact Us

Josh Tarkow, SIOR
Senior Vice President
+1 813 361 2614
josh.tarkow@cbre.com

Rian Smith, SIOR
Senior Vice President
+1 813 380 7388
rian.smith@cbre.com

Property Highlights

- + Brand-new, first generation space
- + Class A
- + 136,080 SF (divisible to 45,000 SF)
- + 3,222 SF office
- + ~1 acre IOS
- + 11.61 acres
- + Tilt-up reinforced concrete
- + 32' clear height
- + 49' x 50' column spacing
- + 60' speed bay
- + 6" warehouse floor slab
- + Rear-load
- + 1 drive-in door
- + 25 dock-high doors
- + ESFR sprinkler system
- + 113 auto parking spaces
- + 1,000A, 480V, 3-phase power
- + Light industrial zoning

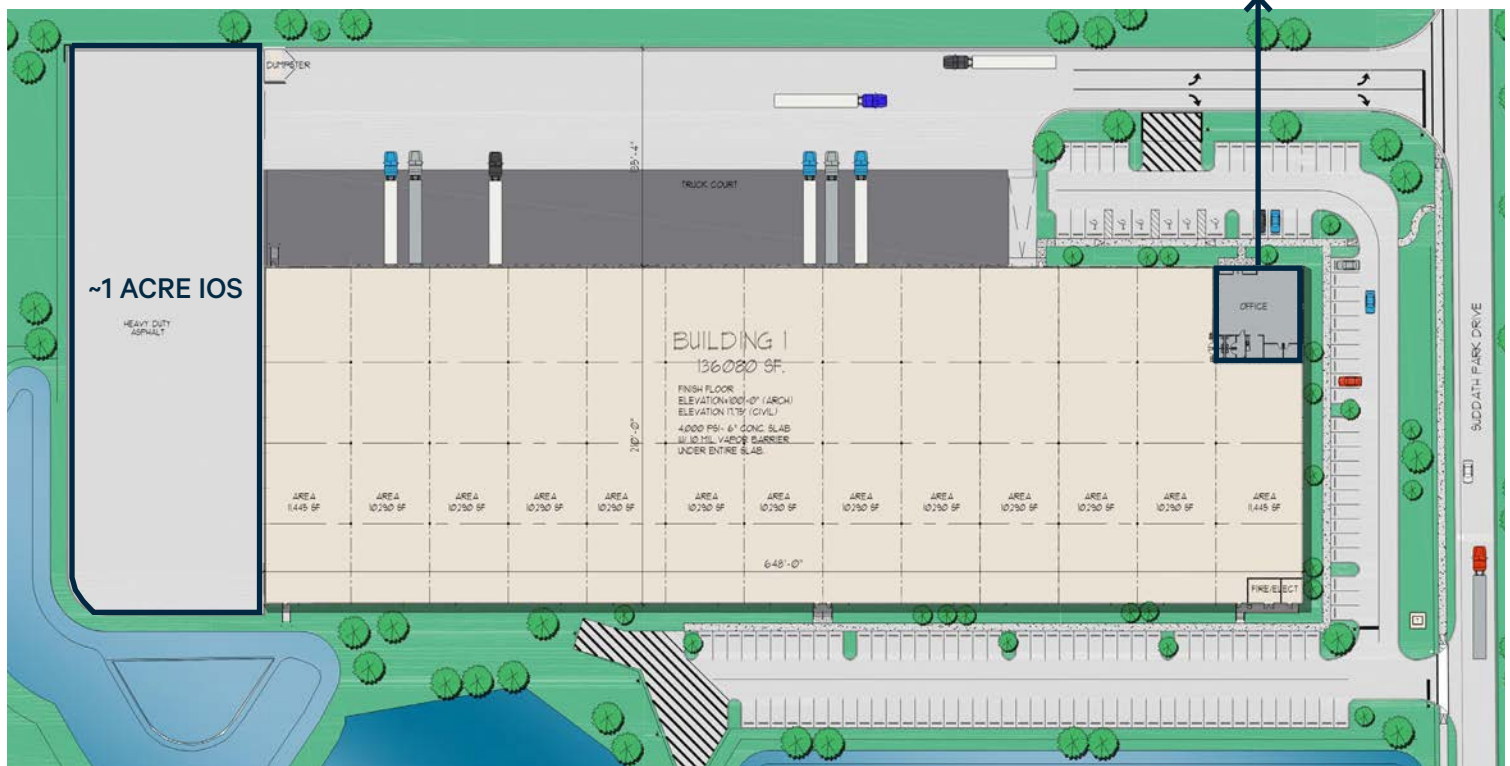
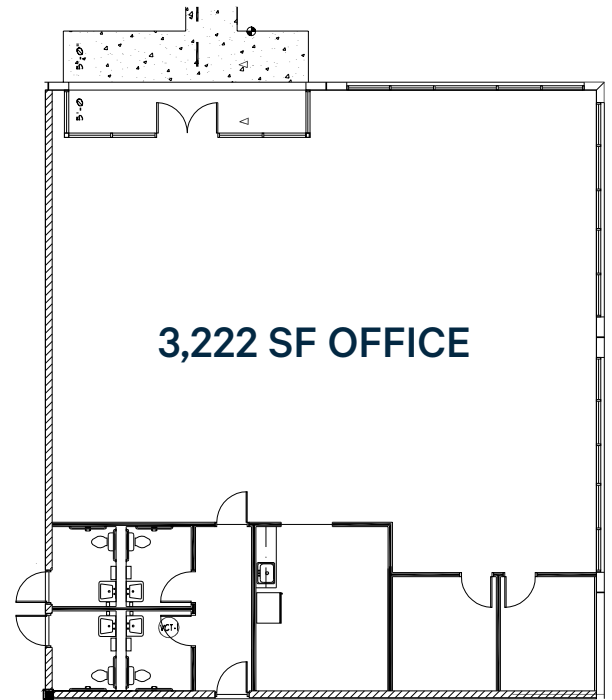



Drive Times

| | |
|-------------------------|------------|
| Selmon Expressway | 2.1 miles |
| I-4 | 3.5 miles |
| CSX Intermodal Terminal | 4.8 miles |
| Port Tampa Bay | 5.1 miles |
| I-75 | 5.3 miles |
| I-275 | 5.6 miles |
| Tampa | 5.8 miles |
| Tampa Int'l Airport | 14.8 miles |

Location Highlights

The East Side Submarket is a hub of industrial activity in Tampa, boasting some of the strongest demand in the region. Strategically situated on the west end of the I-4 Corridor, this facility offers unparalleled access to statewide distribution opportunities.

Its prime location is further enhanced by proximity to major highways, including I-4, I-75, and I-275, providing seamless connections to key metros and ports. The area is also home to a CSX Intermodal Terminal and Port Tampa Bay, the state's largest port by cargo tonnage, as well as Tampa International Airport, just a short 10-mile drive away.

Notable companies such as International Paper Company, Ace Hardware, and Coca-Cola have established a significant presence in the East Side, making it an attractive location for businesses seeking to tap into the region's thriving industrial ecosystem.

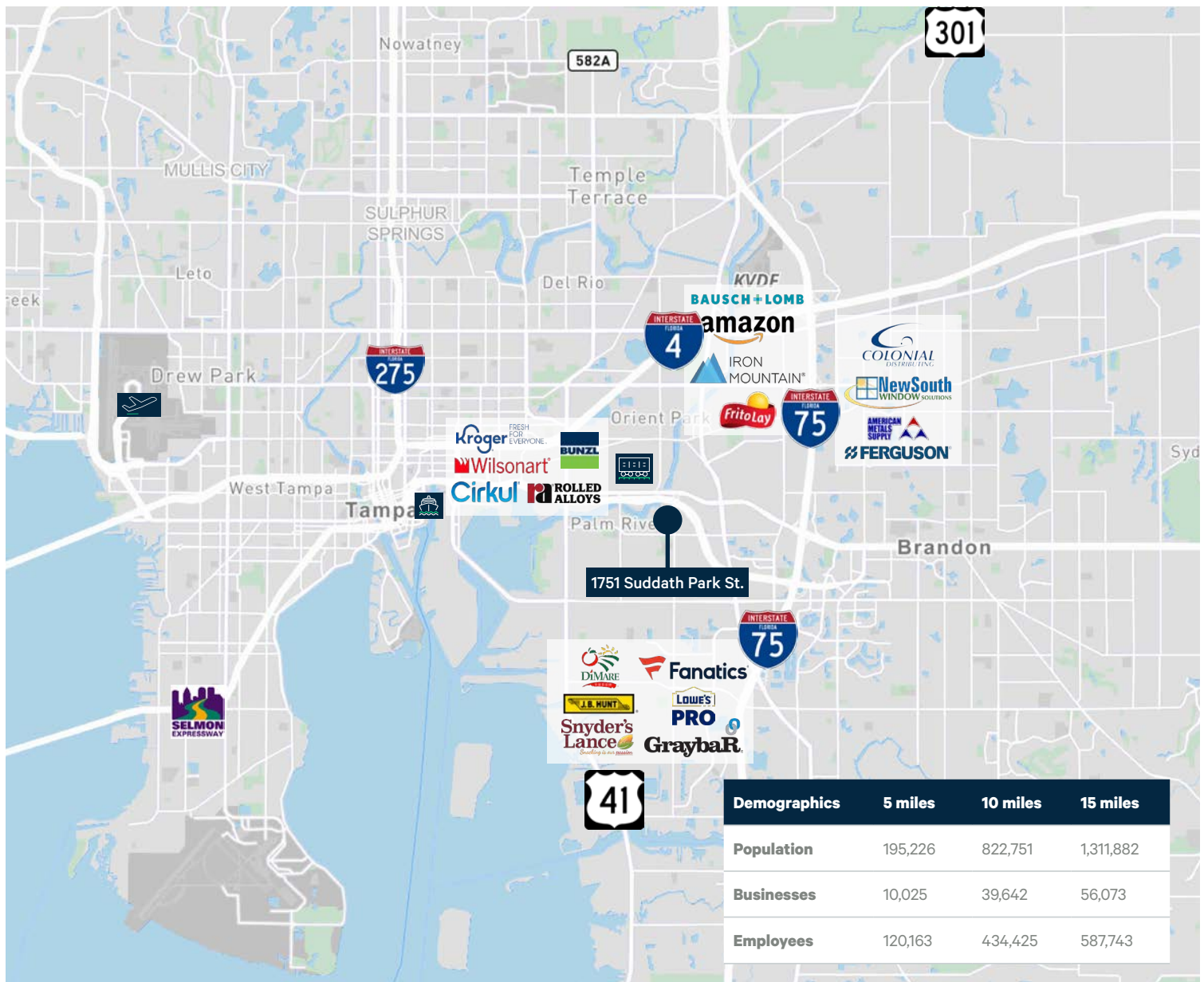



Contact Us

Josh Tarkow, SIOR
Senior Vice President
+1 813 361 2614
josh.tarkow@cbre.com

Rian Smith, SIOR
Senior Vice President
+1 813 380 7388
rian.smith@cbre.com

© 2025 CBRE, Inc. All rights reserved. This information has been obtained from sources believed reliable, but has not been verified for accuracy or completeness. You should conduct a careful, independent investigation of the property and verify all information. Any reliance on this information is solely at your own risk. CBRE and the CBRE logo are service marks of CBRE, Inc. All other marks displayed on this document are the property of their respective owners, and the use of such logos does not imply any affiliation with or endorsement of CBRE. Photos herein are the property of their respective owners. Use of these images without the express written consent of the owner is prohibited.